



User Guide

S1234 / SS1234 / SW1234

Line Array Speakers



S1234 Passive Speaker

SS1234 Amplified Speaker

**SW1234 Amplified Speaker with
16 Channel UHF Wireless Microphone**



Thank you for choosing the **S1234 / SS1234 / SW1234 Line Array Speaker** from *AmpliVox Portable Sound Systems*.

We are excited in introducing this truly unique system. Our system combines flexibility with functionality. Please refer to this user guide as you enjoy the unique capabilities of another quality product from *AmpliVox Portable Sound Systems*.

We encourage you to visit our website **www.ampli.com** to register your product for its warranty coverage, sign up to receive our newsletter, download our catalog, and learn more about the complete line of *AmpliVox* audio visual products, including portable PA systems, and lecterns.

TABLE OF CONTENTS

| | |
|-----------------------------------|---|
| SPECIFICATIONS | 3 |
| MICROPHONES..... | 3 |
| SPEAKER BRACKET..... | 3 |
| FEATURE LAYOUT..... | 4 |
| FEATURES..... | 5 |
| WIRELESS MICROPHONE SET-UP..... | 5 |
| WIRELESS HANDHELD MICROPHONE..... | 6 |
| TROUBLESHOOTING..... | 7 |
| WARRANTY..... | 8 |

IMPORTANT SAFETY INSTRUCTIONS

Before using this product, read the instruction manual for important safety information. Please retain this manual for future reference and warranty information.

Troubleshooting & Servicing

Do not attempt to service or repair the device yourself. Refer all servicing to qualified service personnel. Do not attempt to modify the device in anyway. Doing so could invalidate your warranty.

Cleaning

When cleaning the device, please use a soft, dry cloth. Never use benzene, paint-thinner, or other chemicals on the device.

Location

Place the device in stable location, so it will not fall causing damage to the device or bodily harm.

Intended use

The product may only be used with the original parts intended for it. The intended use includes adherence to the specified installation instructions. The manufacturer accepts no liability for damage arising due to improper use.

WARNING: Changes or modifications to this unit not expressly approved by the party responsible for compliance could void the user's authority to operate the equipment.

IMPORTANT

This device complies with Part 15 of the FCC Rules. Operation is subject to the following two conditions:

(1) This device may not cause harmful interference, and (2) this device must accept any interference received, including interference that may cause undesired operation.

The unit's circuitry may cause interference to nearby radios. To prevent interference, either switch the unit off or move away from the affected radio.

NOTE: This equipment complies within the limits for a class B digital device, pursuant to Part 15 of the FCC Rules. These limits are designed to provide reasonable protection against harmful interference in a residential installation. This equipment generates, uses and can radiate radio frequency energy and, if not installed and used in accordance with the instructions, may cause harmful interference to radio communications. However, there is no guarantee that interference will not occur in a particular installation. If this equipment does cause harmful interference to radio or television reception, which can be determined by turning the equipment off and on, the user is encouraged to try to correct the interference by one or more of the following measures:

- Increase the separation between the equipment and receiver.
- Connect the equipment into an outlet on a circuit different from that to which the receiver is connected.
- Consult the dealer or an experienced radio / TV technician for help.

NOTE: Shielded cables may be required to be used with this unit to ensure compliance with the Class B FCC limits.

SPECIFICATIONS

| | |
|-------------------------------|---|
| Enclosure: | Sealed Type / Rotational Molded |
| Rated Power Output | 50 W Dynamic |
| AC Power | 110-220 Auto sensing, 50/60 Hz, |
| Wireless Range | Up to 300 Feet |
| UHF Wireless Frequency | 584 - 608 MHz |
| Frequency Response: | 100Hz to 12Khz |
| Sensitivity | 96dB |
| Line output: | Buffered, 600 ohm, 1/4in.jack (pre fader) |
| Phantom Power Input | Powers Electret condenser microphones |

| | |
|--------------------------------------|--|
| Sensitivity for rated output: | |
| Balanced Microphone | -58 dBV (1.25 mVrms) |
| Balanced Line | -15 dBV (175 mVrms) |
| Unbalanced Line | -20 dBV (100 mVrms) |
| Unbalanced input: | Hi-Z, Neutrik combo - 1/4in. |
| Balanced Input: | Lo-Z, Neutrik combo XLR |
| Weight: | 4.5 lbs. |
| Dimensions (HWD): | 17 in. H x 3.4 in. W x 5.0 in. D |
| Warranty | 6 years Electronics; 1 year on Remote, Microphones, Cassette Player, CD Player, Digital Player and Rechargeable Batteries. |

MICROPHONES

- Take care in selecting volume level, and speaker placement so that acoustic feedback (howling and screeching) will be avoided.
- Please note the pickup patterns of the handheld microphone selected: Omnidirectional microphones pick up sound equally from all directions and are prone to feedback if not used carefully. Unidirectional microphones are more resistant to feedback, but pick up sound sources best that are directly in front of the microphone.
- Also, microphones that are farther from the sound source, such as **lavaliers**, require more acoustic gain and thus are also more prone to feedback than close-source microphones such as **handheld** or **headset** microphones that are used close to the mouth.

SPEAKER BRACKET

Mounting Speaker Bracket

- Slots have been provided on mounting bracket that will accommodate 10-24 machine screws or wood screws (not provided).
- Make sure that mounting surface will hold weight of speaker.



Mounting Speaker to Bracket

- Locate the two speaker mounting knobs and washers.
- Insert one washer over stud of knob and screw part way into the insert on the side of speaker. Repeat for other side.
- Take speaker and align these two knobs with the slots in the bracket.
- Position washer so that it is in-between the bracket and bottom of knob.
- Slide into slot, position, and tighten both knobs.



S1234 BACK PANEL



The **S1234** is a passive speaker. It has no built-in amplifier. It is designed to be used with the SS1234 / SW1234. Speaker has a Left and Right input but only one input needs to be used. Use either a dual RCA cable or single RCA cable.

SS1234 / SW1234 BACK

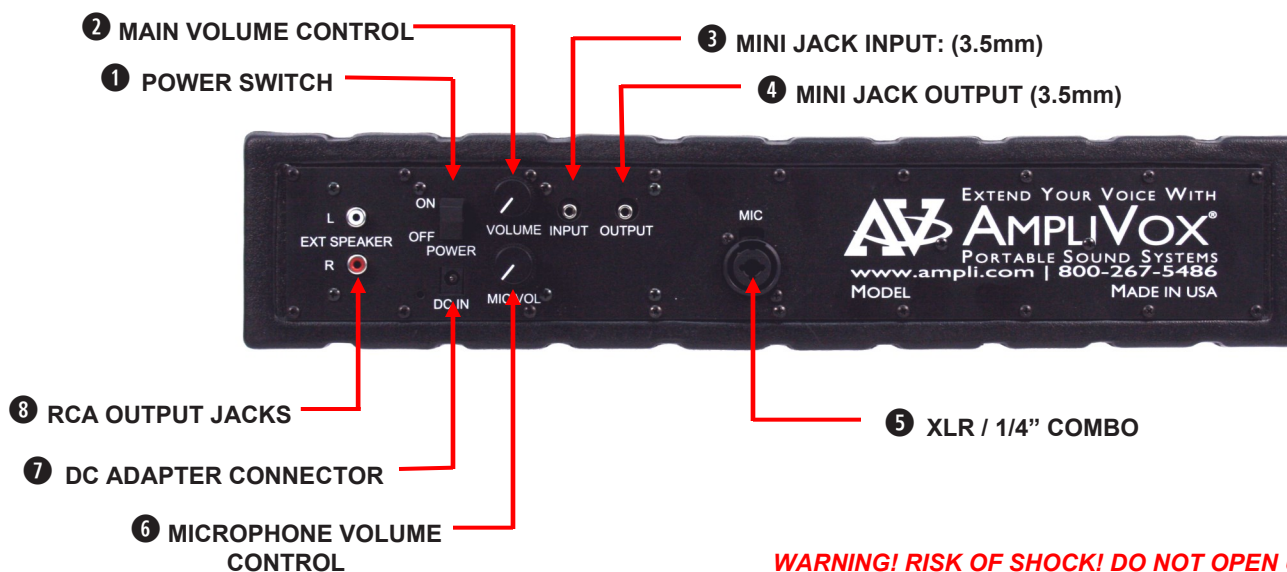

**WARNING! RISK OF SHOCK! DO NOT OPEN UNIT.
NO USER SERVICEABLE PARTS INSIDE!**

SW1234 WIRELESS UHF RECEIVER



BACK PANEL

- ❶ **Power Switch.**
- ❷ **Main Volume Control** - This knob controls output loudness.
- ❸ **Mini Jack Input** - Projector Audio. To play music, just plug in your CD player, MP3 player or an Amplivox Bluetooth Receiver.
- ❹ **Mini Jack Output** - This jack outputs all the sound from the microphone input and anything plugged into the INPUT jack.
- ❺ **XLR / 1/4" Combo Jack** - To connect balanced or unbalanced microphones that have either XLR or phone plug connectors.
- ❻ **Microphone Volume Control** - This knob controls output loudness from microphone.
- ❼ **DC Adapter Connector** - Plug-in the 110/220 V adapter here.
- ❽ **RCA Output Jacks** - These jacks, output all the sound from the microphone input and anything

16 CHANNEL UHF RECEIVER

- ❾ **RF - Radio Frequency Indicator** - When receiver and wireless transmitter are set to the same channels, this LED will light giving you confirmation that the two are in sync with each other.
- ❿ **ASC / IR Auto Channel Select** - This is an Auto Channel Sync function that is only used with the Handheld Microphone S1695.
- ⓫ **Volume Control** - Balance wireless microphone output loudness with Main Volume Control.
- ⓬ **Mute Level Adjustment** - Adjustment control for wireless microphone signal. In normal operation, the **MUTE LEVEL** should be set fully counterclockwise to the factory preset minimum RF level. However, in areas of high RF activity, the mute (or squelch, as it is sometimes called) may need to be adjusted to compensate for the adverse conditions in a particular location.
- ⓭ **AF - Audio Frequency Indicator** lights when audio signal is received from microphone.
- ⓮ **Select Buttons** - Manual Channel Selection.
- ⓯ **Channel Display**

16 CHANNEL UHF WIRELESS MICROPHONE SETUP

RECEIVER / TRANSMITTER SETUP

- The receiver has its own POWER / VOLUME Control. ❾ Turn Power On. A Frequency Channel will appear in the Channel Display. ❿ Press Select Buttons ⓮ to select a channel. Channel number must match channel number on wireless transmitter.
- The transmitter bodypack is operated by 1 - "AA" 1.5 Volt alkaline battery. Slide off battery cover and install battery as shown. Make certain the battery is fully seated in its compartment so the cover slides in place easily. Battery life with alkaline batteries is approximately 8 hours of operating time.
- Select a channel (1-16) on side panel ❶ using the supplied screw driver to select channel number. Channel selected should match channel on receiver. When transmitter and receiver are set to correct channel the RF indicator ❾ will glow red when transmitter is turned on.
- Plug the Lapel microphone into the Microphone Input Jack ❷. The microphone can be clipped to a necktie or other clothing, using the supplied clip. The lapel microphone should be placed under the chin, as close to the center of the body as possible.
- Slide the power ON/OFF switch ❸ to the ON position (the LED indicator light will illuminate green). Replace batteries when this LED turns red.

Wireless Microphone Transmitter - Bodypack



OPTIONAL WIRELESS HANDHELD MICROPHONE—MODEL S1695

If you are using the Amplivox S1695 Wireless Handheld Microphone Transmitter, screw off the lower bottom section of microphone and insert 2 - "AA" 1.5 Volt alkaline batteries.

BATTERIES

1. Hold the body of microphone in hand and twist off bottom section of microphone.
2. Insert two "AA" batteries.
3. Twist bottom section back on to microphone.

BATTERY STATUS

The life expectancy of the two batteries is about 10 hours. When the "BATTERY" symbol on the display screen keeps **flashing**, the batteries should be **replaced immediately**.

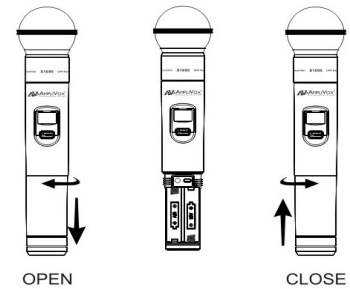

AUTO CHANNEL SYNC

Because the microphone has an **Auto Sync** function, you first select channel you wish to use on the receiver. Turn on microphone, then press the **ASC** button, ⑩ on the receiver and the IR light will start to flash. Point end of microphone at the flashing IR light on the receiver and the microphone will auto sync to the same channel as selected.



Microphone
End

FUNCTIONS

- ① Interchangeable Microphone Head
- ② LCD Screen
- ③ Power / Mute Control Switch
- ④ Select Button
- ⑤ Microphone Input Sensitivity Adjustment—is used to set the gain of microphone. If you are a soft talking speaker you will need to turn the control counter clockwise. Turn clockwise if you are a loud talker. Use plastic screwdriver that is supplied.

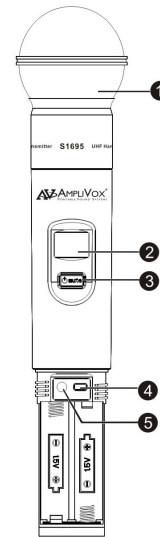

MICROPHONE OPERATION AND STATUS DISPLAY

TURN ON MICROPHONE: Push and hold the "POWER/MUTE" ③ button until LCD screen lights up.

TO MUTE: Press "POWER/MUTE" ③ button twice to MUTE. Channel number will flash when muted. Press button again twice to remove "MUTE".

TURN OFF MICROPHONE: Push and hold the "POWER/MUTE" ③ button for 2 seconds to turn microphone "OFF".

SELECT CHANNEL: Press and hold the "SELECT" ④ button for 2 seconds until you only see the word Channel and the channel number. To change channel, when flashing, press the "SELECT" ④ button until you reach the desired channel. Flashing will stop after 10 seconds and channel is now set.

LOCK / UNLOCK CHANNEL: Push the "POWER/MUTE" ③ button and "SELECT" button at the same time to lock or unlock channel. When locked, channel cannot be changed. "LOCKED" symbol appears in upper left-hand corner.

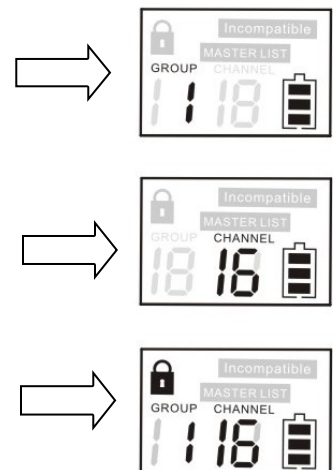

PROBLEM & ITEMS TO CHECK

UNIT WILL NOT TURN ON

- Is unit plugged in?

SOUND IS DISTORTED

- Turn down main volume
- Turn down input source (such as keyboards, etc.) since the output of some devices may be too high
- Check for debris on speaker cone

SOUND IS MUFFLED

- Bass too high
- Treble too low

FEEDBACK: ALOUD SQUEALING, SHRILL OR HOWLING SOUND THAT IS SELF GENERATED

- Feedback occurs when a microphone is too close to the speaker or the microphone volume is too high, or the microphone is pointed towards the speaker. It is also caused by sound reflecting off hard surfaces.
- Reduce or eliminate Feedback by
 - Pointing the microphone in a different direction
 - Keeping the microphone BEHIND the speakers
 - Turn down the volume levels

POWER IS ON, BUT NO SOUND

- Check volume levels
- If using wireless, be sure receiver(s) and/or transmitter battery is installed and/or is on

MICROPHONE SIGNAL IS WEAK

- If microphone has batteries, check batteries
- Check cables/connectors

WIRELESS MIC DOES NOT WORK

- Check transmitter battery is alkaline and ensure transmitter is on.
- Does yellow "signal" LED light when transmitter is turned on?
- Are the transmitter and receiver on the same channel? (1-16)

WIRELESS MIC CUTS IN AND OUT

- Is unit visible (line of sight) from user? If not, move unit into view when using wireless microphone.
- Does the yellow "signal" LED go out when signal drops out? Check battery in transmitter.

NEED HELP? Call 800-267-5486

DISCLAIMER

AmpliVox Portable Sound Systems, operates a policy of continuous development. AmpliVox reserves the right to make changes and improvements to any of the products described in this document without prior notice.

Under no circumstances shall AmpliVox be responsible for any loss of data or income or any special, incidental, consequential or indirect damages howsoever caused.

In some countries there may be some restrictions in using this equipment. Please check with your local radio frequency authorities.

WARRANTY

Limited Six (6) -Year Warranty

AmpliVox warrants this product to be free from defects in materials and workmanship (subject to the terms set forth below) for a period of six (6) years from the date of purchase ("Warranty Period"). All accessories and the battery are warrantee for 1 year. Accessories are; wireless and wired microphones, receivers and transmitters, CD players, cassette players, and digital players.

During the Warranty Period, AmpliVox will repair or replace (at AmpliVox's discretion) this product or any defective parts ("Warranty Service").

Repair or replacement under the terms of this warranty does not give right to any extension or a new beginning of the period of warranty.

CLAIMS UNDER THE WARRANTY

To obtain Warranty Service, **contact AmpliVox (800-267-5486)** to be assigned a **Return Authorization number (RA#)**. After receiving a RA#, the defective unit is to be returned to AmpliVox in either its original packaging or packaging affording an equal degree of protection. You will bear the cost of shipping the product to AmpliVox. If the product is covered by the warranty, AmpliVox will bear the cost of shipping product back to you after the completion of service under this warranty.

Return shipping will be charged to you for products not covered by the warranty or requiring no warranty repair.

The following information must be presented to obtain Warranty Service: **(a)** the RA# must be clearly and legibility marked on the outside of shipping carton, **(b)** proof of purchase, which clearly indicates the name and address of the seller, the date of purchase and the product type, which is evidence that this product is within the Warranty Period. Please further include **(c)** your return address, **(d)** daytime telephone number, and **(e)** reason for return.

LIMITATION OF WARRANTY

This warranty is only valid for the original purchaser and will automatically terminate prior to expiration if this product is sold or otherwise transferred to another party. The warranty provided by AmpliVox in this statement applies only to products purchased for use, and not for resale. It does not apply to open box purchases, which are sold "as is" and without any warranty. Specifically exempt from warranty are limited-life consumable components subject to normal wear and tear, such as microphone windscreens, ear cushions, modular plugs, ear tips, decorative finishes, batteries, and other accessories. This warranty is invalid if the factory-applied serial number, date code label, or product label has been altered or removed from this product. This Warranty does not cover cosmetic damage or damage due to misuse, abuse, negligence, Acts of Nature, accident, disassembling or modification of, or to any part of, the product. This Warranty does not cover damage due to improper operation, maintenance or installation, or attempted repair by anyone other than AmpliVox. Any unauthorized repairs will void this warranty.

REPAIRS OR REPLACEMENTS AS PROVIDED UNDER THIS WARRANTY ARE THE EXCLUSIVE REMEDY OF THE CONSUMER. AMPLIVOX SHALL NOT BE LIABLE FOR ANY INCIDENTAL OR CONSEQUENTIAL DAMAGES FOR BREACH OF ANY EXPRESS OR IMPLIED WARRANTY ON THIS PRODUCT. EXCEPT TO THE EXTENT PROHIBITED BY LAW, THIS WARRANTY IS EXCLUSIVE AND IN LIEU OF ALL OTHER EXPRESS AND IMPLIED WARRANTIES WHATSOEVER, INCLUDING BUT NOT LIMITED TO THE WARRANTY OF MERCHANTABILITY AND FITNESS FOR A PRACTICAL PURPOSE.

NOTE! This warranty gives you specific legal rights. You may have other rights which vary from location to location. Some jurisdictions do not allow the exclusion or limitation of incidental or consequential damages or implied warranties, so the above exclusions may not apply to you. This warranty does not affect your legal (statutory) rights under your applicable national or local laws.



Dispose of the product according to local standards and regulations

May, 2013