

Marshall Electronics

V-C310-HDSDI User Manual

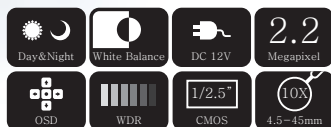

Features

- . Optical 10X zoom installed (4.5-45mm)
- . A variety of resolutions supported (1920X1080 30P/60i, 1280X720 60p)
- . HD-SDI SMPTE 292M Standard
- . Uncompressed transmission for zero signal delay
- . Video transmission up to 100M (5C-HFBT coaxial cable)
- . Data control by RS-232
- . Easy coaxial cable installation

Caution

- . Adapter : DC 12V 1A
- . Do not disassemble
- . Camera lens needs to be protected from impact
- . If problems are found, please contact us for installation help

Remote Control



- . Distance : 10M
- . When RC is on : LED will blink

- Cancel setup value and Exit Setup mode
- Enter and function key

Move to Up, Down, Left, Right

- Brightness
- Zoom In/Out
- Resolution

Specifications

Model	V-C210-HDSDI
Image Sensor	1/2.5" Primary color CMOS
Effective pixels	Aspect 16:9 Approximately 2.07M pixels
Lens	1/3.6" , f=4.5-45.0mm, F1.8-2.2
Zoom	Optical 10X
Minimum Lux.	6Lux(F1.8/50IRE/TV=1/30sec, 1920x1080 movie)
Video Signal	1920x1080 30p/1280x720 60p/1280x720 30p
Minimum Object Distance	Wide limit : 1cm / Tele limit : 100cm
Focus	Auto / Manual
Auto Slow Shutter	0.35Lux (Slow Shutter ON)
Other Functions	BLC/ AWB/ Noise Reduction/ Flicker Reduction/ Image Stabilizer/ Mirror (Vertical-Horizontal)

Model	V-C210-HDSDI
Video Output (Video Signal of V-C210-HDSDI / Output Resolution)	1920x1080 30p / 1920x1080 30p 1920x1080 30p / 1920x1080 60i 1280x720 30p / 1280x720 60p 1280x720 60p / 1280x720 60p
Output Format / Interface	SDI Composite
Audio	HD-SDI, SMPTE-292M / 75ohm BNC 1V p-p, NTSC, PAL / 75ohm BNC
Power Source	Will be available
Power Consumption	DC 12V (Voltage Tolerance : 8V-15V) Max. 500mA / 12V DC
Operating Temperature	32°F ~ 113°F (0°C ~ 45°C)
Operating Humidity	20 ~ 80%
Control	Remote Control / RS-232
OSD	Support (16 Color) / OSD Menu / OSD Caption
Weight	440±10g
Dimensions	67.5(W) x 166.9(L) x 65.7(H)

Included Accessories



1/4-20 Mounting
Plate with Screws



M 2.5x4ea



Manual



Remote
Control



Multi-port Cable



DC 12V Adapter

Diagram of Installation

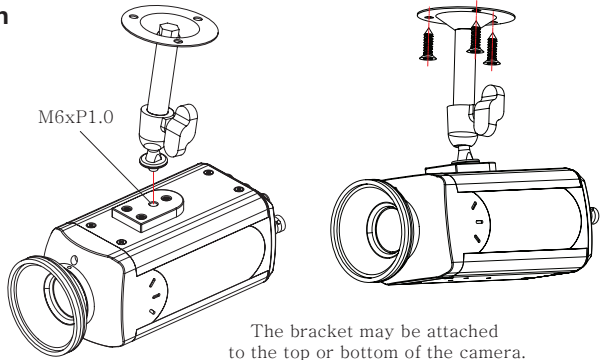
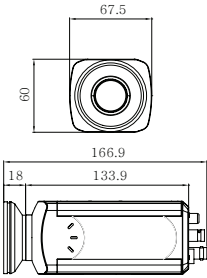

Output

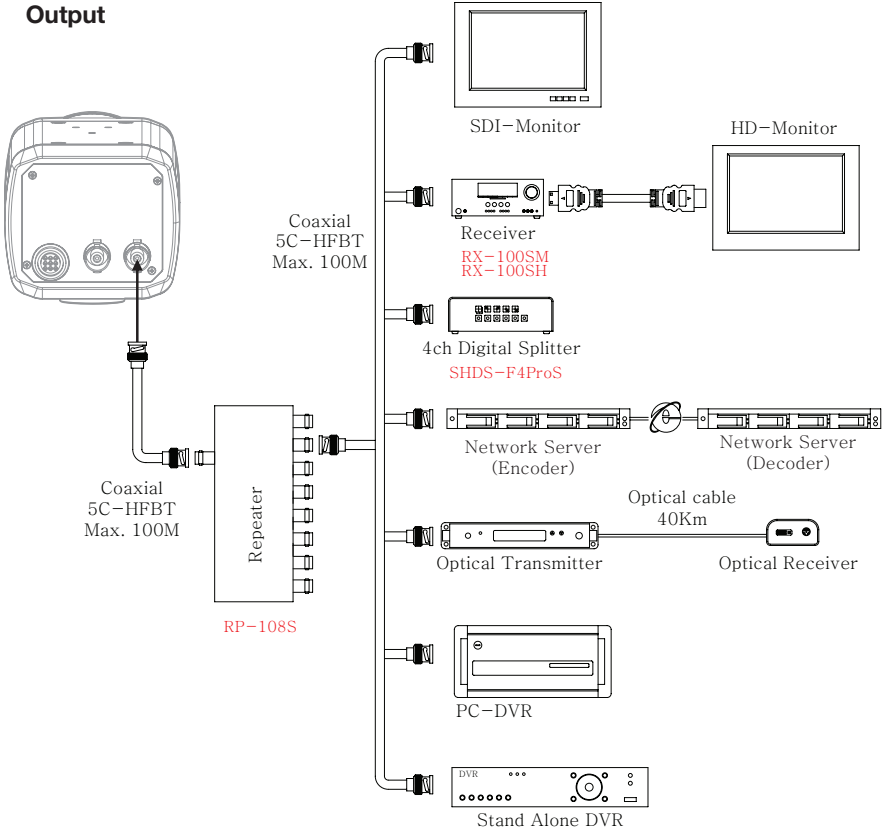

Description

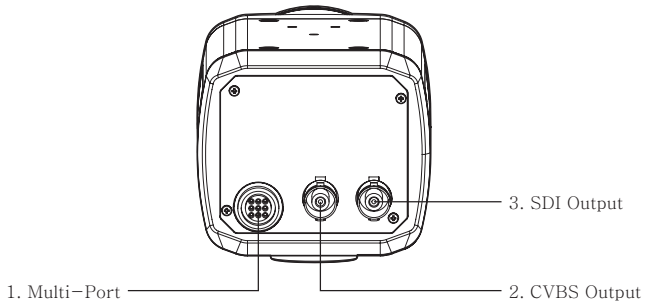

1. Multi-Port :

2. CVBS : Composite Video

3. SDI Output : HD-SDI (SMPTE 292M)

Multi-Port

