

WARRANTY REGISTRATION

Visit www.ultimatesupport.com for a quick and convenient process for registering your new Ultimate Support product. Warranty Registration and Proof of Purchase are required for warranty fulfillment. Full Limited Lifetime Warranty and Ultimate Protection Plus Premium Service and Support Plan details are available online under Music Gear & Instrument Stands / Customer Support.

ULTIMATE SUPPORT® LIMITED LIFETIME WARRANTY

Ultimate Support products are constructed of the finest materials and designed and tested to stand up to the demanding lifestyle of the touring musician, gigging DJ, and working sound engineer. In the unlikely event that a product should fail due to manufacturing defect, Ultimate Support is pleased to repair or replace that product.

Please see www.ultimatesupport.com for more information.

This warranty applies to the original purchaser only and does not include damage to the product resulting from normal wear and tear, accident, misuse, improper installation or operation, or unauthorized repair or alterations.

800.525.5628 . www.ultimatesupport.com . Copyright 2012, Ultimate Support Systems . All Rights Reserved

ULTIMATE SUPPORT®

THE STRENGTH OF INNOVATION® 

Product Manual
for Ultimate Support

HYPERPAD

HYP-100B

ITEM #17480



Revision 1, 08.26.12 . Product Manual Item #HYP-100B-M

ULTIMATE SUPPORT® LIMITED LIFETIME WARRANTY

Attaching iPad into HyperPad

(Two Steps)

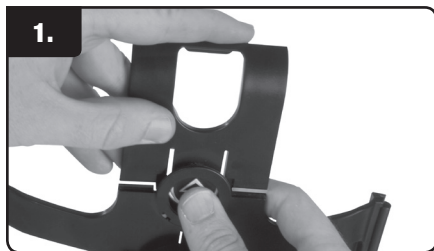

1. Push in triangle while pulling up on HyperPad mount clip to release.



2. Slide iPad into HyperPad mount until the clip "clicks" into place. **Follow step one to remove.**

Landscape and Portrait View

(Two Steps)



1. Adjust standing angle by pulling the support leg out to desired position.

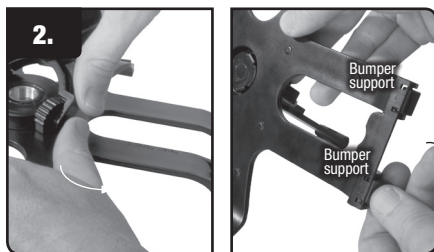

2. Rotate support leg into landscape or portrait view. For portrait view, flip out small bumper supports.

Using HyperPad with Table Clamp

(Four Steps)

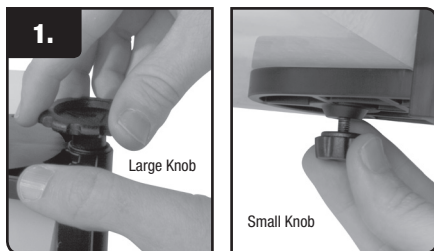

1. Turn large top knob to secure clamp to table. Turn small knob (bottom) for precise security.



3. Attach HyperPad to gooseneck by turning clockwise until tight.



2. Attach gooseneck onto top of clamp by turning it clockwise until tight.



4. Attach iPad onto HyperPad by following steps 1-2 in the "Attaching iPad into HyperPad" section.

Using HyperPad with Pole Clamp

(Four Steps)



1. Attach clamp to lower tube of mic stand. Turn large knob to tighten and secure.

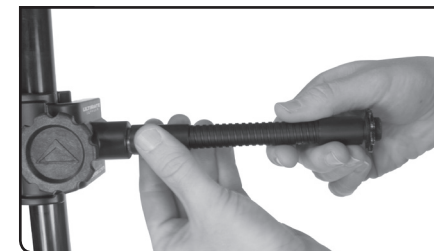

2. Attach gooseneck onto clamp by turning it clockwise until tight.



3. Attach HyperPad to gooseneck by turning clockwise until tight.

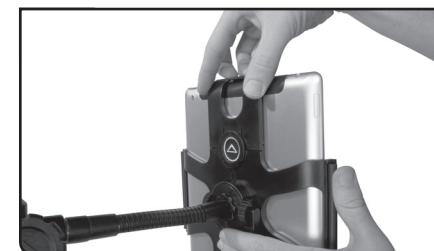

4. Attach iPad onto HyperPad by following steps 1-2 in the "Attaching iPad into HyperPad" section.

Using HyperPad with Top of Mic Stand

(Three Steps)

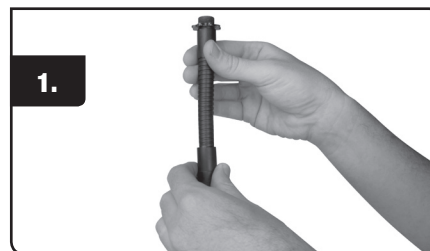

1. Attach gooseneck onto top of mic stand by turning it clockwise until tight.



2. Attach HyperPad to gooseneck by turning clockwise until tight.



3. Attach iPad onto HyperPad by following steps 1-2 in the "Attaching iPad into HyperPad" section.