

**DA-LITE IS MORE
THAN PROJECTION SCREENS**

Da-Lite Tripod, Wall and
Ceiling and Electric Screens

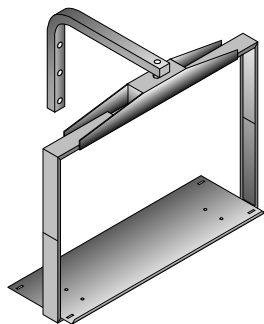

Da-Lite
Monitor Mounts

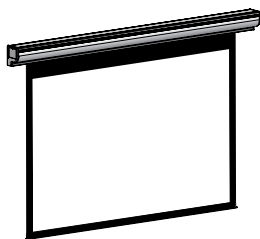
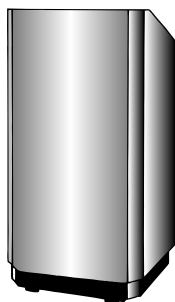

Da-Lite Lecterns



Da-Lite
Project-O-Stands
and Easels

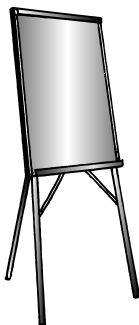

79163 Rev. 12/03

The
POWER *In*
PRESENTATION PRODUCTS

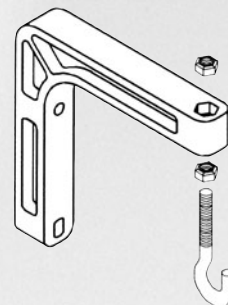

**Mounting Instructions
for
WALL BRACKETS**

DA-LITE SCREEN COMPANY, INC.

3100 North Detroit Street
Post Office Box 137
Warsaw, Indiana 46581-0137
Phone: 574/267-8101
800-622-3737
Fax: 574/267-7804
[http:// www.da-lite.com](http://www.da-lite.com)
e-mail: info@da-lite.com

No. 6 EXTENSION WALL BRACKETS

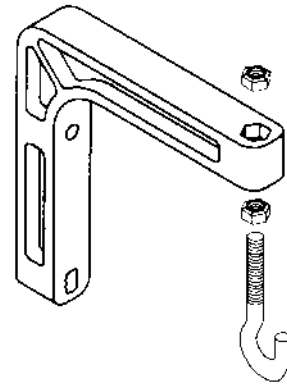

- Screen can be extended 6" from wall.
- Install eye bolts in wall brackets. Determine the height and location of the screen to be mounted and mark. Measure the distance between the centers of the 2 mounting rings on the screen. Transfer the measurement to the wall and attach the wall brackets securely to the wall at those points.
- Maximum recommended fastener size is $\frac{5}{16}$ " diameter.
- Do not overtighten fasteners.
- Hang screen on eye bolts. To provide proper tilt and eliminate keystone pull the screen down, then hook it back to the wall by attaching the bail handle to an accessory Tilt Lock, Da-Lite part No. 40965. Tilt Lock is sold separately.

No. 11 EXTENSION WALL BRACKETS

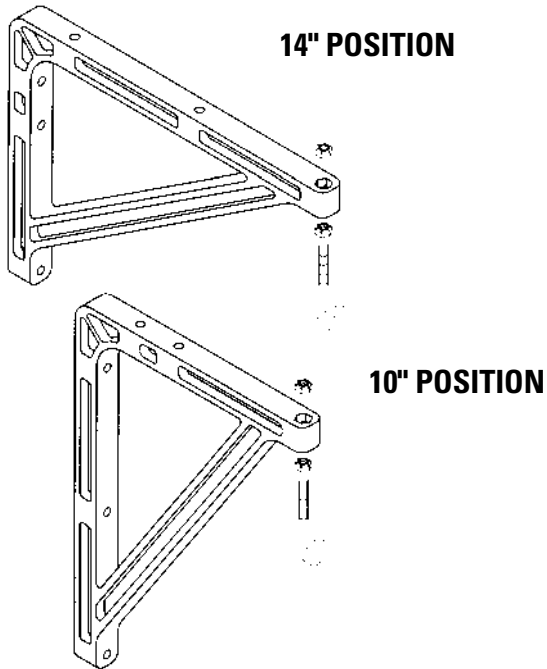

- Screen can be extended 10" or 14" from wall by simple selecting one of the two mounting positions shown above.
- Install eye bolts in wall brackets. Determine the height and location of the screen to be mounted and mark. Measure the distance between the centers of the 2 mounting rings on the screen. Transfer the measurement to the wall and attach the wall brackets securely to the wall at those points.
- Maximum recommended fastener size is $\frac{5}{16}$ " diameter.
- Do not overtighten fasteners.
- Hang screen on eye bolts. To provide proper tilt and eliminate keystone pull the screen down, then hook it back to the wall by attaching the bail handle to an accessory Tilt Lock, Da-Lite part No. 40965. Tilt Lock is sold separately.

No. 23 EXTENSION WALL BRACKETS

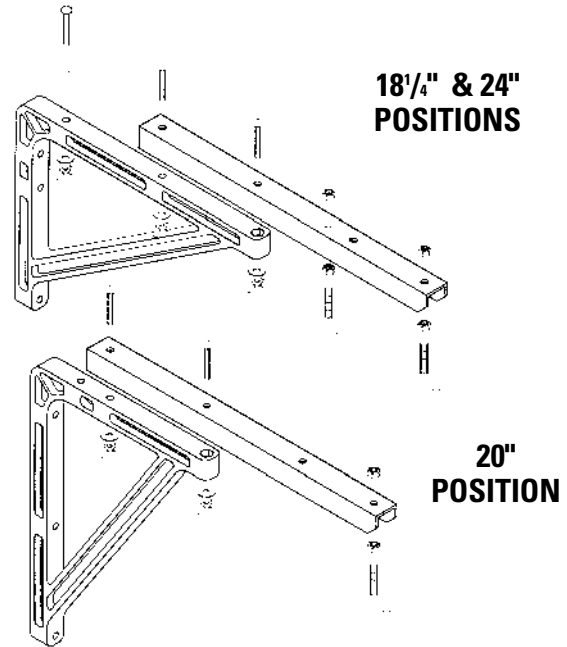

- Screen can be extended 18 $\frac{1}{4}$ ", 20" or 24" from wall by simple selecting one of the two mounting positions shown above and wing nut and bolt adjustment.
- Extension arm holes should be lined up with desired holes in plastic bracket. Attach extension arms to wall brackets.
- Install eye bolts in extension arms. Determine the height and location of the screen to be mounted and mark. Measure the distance between the centers of the 2 mounting rings on the screen. Transfer the measurement to the wall and attach the wall brackets securely to the wall at those points.
- Maximum recommended fastener size is $\frac{5}{16}$ " diameter.
- Do not overtighten fasteners.
- Hang screen on eye bolts. To provide proper tilt and eliminate keystone pull the screen down, then hook it back to the wall by attaching the bail handle to an accessory Tilt Lock, Da-Lite part No. 40965. Tilt Lock is sold separately.

EXTENSION WALL MOUNTING BRACKETS

No. 23 ADJUSTABLE EXTENSION BRACKET - SHOWING 2 POSITIONS

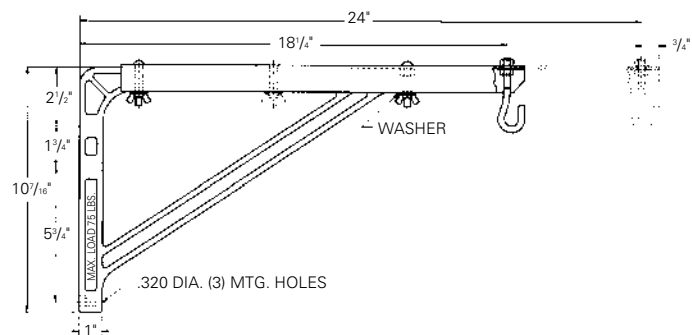

No. 11 EXTENSION BRACKET

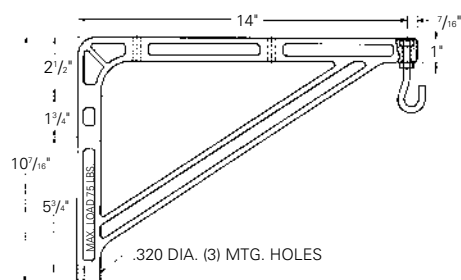

No. 23 ADJUSTABLE EXTENSION BRACKET - SHOWING 1 POSITION

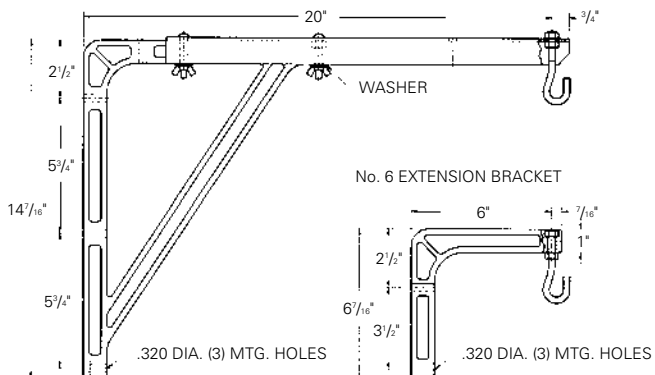

No. 6 EXTENSION BRACKET

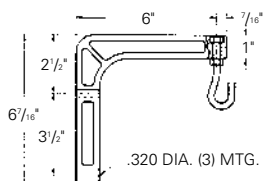

No. 11 EXTENSION BRACKET

