

datavideo Digital Video Switcher SE-500

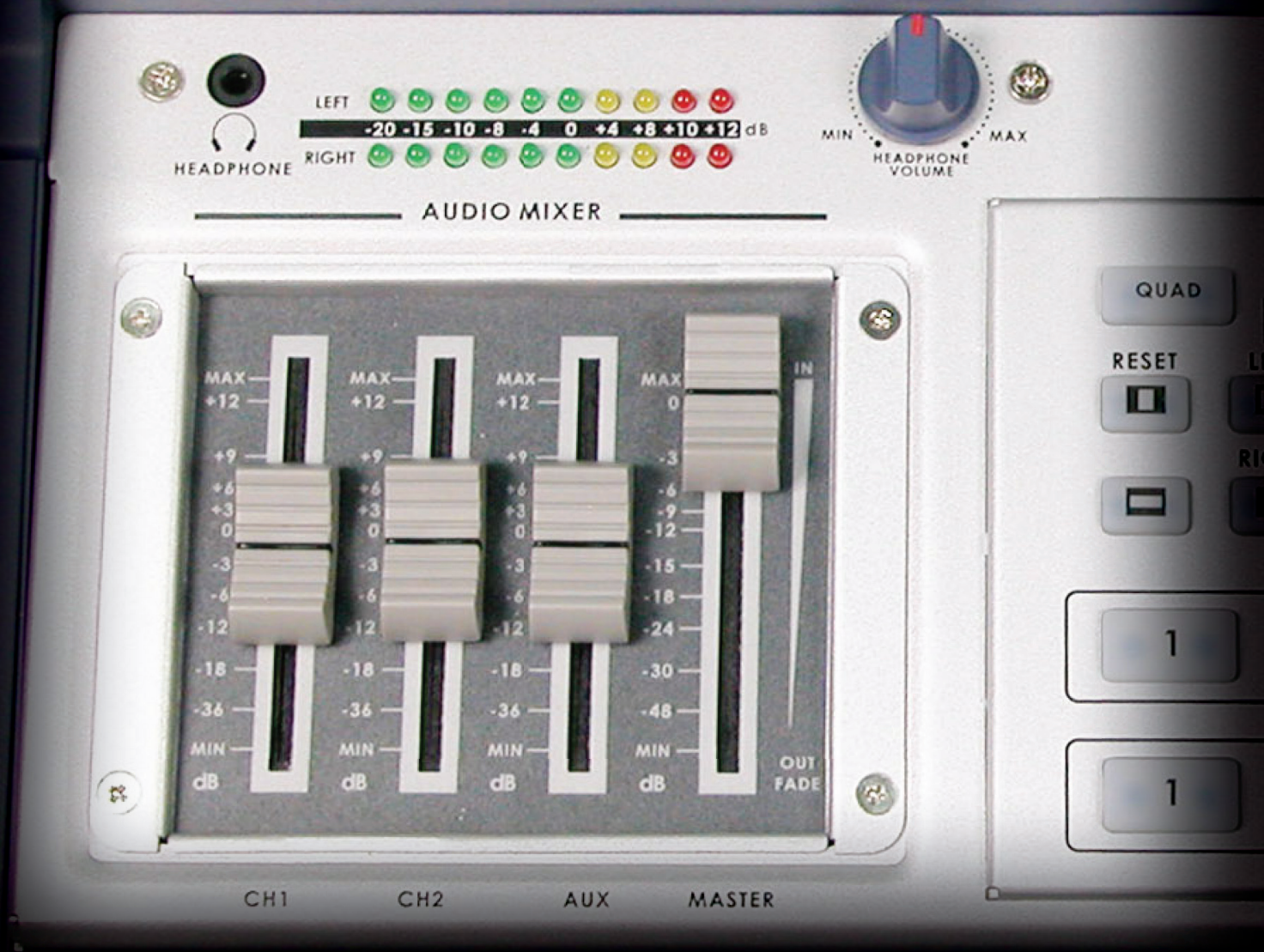

Use the 500-Series to switch up to 4 SD inputs.

SE-500 Switcher - **\$1,000** MSRP (NTSC) or **\$1,105** MSRP (PAL)

SE-500 Studio Kit - **\$3,550** MSRP (NTSC) or **\$3,650** MSRP (PAL)

HS-500 Mobile Studio - **\$2,200** MSRP (NTSC) or **\$2,305** MSRP (PAL)

*MSRP prices subject to change.

500-Series

SD VIDEO SWITCHER + AUDIO MIXER

| SD |

Switch 4 Inputs

What Makes it Special

Using Datavideo's most affordable SD switcher, offerings from the 500-Series accept up to four SD inputs in S-Video or Composite, with an output selection of Composite, S-Video, and YUV. In addition, the 500-Series provides solutions in three forms – the solitary SE-500 Switcher, the SE-500 Studio Kit, and the HS-500 Mobile Studio.

Feature List

- Multi-View Output
- Integrated Audio Mixer
- Tally Out
- Most Affordable SD Switcher
- Built-in Time Base Correctors
- Picture-in-Picture

SE-500 Switcher »



SE-500 SD Switcher

At the core of the 500-Series is the Datavideo SE-500 SD Switcher. The SE-500 is a compact, lightweight four-channel SD switcher with built-in time base correctors that accept S-Video and Composite signals. In addition to S-Video and Composite, the SE-500 also provides Component (YUV) output. It also includes two

microphone inputs and one stereo RCA pair for audio input, mixable using the integrated audio mixer. The switcher outputs audio via its RCA output port (RCA pair). Features include dissolves, flicker-free cuts, wipes, splits, Picture-in-Picture, and a color processor. The SE-500 is ideal for small churches, schools, clubs, pubs, and any other event that requires a low cost, extremely reliable, and simple-to-use switcher. It has a selectable multi-view output of the four inputs, meaning that you'll only need two video monitors – one for the inputs and one for the program output. The SE-500 can be manually operated or controlled via RS-232 or MIDI interface and works on 12V DC power.

SE-500 Rear »

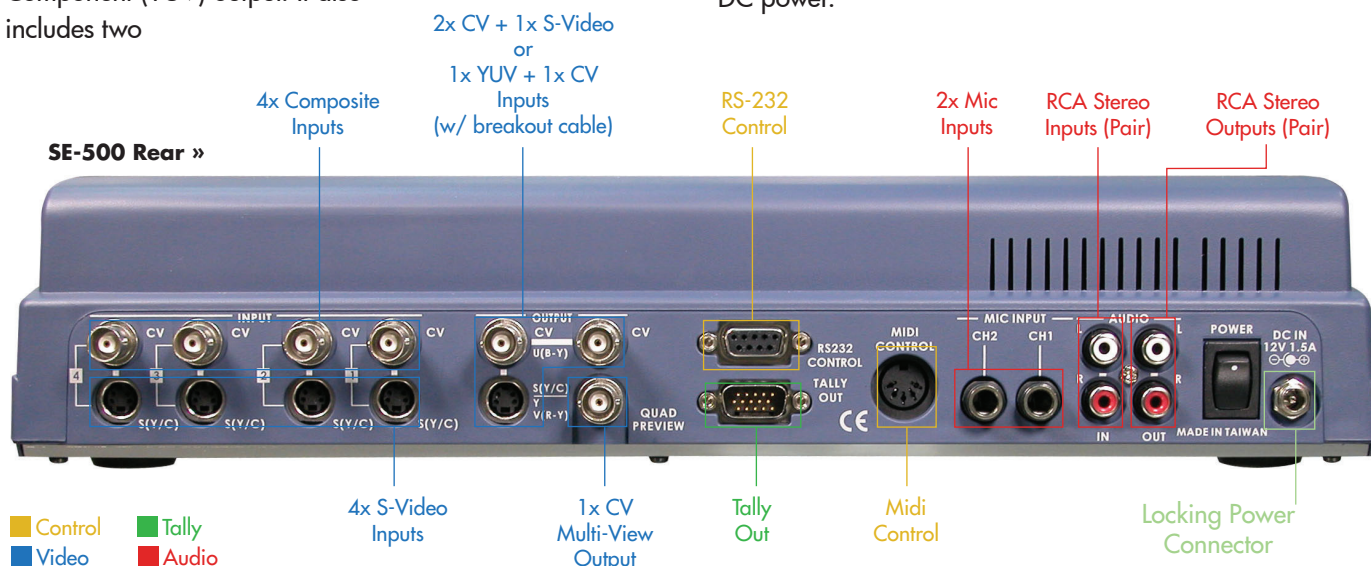

SE-500 SD Studio Kit

The SE-500 SD Studio Kit is a package that includes the SE-500 Switcher, combined with the ITC-100 Intercom and Tally System (with four sets of belt packs, tally lights, and headsets), the DN-700 Hard Drive Recorder, and the dual-screen TLM-702 Monitor. This setup provides everything needed to switch, view, and record video, with the added bonus of communication – and it all comes neatly mounted in the Datavideo RKM-572 Rack. This great setup consumes little space, is organized, and makes for a powerful production tool. Get up and running FAST with this all-in-one solution.

HS-500 SD Mobile Studio

The HS-500 is designed to be live in seconds with easy setup, breakdown, and storage at any location.

Like the Studio Kit, the HS-500 Mobile Studio is a combination of fantastic items built around the SE-500 Switcher. However, unlike the Studio Kit, the Mobile Studio is built inside a handheld case, with emphasis on easy transportation. In total, the package consists of the SE-500 Switcher and the TLM-702 Dual-Screen Monitor, integrated into a durable metal case that can be simply flipped-open, powered, and operated, quickly and easily.

Integrated Audio Mixer

The 500-Series' switcher includes a built-in audio mixer with individual volume controls for channel 1, channel 2, and auxiliary, as well as one master volume slider.

Most Affordable SD Switcher

The SE-500 is Datavideo's most affordable SD switcher. It combines powerful features with low cost.

Picture-in-Picture

The 500-Series allows for one PiP image displayed over the main program output. With this feature, you can have one large video with a smaller one in front.

Locking Power Connector

The 500-Series is made with locking power connectors for added security.

The Ins & Outs

The 500-Series is made with four Composite and four S-Video inputs. Any combination of up to four inputs may be used. As for the video outputs, the 500-Series has two Composite Video ports and one S-Video port for Program output. Alternatively, one S-Video and one CV port may be converted to a single YUV output set using the supplied breakout cable -- one CV port will remain. In addition, there is one Composite output for the quad preview, which may be viewed on a single screen.

For audio inputs, the 500-Series is made with two microphone inputs (channel one and channel two), as well as one stereo RCA pair (left and right). The audio outputs simply consist of a single stereo RCA pair.

The SE-500 is Datavideo's Most affordable SD switcher.



SE-500 Studio Kit »



HS-500 Mobile Studio »

Expanding the System



DN-600 – Save your masterpiece with the DN-600 Hard Drive Recorder. Unless purchasing the Studio Kit (which already comes with a recorder), you may be interested in reliable and convenient storage to archive the production. Conveniently, the recorder has outputs to allow the Program to be carried to additional devices, such as a projector.



TP-100/300 - TP-100 or TP-300 can provide a teleprompting solution for hosts, interviewers, and other talent. The TP-100 integrates with the iPhone® or Android® Phone, while the TP-300 functions using the iPad® or Android® Tablet.



CG-100 – A computer equipped with the CG-100 software may be used to embed text and graphics into the video.



AD-100 – When the video signal is slowed by long transport routes from wires, processing devices, etc., the video will lag behind the audio. To keep everything in sync, the audio may need to be delayed to match the video. Audio Delay needs can be handled with the AD-100, which allows audio to be slowed by anywhere from 0 ~700 milliseconds.



Cables -- CASDI-50, 100, and 150 are BNC cables that come in lengths of 50, 100, and 150-feet, respectively.



ITC-100 – Integrate the system with the SE-500 Switcher or HS-500 Mobile Studio to give your crew tally lights and communication (already included in the Studio Kit). The ITC-100 plugs into the back of the SE-500 for easy tally setup, and it includes four belt packs, tally lights, and headsets.



VP-299 – Need to split inputs for your program output? The VP-299 takes the S-Video or Composite output from the switcher and splits it into four signals in S-Video or Composite. This allows you to send the signal of your choice to four different destinations – a recorder, a monitor, a computer, and more.



TB-5 – Need a tally light solution without intercom system? The TB-5 plugs directly into the switcher's tally-out port for quick and easy setup. 4x tally lights (included) plug into the TB-5 using 3.5mm cables. The system is fully synched with the switcher's Program and Preview selections. Tally lights will illuminate amber for "up next" and red for "live."

Connecting the SE-500

The diagram on the next page shows one of the many possible production configurations using the SE-500 Switcher. The difference between this diagram and one made with the Mobile Studio is that the latter will already include a built-in TLM-702 Monitor. The Studio Kit version includes the same monitor, plus an integrated intercom/tally system and hard drive recorder.

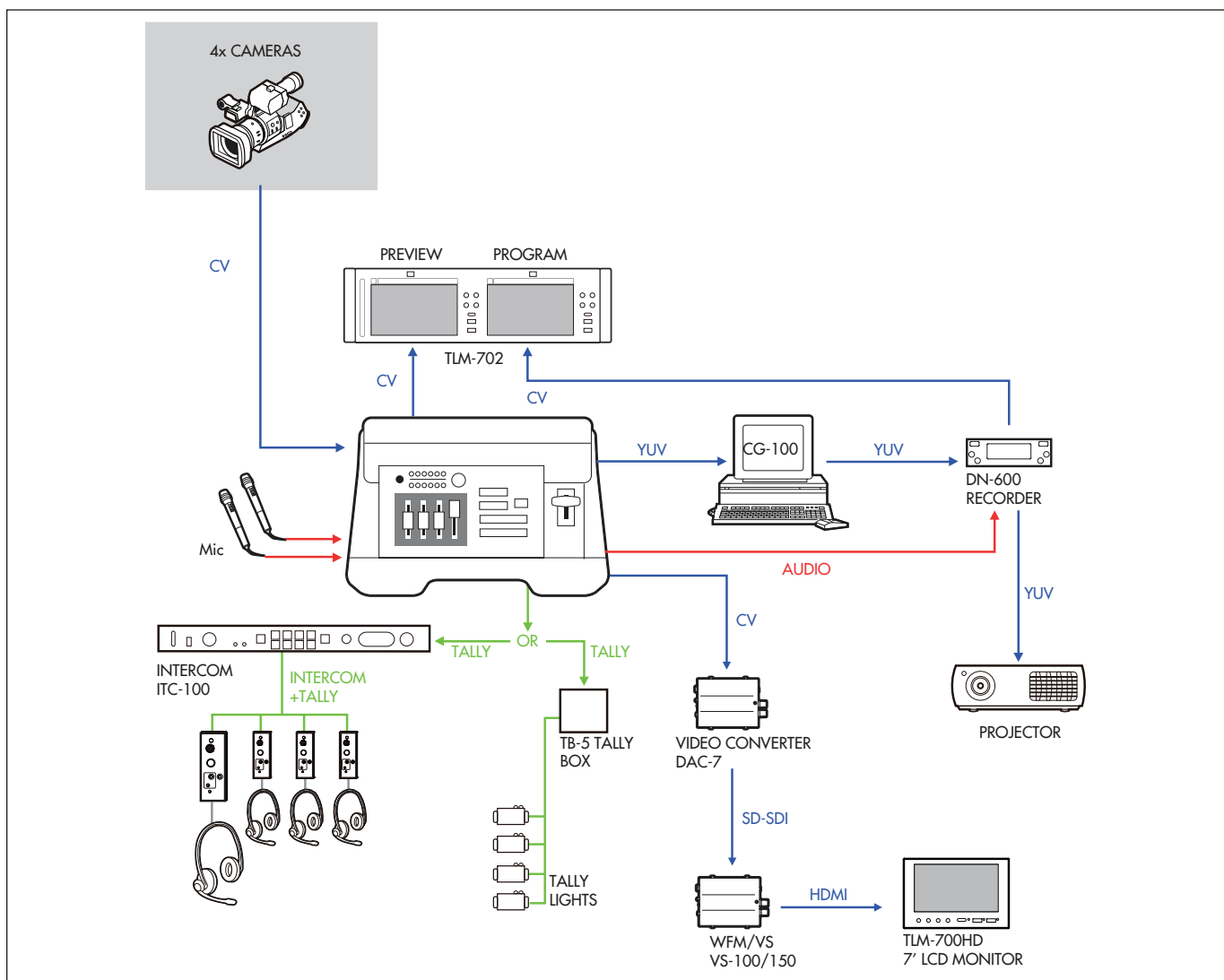

500-Series Specifications

	SE-500 Switcher	SE-500 Studio Kit	HS-500 Mobile Studio
Video Inputs	4x Composite Video, 4x S-Video -- Maximum 4 Channels		
Video Outputs	2x CV, 1x S-Video (w/o breakout cable) OR 1x YUV, 1x CV (w/ breakout cable) ... +1x CV (Multi-View)		
Audio Inputs	2x Mic, RCA Pair (L/R)	2x Mic, RCA Pair (L/R)	2x Mic, RCA Pair (L/R)
Audio Outputs	2x RCA	2x RCA	2x RCA
Tally	1x D-SUB Output	4x Tally Lights	1x D-SUB Output
Intercom	n/a	ITC-100 Intercom System with 4x belt packs and head sets	n/a
Control	RS-232, MIDI	RS-232, MIDI	RS-232, MIDI
Monitor	n/a	TLM-702 Dual-Screen Monitor	TLM-702 Dual-Screen Monitor
Recorder	n/a	DN-700 Hard Drive Recorder	n/a
Casing	n/a	n/a	Metal