



RDL®
Radio Design Labs

SPECIALISTS IN PRACTICAL PRECISION ENGINEERING™

SourceFlex™ System

Models D-SFRC8L, DS-SFRC8L, DB-SFRC8L

Room Control Station for SourceFlex Distributed Audio System



- Single Room Listening Station with In-Wall Controls
- Source Selection Pushbutton
- Selection From up to 8 Audio Sources
- Line-Level Audio Output

- Mounts In Wall Using US Single Gang Electrical Box or RDL® WB-1U
- Compatible with Other RDL Wall Plates and Controls
- Ideal for Office Distributed Sound Systems with Music and Paging
- Available in Stainless, Black or White

The D SERIES-SFRC8L is part of the group of versatile accessory products from Radio Design Labs. These modules combine durable construction with high quality components and attractive, professional graphics. The D SERIES-SFRC8L mount in separately available electrical wall boxes and cover plates.

APPLICATION: The D-SERIES-SFRC8L Audio Selector is a SourceFlex module for wall mounting in a room, providing source selection from up to 8 audio sources. A numeric display shows the selected source. There are two line-level audio outputs on the rear of the unit, balanced and unbalanced, to feed an external power amplifier.

The balanced line output level is +4 dBu nominal. The unbalanced output is -10 dBV.

The -SFRC8L is designed to be mounted in a wall box. Wiring is connected through a rear-panel detachable terminal block. The -SFRC8L is ideal for office distributed sound systems with background music and a paging source.

SourceFlex™ System

Models D-SFRC8L, DB-SFRC8L, DS-SFRC8L Room Control Station for SourceFlex Distributed Audio System

Installation/Operation



EN55103-1 E1-E5; EN55103-2 E1-E4
Typical Performance reflects product at publication time exclusive of EMC data, if any, supplied with product. Specifications are subject to change without notice.

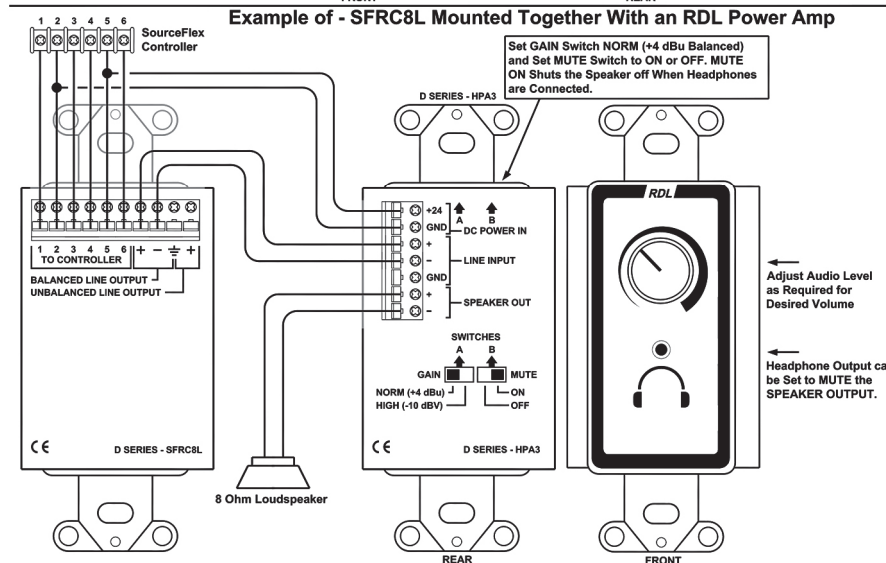
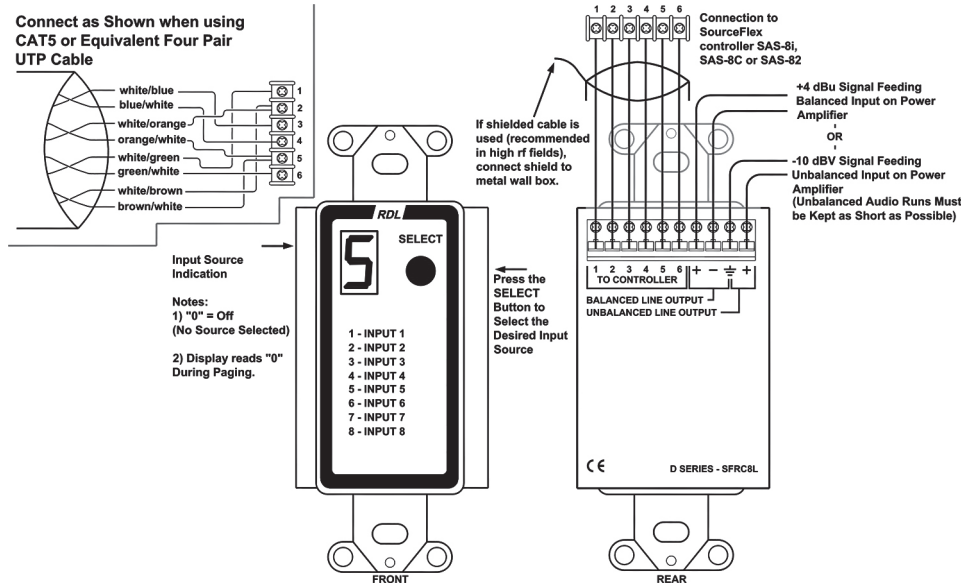

TYPICAL PERFORMANCE

Input: 10-position terminal block
Display: 7-segment red LED (0 = off or Paging; 1 through 8 = selected channel)
Selector: Momentary button channel SELECT
Frequency Response: 20 Hz to 20 kHz (± 0.1 dB)
THD+N: < 0.1% (20 Hz to 20 kHz)
Noise: < -85 dB (Below +4 dBu)
Control Signals: dc (DISPLAY RAMP and CONTROL conductors between remote Listening Station and Controller)
Line Outputs (2): +4 dBu balanced, -10 dBV unbalanced, nominal
Power Requirement: 24 Vdc @ 30 mA, Supplied from SourceFlex controller
Ambient Operating Environment: 0° C to 40° C Maximum; 20° C Recommended
Dimensions: Height: 4.13 in. 10.49 cm; Width: 1.7 in. 4.32 cm; Depth: 2.05 in. 5.21 cm

Radio Design Labs Technical Support Centers

U.S.A. (800) 933-1780, (928) 778-3554; Fax: (928) 778-3506

Europe [NH Amsterdam] (+31) 20-6238 983; Fax: (+31) 20-6225-287