

VZ-HDARM – Heavy Duty Articulated Arm

The HD Arm is extremely simple to operate. The clamp can be attached to tubes as shipped, or if you remove the wedge-shaped “saddle” and insert it into the V-groove, the clamp will attach to flat surfaces (like table edges, doors, thin walls, etc.).

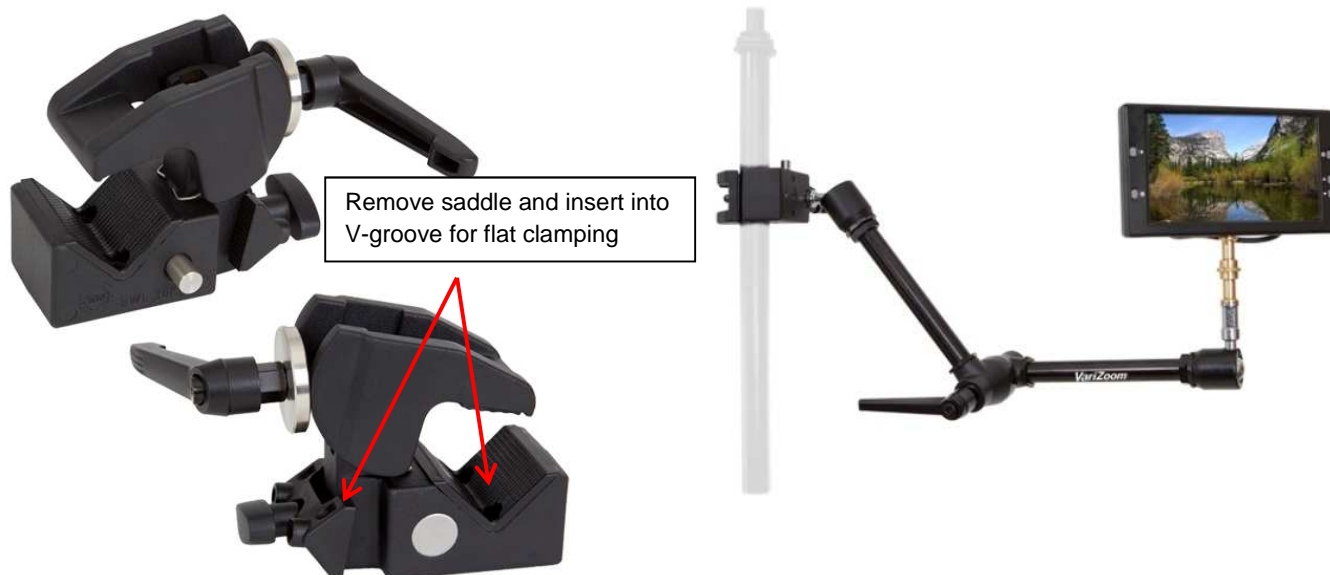

The arm itself attaches to the clamp at the hex socket. You'll have to loosen the locking screw and depress the safety catch pin to insert the arm joint into the hex socket, then tighten the locking screw. Adjusting the arm is very intuitive. Simply loosen the large handle in the center and you'll see the end joints can rotate. Loosen the large handle enough and you can disengage the serrated clutch in the middle and change the angle of the two main arm sections. The position of the large handle can also be rotated without loosening the joint by lifting the handle up and turning it (lifting disengages the screw mechanism).

The included brass stud is threaded $\frac{1}{4}$ "-20 one end and $\frac{3}{8}$ "-16 on the other end – likewise with the arm end joints. Also included are $\frac{1}{4}$ "-20 and $\frac{3}{8}$ "-16 studs w/ washers for increased mounting flexibility and for mounting to the VariZoom QuickJib or SnapCrane (late models only).

The HD Arm is very intuitive and robust, so we encourage you to play around with it to get the best idea of how to use it for your needs. It's hard to use it wrong – *just don't try to take it apart, because that's one thing we don't cover under warranty! Thanks for your purchase!*

www.varizoom.com / 512-219-7722

Warranty: 2 years parts and labor

