

Parts List

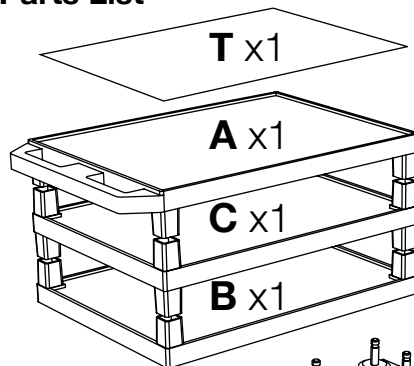

Tools Required

- Rubber Mallet
- Wrench

NOTICE:
Leg lengths may
vary by model

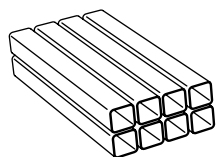

E x8

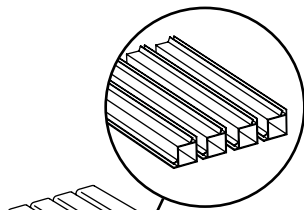

F x4

Optional fluted
legs for units with
cabinet pack

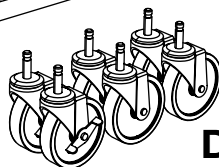

D1 x4

D2 x2

T2 x1

A2 x1

C2 x1

B2 x1

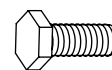

Q x12



R x12



S x12

1

NOTICE:
Use wrench to
tighten bolt **Q** &
locking nut **S**

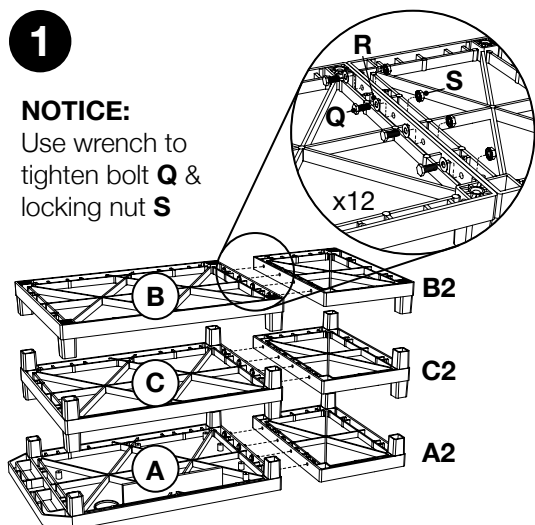

2

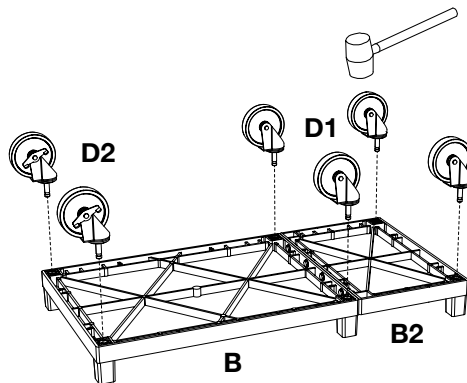

3

Install optional cabinet pack /
pullout shelf / locking drawer
assembly after step 2

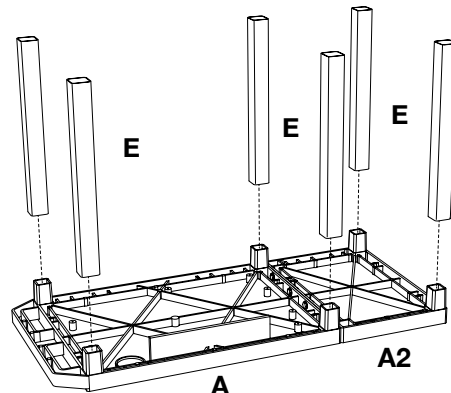

4

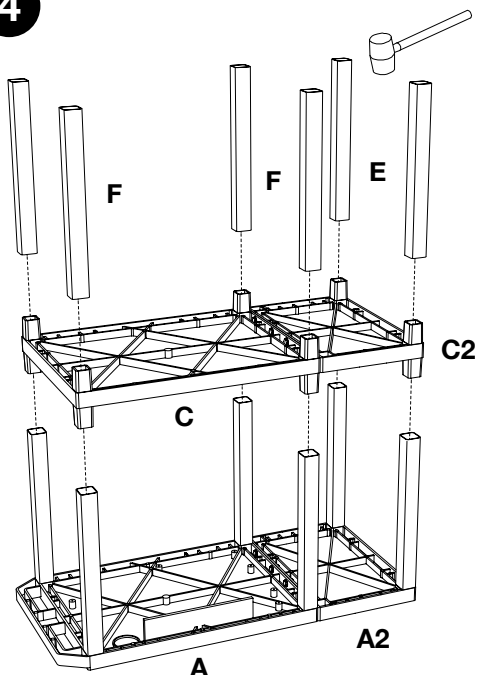

5

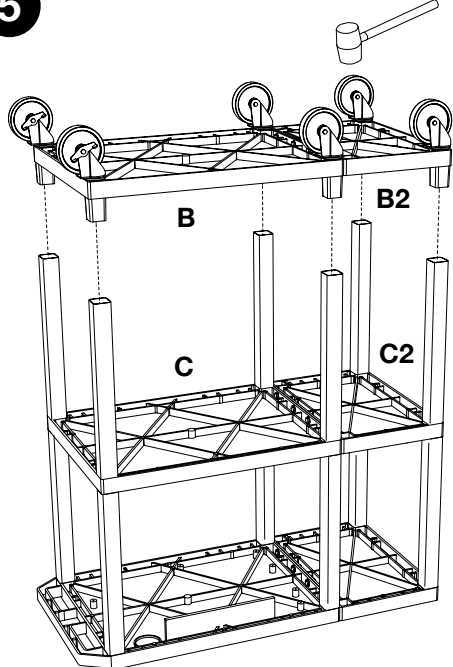

6

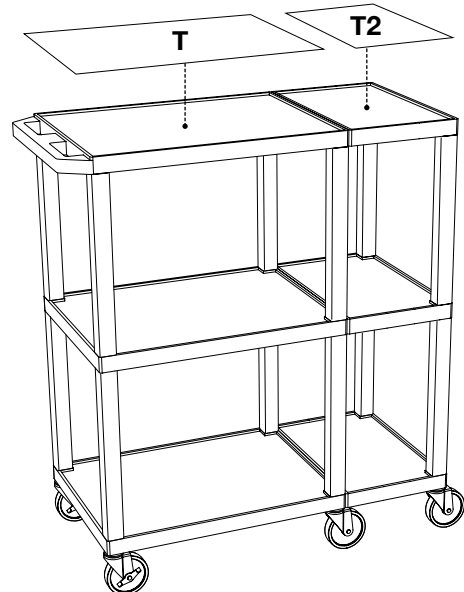

www.luxorfurn.com
www.hwilson.com

Parts List

Tools Required

- Phillips Screwdriver
- 13mm Socket Wrench
- Drill + 3/8" or 9mm Drill Bit (Not required on units with pre-drilled hole)

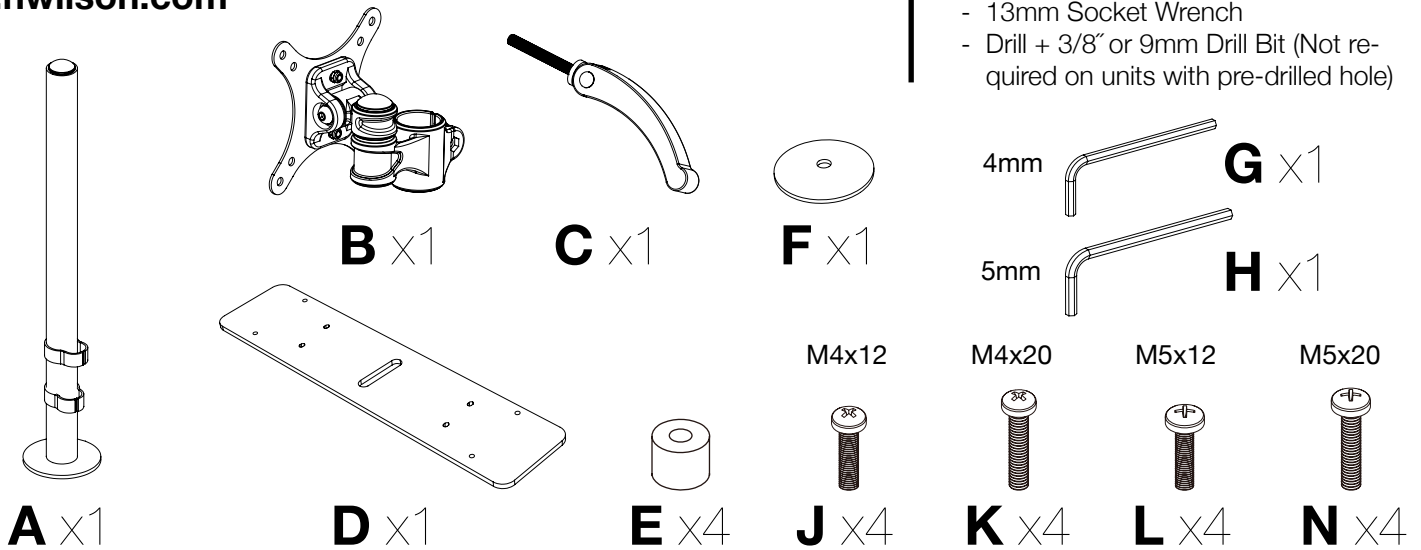

Self Install Instructions:

For plastic ribbed shelf drill into sections where the cross ribs intersect. For other surfaces make sure there is 3" x 12" of clearance for the mounting plate.

WARNING: Please follow the cautionary guidelines included with your drill.

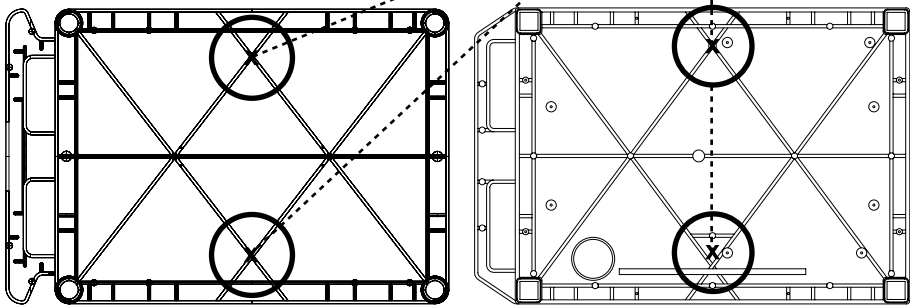

Bottom of Luxor Top Shelf

Bottom of H.Wilson Top Shelf

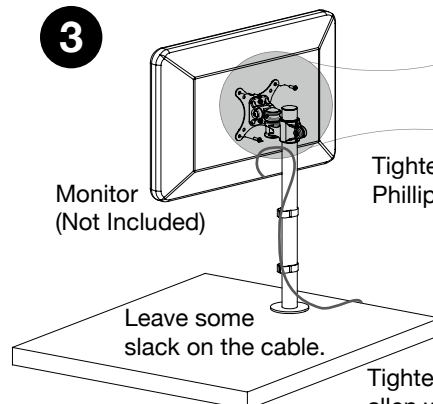
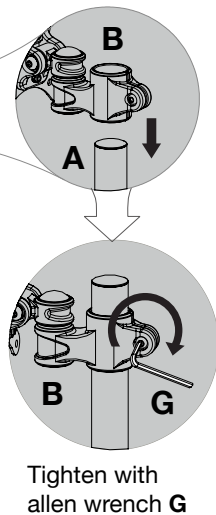
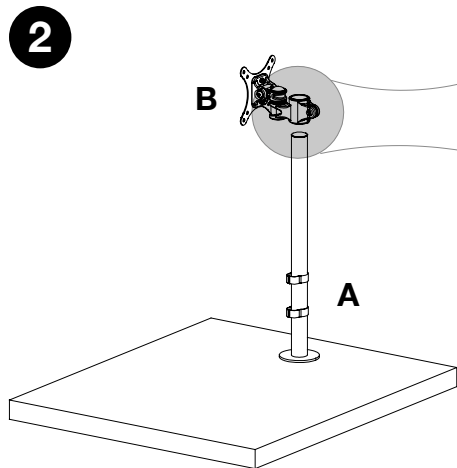
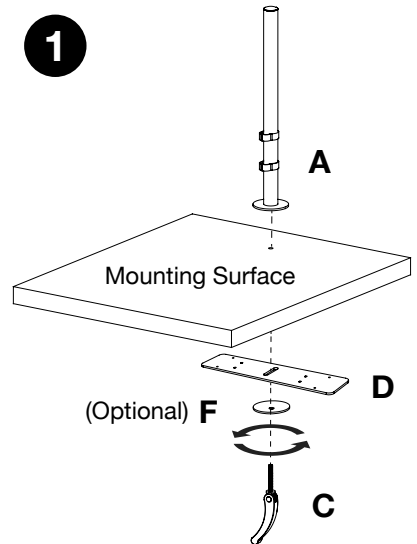

Insert spacers E on screens with counter sunk hole patterns

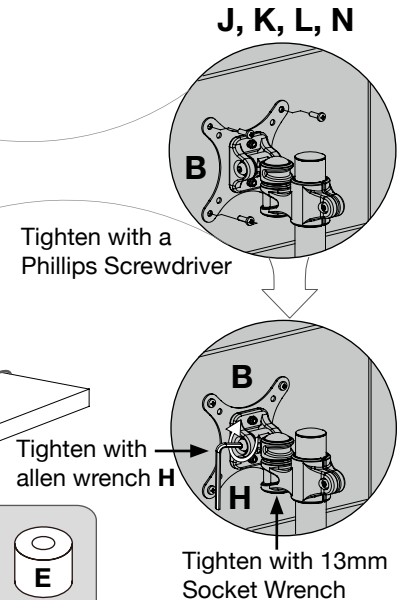

Parts List

Tuffy Cart

Tools Required

- Phillips Screwdriver

G x1

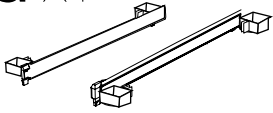

H x1



K x1



L x2



M x6

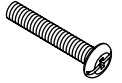

N x4

- 1** Lay the top shelf of your Tuffy cart upside down and install the four legs intended for this shelf.

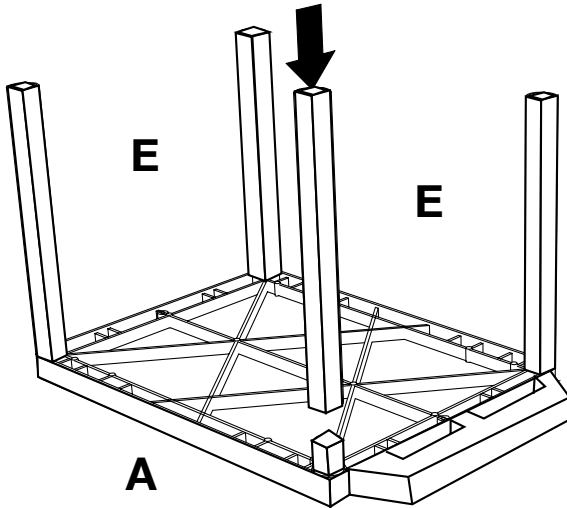

- 2** Slide and align runner **H** & **G** onto the legs and tighten screw **N** with a screwdriver.

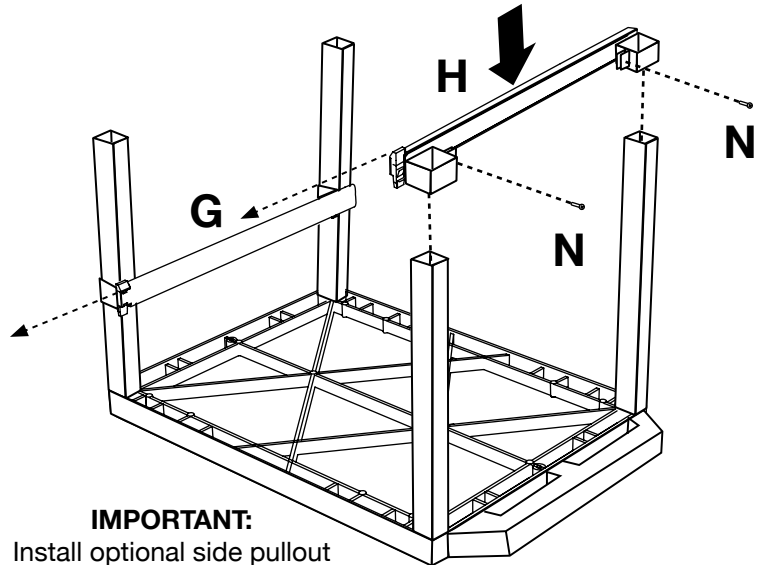

IMPORTANT:
Install optional side pullout shelf **AFTER** step 2

- 3** Take pullout shelf **K** and bracket **L** and screw together into the unfinished surface of shelf **K** with screw **M**.

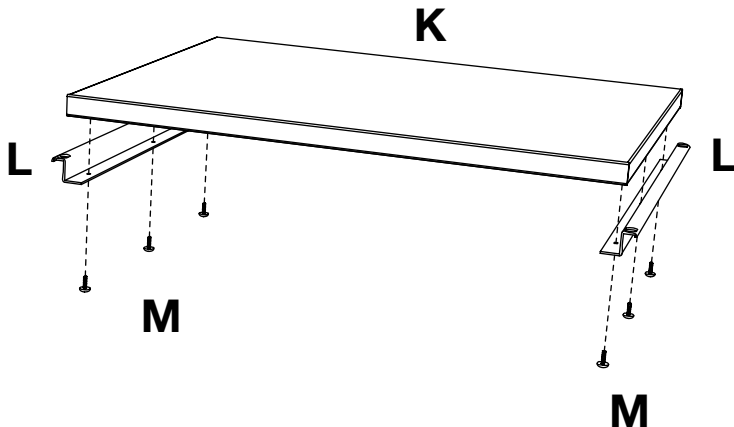

- 4** Mount pullout shelf **K** to runner **H** & **G** so that the edge of the shelf snaps into the runner hooks.

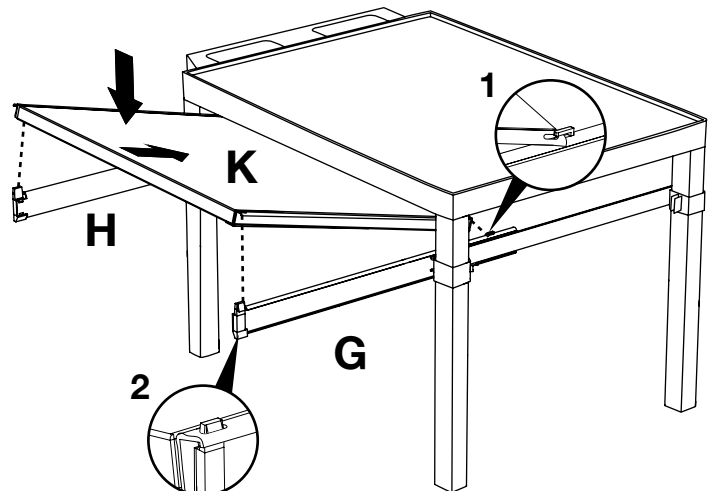

You have now completed your pullout shelf.

www.luxorfurn.com
www.hwilson.com

Electric Assembly Instructions

Number of outlets
may vary.

Parts List

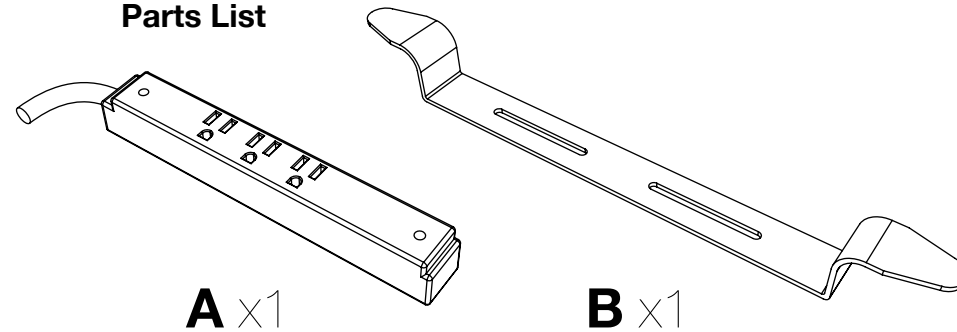

Tools Required

- Screwdriver

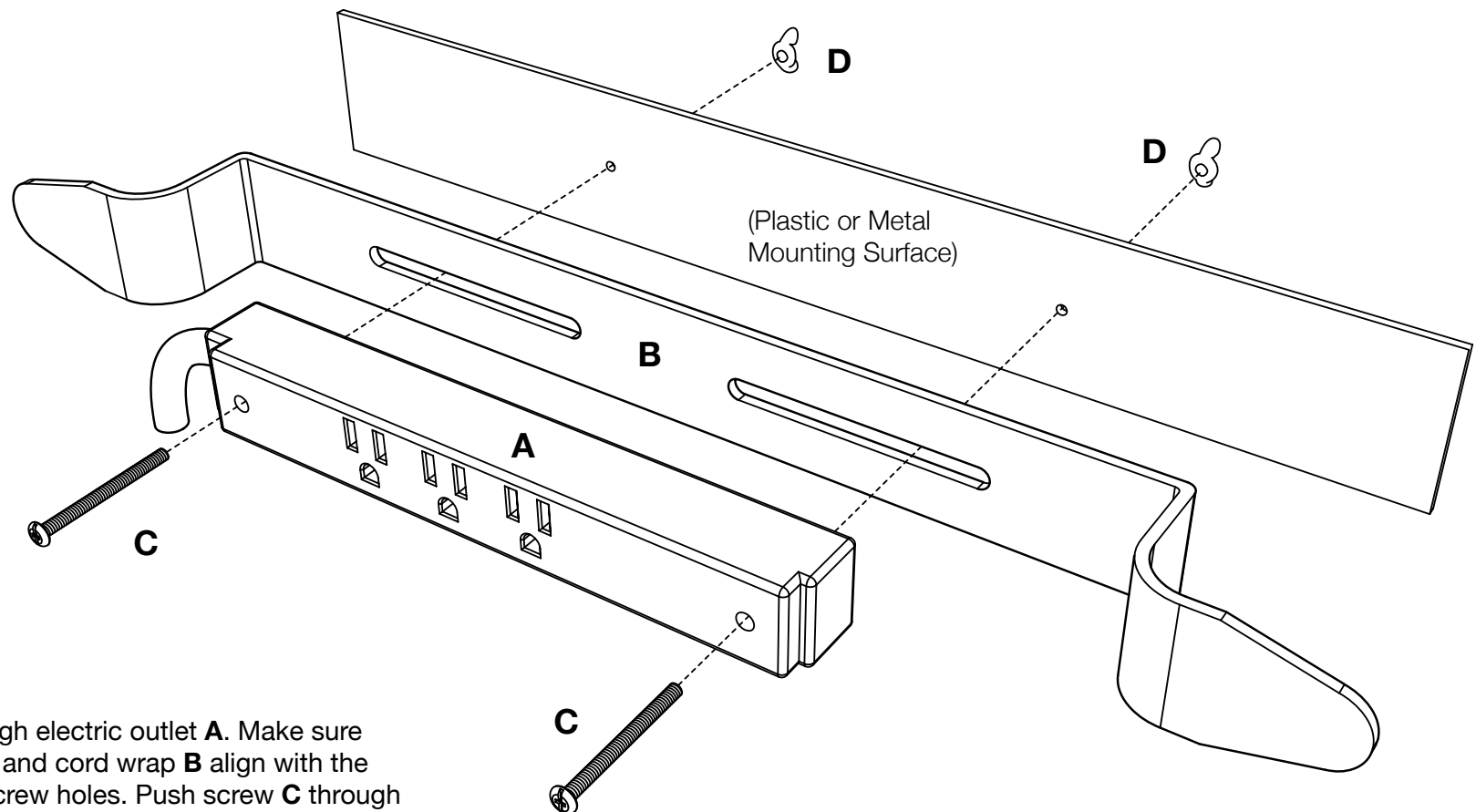
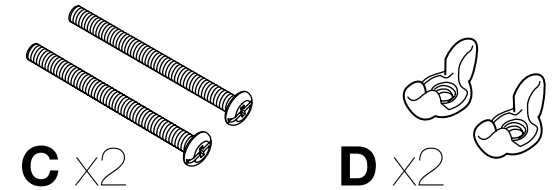

1

Push screw **C** through electric outlet **A**. Make sure the electric outlet **A** and cord wrap **B** align with the mounting surface screw holes. Push screw **C** through cord wrap **B** and the mounting surface screw holes. Use wing nut **D** and screwdriver to fasten.