

POWERED  
SPEAKER

# MSR100



*Compact in size but big in sound and versatile features, the MSR100 packs a powerful sonic punch — making it ideal for a wide range of applications and almost anywhere in your stage setup.*

# All-in-one sound solution — powerful, versatile, reliable

## All-around performer

The MSR100 fills many sound reinforcement and stage monitor needs in one inexpensive, lightweight package. As a mixer, power amplifier, and speaker system combined in a single, compact unit, it's perfect for small events and club gigs. Mix in a CD player, rhythm machine and/or keyboard with your voice — all without the need of a separate mixer or power amplifier. And since it's made by Yamaha, the MSR100 provides the high-quality performance you need with exceptional ease-of-use and reliability.

## High power, great sound

The 100-watt power amplifier built into the MSR100 delivers plenty of output, ensuring that you'll be heard with full dynamic range and clarity. This specially designed amplifier has been optimized for use with the speaker section of the MSR100 to give you the absolute clearest and cleanest sound possible.

An 8" custom woofer handles the low end, while a 1" pure titanium diaphragm compression driver delivers the high frequencies. The horn of the MSR100 provides a wide 90°X40° sound dispersion for optimum audience coverage.

## Versatile mixer and connections

A simple but effective mixer built into the rear of each unit provides 3 inputs with master EQ for precise sound control. The input 1 XLR connector accommodates almost any microphone or line input (with a -50dB/+4dB pad switch), while line sources can be connected by phone jack to the input 2 and input 3 connectors. This makes the MSR100 perfect for small events and club gigs. Naturally, each input has its own level control, with a Master Level control for overall

output. Two-band EQ — high and low — gives you further control over the final sound. A convenient CLIP indicator alerts you when the input signal is too high, letting you avoid distortion. For larger events, the MSR100's special LINK OUT jack can be used to connect multiple units and expand your sound coverage.

## Flexible placement options

The MSR100 is compact, lightweight, and ready to go anywhere you go. Besides a built-in handle, its distinctive design lets you stand the unit upright for conventional sound reinforcement, or lay it on its angled side for use as a floor monitor.

The MSR100 is as rugged as it is versatile, with a durable polypropylene enclosure that stands up to the rigors of the road. A variety of mounting options also let you place it on a pole, suspend it from the ceiling, attach it to a wall, or even safely stack multiple units on the floor.

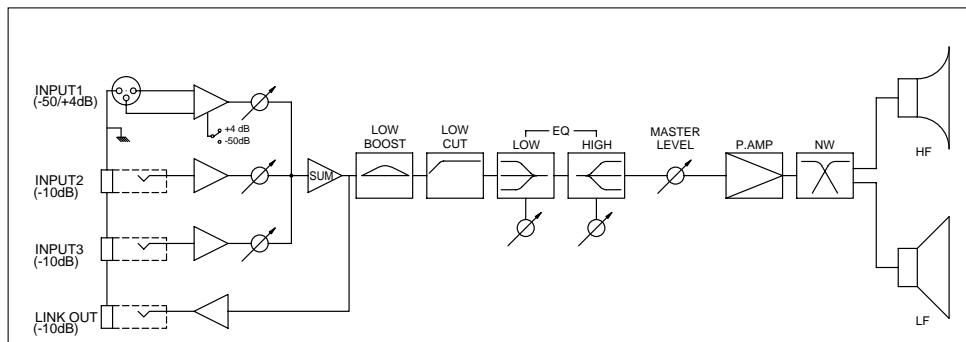
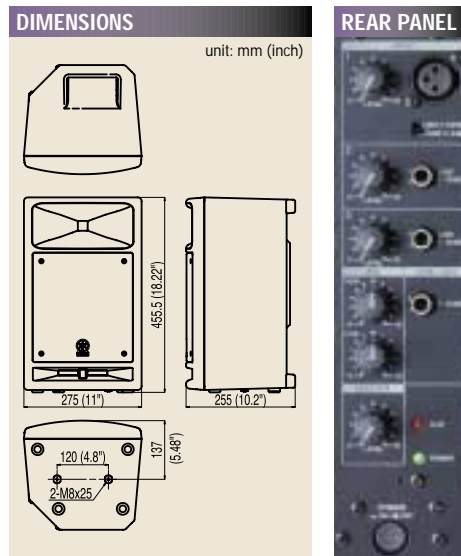

## All-in-one features and versatile connections — for any application or setup

### Compact, yet powerful stereo PA system

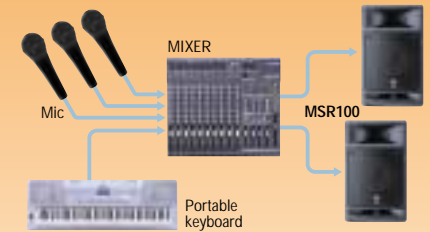

### Convenient monitoring system in larger setups

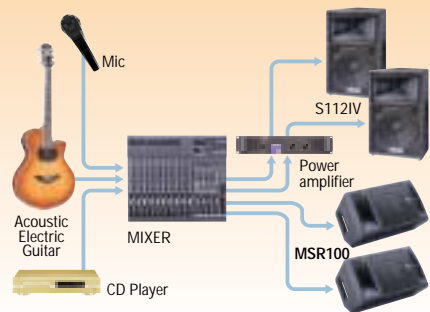

## SPECIFICATIONS

### GENERAL

Type	2-way Bass Reflex Powered Speaker
Components	LF: 8" Cone HF: 1" Compression Driver
Frequency Response	55Hz-20kHz (-10dB)
Maximum SPL	112dB (1m)
Dispersion	90° (H) / 40° (V)
Dimensions (WxHxD)	275x455.5x255mm (10-13/16"x17-15/16"x10-1/25")
Weight	11kg (24.2lbs)

### AMPLIFIER SECTION

Maximum Output Power	100W at 1kHz, THD=1%, RL=6Ω
Crossover Frequency	4kHz
Input Sensitivity	INPUT 1: -50dB*/+4dB* (with select SW) INPUT 2 & 3: -10dB*
Input Impedance	LINE 1 & 2 & 3: 10kΩ
Link Out	-10dB* / 10kΩ
Controls	Level Control INPUT 1 & 2 & 3, Master Level EQ: LOW: ±3dB at 60Hz, HIGH: ±6dB at 10kHz
Power Switch	ON / OFF
Connectors	INPUT 1: XLR-3-31 (balanced) INPUT 2&3: Phone (unbalanced) LINK OUT: Phone (unbalanced)
Indicator	Green LED: Power on, Red LED: Clip
Power Requirements	US & Canadian Models: AC120V 60Hz European Models: AC230V 50Hz AT Models: AC240V 50Hz
Power Consumption	US & Canadian Models: 70W European Models: 70W AT Models: 70W
Optional Accessories	Wall Bracket: BWS50-260/320 Ceiling Bracket: BCS251 Baton Bracket: BBS251 Speaker Stand: STS-50

\*0dB=0.775V Specifications and appearances are Subject to change without notice.

YAMAHA CORPORATION  
P.O. BOX 1, Hamamatsu Japan

<http://www.yamaha.co.jp/english/>  
<http://www.yamaha.co.jp/product/proaudio/homeenglish/>



This document is printed on chlorine-free (ECF) paper with soy ink.



CREATING 'KANDO' TOGETHER

'KANDO' ...Inspiring the Heart and Spirit.

LPA470 Printed in Japan