



User Guide

SW925 DIGITAL AUDIO TRAVEL PARTNER PLUS

Battery Powered PA System

READ FIRST ABOUT BATTERY OPERATION!

BY OBSERVING A FEW SIMPLE RULES, YOU CAN EXTEND THE LIFESPAN OF THE SEALED LEAD ACID (SLA) BATTERIES THAT OPERATE YOUR AMPLIVOX BATTERY POWERED PORTABLE PA SYSTEM OR ACCESSORY:

- ALWAYS KEEP YOUR AMPLIVOX PORTABLE PA SYSTEM PLUGGED IN AND CHARGING WHEN NOT IN USE.
- FOR LONG TERM STORAGE (OVER 1 MONTH) WE RECOMMEND DISCONNECTING THE SLA BATTERIES TO AVOID GRADUAL, CONTINUOUS DISCHARGE.
- ALWAYS STORE SLA BATTERIES IN A CHARGED CONDITION WHEN REMOVED FROM SERVICE.
- NEVER LET THE BATTERY VOLTAGE DROP BELOW 10V.
- FOR SLA BATTERIES IN STORAGE, APPLY A TOPPING CHARGE EVERY SIX MONTHS.
- AVOID REPEATED DEEP DISCHARGES. THIS PRACTICE WILL CUT THE LIFE OF THE BATTERY SIGNIFICANTLY.
- AVOID OPERATING SLA BATTERIES AT ELEVATED AMBIENT TEMPERATURES.
- BATTERY STATUS INDICATOR - RED = NO BATTERY POWER, YELLOW = ABOUT 3 HOURS LEFT. CHARGE BATTERY OVERNIGHT



Made in the USA



Photo may appear different then your actual unit.

Thank you for choosing the **SW925 Digital Audio Travel Partner Plus PA System** from *AmpliVox Portable Sound Systems*.

We are excited in introducing this truly unique system. Our system combines flexibility with functionality. Please refer to this user guide as you enjoy the unique capabilities of another quality product from *AmpliVox Portable Sound Systems*.

We encourage you to visit our website **www.ampli.com** to register your product for its warranty coverage, sign up to receive our newsletter, download our catalog, and learn more about the complete line of *AmpliVox* audio visual products, including portable PA systems, and lecterns.

TABLE OF CONTENTS

GETTING STARTED/QUICK SETUP.....	3
CONTROL / BACK PANEL	4
MEDIA PLAYER	5
AUDIO FUNCTIONS	5
WIRELESS RECEIVER / TRANSMITTER.....	6
WIRELESS HANDHELD MICROPHONE.....	6
BLUETOOTH MODULE	7
OPTIONAL EQUIPMENT	
WIRELESS SPEAKER TRANSMITTER.....	8
TROUBLESHOOTING.....	9
WARRANTY.....	10

IMPORTANT SAFETY INSTRUCTIONS

Before using this product, read the instruction manual for important safety information. Please retain this manual for future reference and warranty information.

Troubleshooting & Servicing

Do not attempt to service or repair the device yourself. Refer all servicing to qualified service personnel. Do not attempt to modify the device in anyway. Doing so could invalidate your warranty.

Cleaning

When cleaning the device, please use a soft, dry cloth. Never use benzene, paint-thinner, or other chemicals on the device.

Location

Place the device in stable location, so it will not fall causing damage to the device or bodily harm.

Intended use

The product may only be used with the original parts intended for it. The intended use includes adherence to the specified installation instructions. The manufacturer accepts no liability for damage arising due to improper use.

WARNING: Changes or modifications to this unit not expressly approved by the party responsible for compliance could void the user's authority to operate the equipment.

IMPORTANT

This device complies with Part 15 of the FCC Rules. Operation is subject to the following two conditions: (1) This device may not cause harmful interference, and (2) this device must accept any interference received, including interference that may cause undesired operation.

The unit's circuitry may cause interference to nearby radios. To prevent interference, either switch the unit off or move away from the affected radio.

NOTE: This equipment complies within the limits for a class B digital device, pursuant to Part 15 of the FCC Rules. These limits are designed to provide reasonable protection against harmful interference in a residential installation. This equipment generates, uses and can radiate radio frequency energy and, if not installed and used in accordance with the instructions, may cause harmful interference to radio communications. However, there is no guarantee that interference will not occur in a particular installation. If this equipment does cause harmful interference to radio or television reception, which can be determined by turning the equipment off and on, the user is encouraged to try to correct the interference by one or more of the following measures:

- Increase the separation between the equipment and receiver.
- Connect the equipment into an outlet on a circuit different from that to which the receiver is connected.
- Consult the dealer or an experienced radio / TV technician for help.

NOTE: Shielded cables may be required to be used with this unit to ensure compliance with the Class B FCC limits.

Getting Started/Quick Setup (Also Printed on Battery Cover)

- **POWER** - Push POWER switch (lower left) to ON, Switch lights up. All accessories have separate ON / OFF power switches.
- **MEDIA PLAYER** - Turn ON / OFF switch to the right of media player to turn on. Insert USB Thumb Drive /SD Card into slot and select track.
- For Bluetooth turn on with the volume control switch. Press center button to start pairing. Select AmpliVox / AmpliVox S1500 or 0000.
- **WIRELESS MIC** - Turn power on. Select channel using the up/down buttons. Channel must match channel on microphone.
- **WIRED MICROPHONES**: Up to 3 wired XLR or 1/4" connector type microphones can be used. Press MIC/LINE button to turn on. Press PHANTOM POWER only for XLR type microphone. Cannot use both types at the same time.
- **AUX**: Use for plugging other Audio Devices into PA.
- **INPUTS**: (3); RCA, 1/8", 1/4". Separate Volume control to adjust sound.
- **AUDIO LINE OUTPUT**: (1/4" jack) Use for connecting to a device for recording or auxiliary speakers.
- **VOICE PRIORITY**: Reduces volume level of background music to make announcement.
- **VOICE ENHANCE**: Use to increase crispness and clarity in vocals.
- **3 LED's** provides battery information.
GREEN – fully charged, **YELLOW / ORANGE**– half level,
RED – low, charge.



Photo may appear different then your actual unit.

SW925 SPECIFICATIONS

Rated Power Output: 250W RMS

Battery: (2) 12 volt rechargeable, 7.2 AH,
User accessible and replaceable

AC Power: 110-220 Auto sensing, 50/60 Hz,

Phantom Power Input: Powers Electret condenser
microphones

Wireless Range: Up to 300 Feet

UHF Wireless Frequency: 584- 608 MHz

Frequency Response: 20Hz to 20Khz

Sensitivity: 127dB

Equalization (tone): Separate Bass and Treble

Line output: Buffered, 600 ohm,
1/4in.jack (pre fader)

Sensitivity for rated output:

Balanced Microphone -58 dBV (1.25 mVrms)
Balanced Line -15 dBV (175 mVrms)
Unbalanced line -20 dBV (100 mVrms)

Unbalanced input: Hi-Z, Neutrik combo - 1/4in.

Balanced Input: Lo-Z, Neutrik combo XLR

Charging Time: Full charge 10 hours

Operating Time: Average 6-10 hours

Weight: 35 lbs.

Dimensions (HWD): 23in.H x 11.5in. W x 11in. D

Warranty: 6 years Electronics;
1 year on Remote,
Microphones, Cassette
Player, CD Player, Digital
Player and Rechargeable
Batteries.

CONTROL / BACK PANEL



OPERATION

POWER SWITCH: When power switch is in the **ON** position, a **BATTERY STATUS LIGHT** will be illuminated. The color of the LIGHT indicates the condition of the battery.

Red – battery low, recharge immediately; Yellow/Orange – battery at 50% should be recharged before use. Green - fully charged.

To charge the batteries, connect the unit to 110-220VAC using the supplied power cord. The yellow/orange **CHARGE** LED will be illuminated indicating battery is charging. The batteries will charge when unit is operating with AC power, **HOWEVER the unit will charge faster with the power switch in the "off" position.**

THE SW925 MUST BE PLUGGED IN AND CHARGING WHEN NOT IN USE TO MAXIMIZE BATTERY LIFE. RE-CHARGING THE UNIT ONLY WHEN THE BATTERY STATUS LIGHT IS ORANGE OR RED WILL SHORTEN THE USEFUL LIFE OF THE BATTERIES.

FUSES: There is a fuse in the AC jack. It is identified on the plastic with a drawing of a fuse.

Detach the AC cord from the unit before replacement

This fuse protects the AC circuitry. Use a flat blade screwdriver in the slot on the top of fuse holder to slide the fuse holder out. Replace the fuse with a 2A/250V fuse if needed.

If after replacing the fuse, the SW925 does not "power on", please call AmpliVox Customer Service at 800-267-5486.

WARNING! RISK OF SHOCK! DO NOT OPEN UNIT NO USER SERVICEABLE PARTS INSIDE!

MEDIA PLAYER

This is not a recorder, only an SD Card or USB Thumb Drive Player.

- ① **ON / OFF:** Rotate clockwise to turn ON and counter clockwise to turn OFF.
- ② **INFORMATION SCREEN**
- ③ **PLAY:** Press once to start playback. Press again to Pause.

STOP: Press once to Stop playback.

NEXT: Press once to go to next song.

PREVIOUS: Press once to go back to previous song.

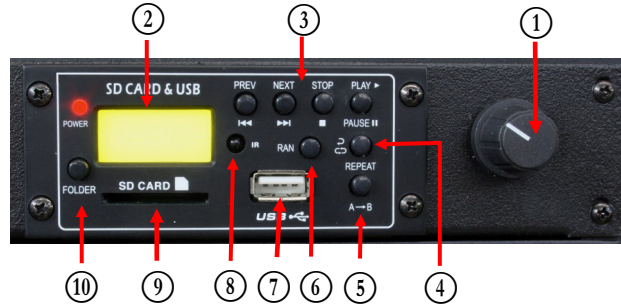

- ④ **REPEAT:** Press once to repeat all tracks. Press twice to repeat current track. Press again to cancel repeat.

- ⑤ **A - B:** To repeat between two points on track, press A for starting point and again at point B. Track will continue to repeat between these two points. Press again to cancel.

- ⑥ **RANDOM:** Press to play tracks in random order. Press again to cancel.
- ⑦ **USB CONNECTOR:** Insert USB Thumb Drive.
- ⑧ **IR:** Remote control window.
- ⑨ **SD CARD SLOT:** Accepts SD Card or MMC Card.
- ⑩ **FOLDER:** Press and then use the NEXT and PREVIOUS buttons to select Folder Number.

REMOTE CONTROL:
For use with only the Media Player.



AUDIO FUNCTIONS

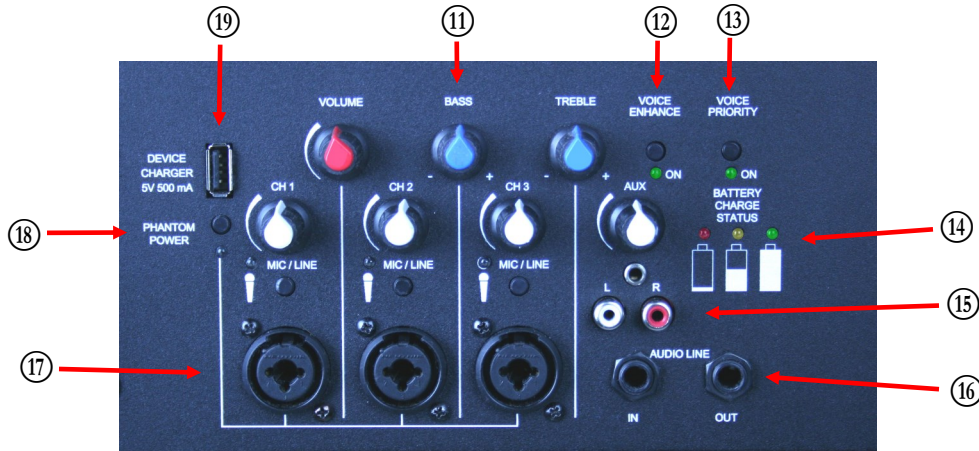

⑪ 3 MASTER AUDIO CONTROLS:

VOLUME: This is the master volume control for the system.

BASS: This control cuts or boosts the bass level.

TREBLE: This control cuts or boosts the treble level.

- ⑫ **VOICE ENHANCE:** Use when you want to increase crispness and clarity in vocals.

- ⑬ **VOICE PRIORITY SWITCH:** When turned "ON" this feature allows a voice message to take precedence over the musical program, without turning the music off completely. Full volume is returned when speaking is complete.

- ⑭ **BATTERY STATUS LED's:** SEE PAGE 4 (OPERATION) FOR CHARGING DETAILS.

- ⑮ **AUX INPUTS:** Add pre-recorded music or audio to your presentations from an external source. Connect using the L/R RCA connector, 3.5 mm connector, or the 1/4" connector. A separate **LINE IN VOLUME CONTROL** is also provided for controlling sound level of the external source.

- ⑯ **LINE OUTPUT:** A 1/4" connector is provided for connecting to other equipment. **LINE OUT** signal is not affected by **AUDIO SETTINGS** selected on the SW925.

It can be used to drive an external recording device or AmpliVox S1297 Powered Speaker. The advantage to this configuration is that the external system's own EQ & volume settings can be separately adjusted to suit its environment and the two systems do not interact with each other.

- ⑰ **WIRED MICROPHONE INPUTS:** Three combination XLR / 1/4" connectors (this jack will accept either type microphone). Each has its own volume control that allows you to adjust sound level of the plugged-in microphone.

Below each volume control is a small button that allows you to switch between Mic Level or Line Level. If you plug in a line level device into mic level the sound will be loud and distorted. A microphone with an XLR connector is typically Mic Level. A microphone with a 1/4" connector is typically Line Level. Press button to select. When the LED lights you have Mic Level. Press again, LED goes out, you have Line Level.

- ⑱ **PHANTOM POWER:** When using a Phantom Microphone press button to activate circuitry on all three channels. You cannot use both Phantom and Dynamic microphones at the same time.

- ⑲ **USB CHARGING:** A 5V, 500mA charging connector has been provided to help maintain your battery in a cell phone, tablet or computer while in use with the PA speaker.

16 CHANNEL UHF WIRELESS

WIRELESS RECEIVER PANEL

- Channel Display (A)
- RF - Radio Frequency Indicator (B)
- AF - Audio Frequency Indicator (C)
- ASC / IR Auto Channel Select (Handheld Only) (D)
- Select Buttons - Manual Channel Selection (E)
- Mute Level Adjustment (F)
- Volume Control (G)

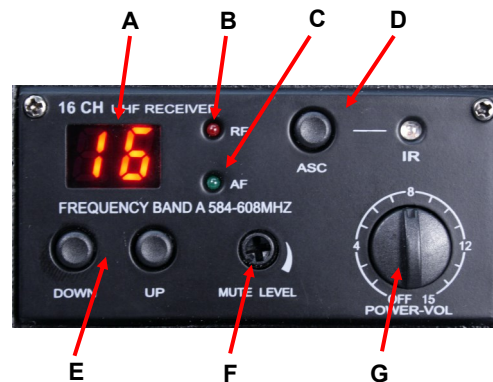

RECEIVER / TRANSMITTER SETUP:

- The receiver has its own **POWER / VOLUME** Control (G). First make sure that you have screwed on the UHF antenna. Turn Power On. A Frequency Channel will appear in the Channel Display (A). Press Select Buttons (E) to select a channel. Channel number must match channel number on wireless transmitter.
- The transmitter bodypack is operated by 1 - "AA" 1.5 Volt alkaline battery. Slide off battery cover (H) and install battery as shown. Make certain the battery is fully seated in its compartment so the cover slides in place easily. Battery life with alkaline batteries is approximately 8 hours of operating time.
- Select a channel (1-16) on side panel (I) using the supplied screw driver to select channel number. Channel selected should match channel on receiver. When transmitter and receiver are set to correct channel the RF indicator (B) will glow red when transmitter is turned on.
- Plug the Lapel / Headset microphone into the Mic Input Jack (K). The microphone can be clipped to a necktie or other clothing, using the supplied clip. The lapel mic should be placed under the chin, as close to the center of the body as possible.
- Slide the power **ON/OFF** switch (J) to the **ON** position (the LED indicator light will illuminate green). Replace batteries when this LED turns red.
- **MUTE LEVEL** (F) is set at half way mark when it leaves the factory. If speaker sound is breaking up, turn level clockwise with small screwdriver until condition improves.
- **GAIN SWITCH** (L): If you are a soft spoken person then set the switch to the **10 dB** position. If you are a loud speaking person then set the switch to the **-10 dB** position. Adjust to prevent distortion while speaking.

Wireless Transmitter - Bodypack



WIRELESS HANDHELD MICROPHONE—MODEL S1695

If you are using the AmpliVox S1695 Wireless Handheld Microphone Transmitter, screw off the lower bottom section of microphone and insert 2 - "AA" 1.5 Volt alkaline batteries.

IMPORTANT: Because the microphone has an **AUTO SYNC** function, you first select channel you wish to use on the receiver. Then press the ASC button (D), the IR light will start to flash. Turn on microphone and point end (6) of microphone at the flashing IR light on receiver and the microphone will auto sync to the same channel as selected on the receiver.

BATTERIES

1. Hold the body of microphone in hand and twist off bottom section of microphone.
2. Insert two "AA" batteries.
3. Twist bottom section back on to microphone.

BATTERY STATUS

The life expectancy of the two batteries is about 10 hours. When the **"BATTERY"** symbol on the display screen keeps flashing the batteries should be replaced immediately.

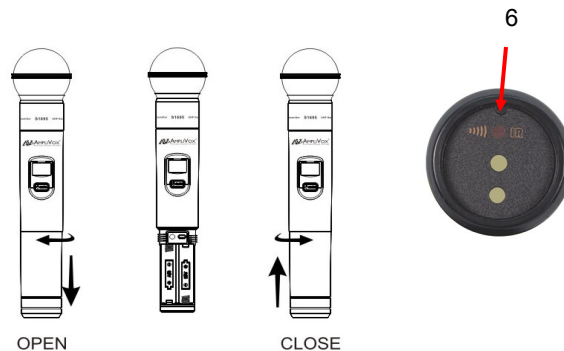

Microphone Operation and Status Display

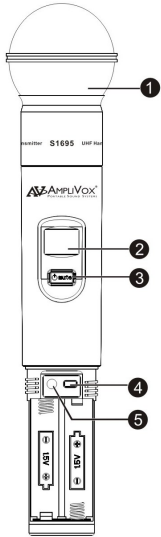

BATTERY COVER REMOVED

Functions

- 1) **Interchangeable Microphone Head**
- 2) **LCD Screen**
- 3) **Power / Mute Control Switch**
- 4) **Select Button**
- 5) **Microphone Input Sensitivity Adjustment**—is used to set the gain of microphone. If you are a soft talking speaker you will need to turn the control counter clockwise. Turn clockwise if you are a loud talker. Use plastic screwdriver that is supplied.



- **TURN ON MICROPHONE:** Press and hold the “POWER/MUTE” (3) button until LCD screen lights up.
- **TO MUTE:** Press “POWER/MUTE” button twice to MUTE. Channel number will flash when muted. Press button again twice to remove “MUTE”.
- **TURN OFF MICROPHONE:** Press and hold the “POWER/MUTE” (3) button for 2 seconds to turn microphone “OFF”.
- **SELECT CHANNEL (Manual):** Press and hold the “SELECT” (4) button for 2 seconds until you only see the word Channel and channel number. To change channel, when flashing, press the “SELECT” (4) button until you reach the desired channel. Flashing will stop after 10 seconds and channel is now set.
- **LOCK / UNLOCK CHANNEL:** Press the “POWER/MUTE” (3) button and “SELECT” button at the same time to lock or unlock channel. When locked, channel cannot be changed. “LOCKED” symbol appears in upper left-hand corner.

BLUETOOTH MODULE

- Turn power switch (24) on, press ► (22) button to turn Bluetooth pairing on and hold for 4 seconds to enter into the pairing mode.
- The **RED LED** (20) will start to flash, searching for a Bluetooth signal. Search function will stay active for 10 minutes. If no signal is found, this function will shut off. During the search function turn on your Bluetooth device for pairing. On your Bluetooth menu of your device, choose AmpliVox, AmpliVox S1500 or use pin code 0000. Once paired, red LED will stay on.
- Use this button ► (21) to move to the next song or ◀ (23) to play previous song. Use ► (22) to pause. When paused you will need to press again to start playing.
- **VOLUME CONTROL** (24) Use to adjust the volume of the Bluetooth material.
- **NOTE:** Always turn off Bluetooth power before turning main power off. If you turn off main power first, you will need to cycle thru a power off/on the next time you use the Bluetooth module.

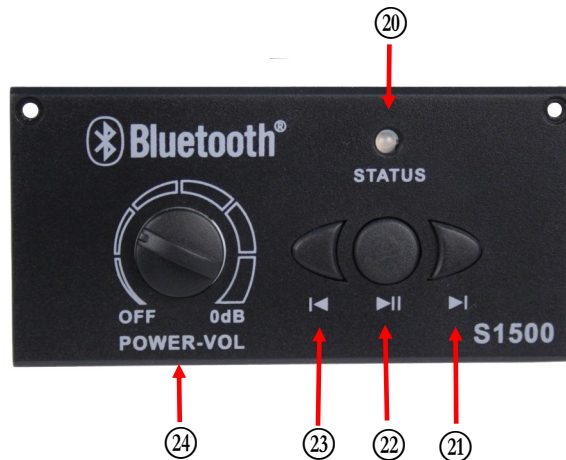

“The Bluetooth® word mark and logos are registered trademarks owned by Bluetooth SIG, Inc. and any use of such marks by AmpliVox Portable Sound Systems is under license. Other trademarks and trade names are those of their respective owners.

WIRELESS SPEAKER TRANSMITTER S1692T (OPTIONAL EQUIPMENT)

OPERATES ON DIFFERENT FREQUENCIES THAN AMPLIVOX WIRELESS MICROPHONE / RECEIVER

16 CH UHF WIRELESS SPEAKER TRANSMITTER

FEATURES

- Channel Display (A) Frequency: 655 - 679 MHz
- TX - Radio Frequency Indicator (B) lights when turned on
- AF - Audio Frequency Indicator (C) lights when transmitting
- Select Buttons - Manual Channel Selection (D) Up / Down
- Power / Volume Control (E)

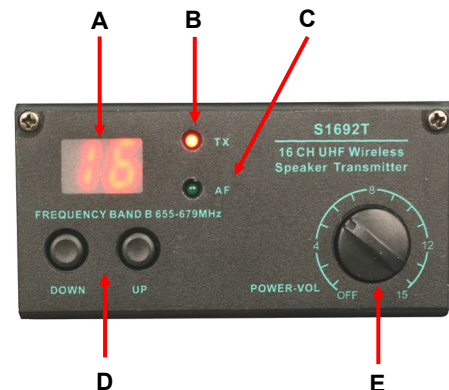

SETUP

- The transmitter has its own **POWER / VOLUME** Control **(E)**. First make sure that you have screwed on the UHF antenna **(Position #4)**. Turn Main Power On of the **SW925**, then turn transmitter Power On **(E)**. A Frequency Channel will appear in the Channel Display **(A)**. Press Select Buttons **(D)** to select a channel. Channel number must match channel number on wireless receiver of the **S1297 Speaker**. **EXAMPLE: Select Channel 10 on transmitter (S1692T) and select Channel 10 on the speaker receiver of the S1297.** The AF LED will light when transmitting signal to receiver of the **S1297**. RF LED of receiver (S1297) will light when channels are matched and receiving a signal.

OPERATE

- **SW925:** turn on main power / wireless microphone receiver / wireless speaker transmitter / wireless microphone.
- **S1297:** turn on main power / wireless speaker receiver.
- To start, set all volume controls of the wireless devices to **Number 6**. Test speaking into the wireless microphone and adjust level of main volume controls first to the desired level. If you feel that you need to increase sound level then adjust levels of the wireless devices.





- **HANDLING THE DISCS:** Always insert a CD, CD-R, CD-RW into player with label side up! Proper handling and care of CDs should be taken to insure proper operation. Fingerprints and dust should be carefully wiped off the surface, starting from the center of the disc and moving out towards the edge. It is best to avoid touching the surface opposite the label to prevent scratching or leaving fingerprints on the surface area. Always remove disc from player before transporting unit.
- **LOADING AND UNLOADING DISCS:** To insert disc, gently insert into disc player slot until engagement mechanism pulls CD into player. Do not force CD into unit. To remove disc press STOP /EJECT button twice and gently remove CD, place CD back into jewel case.
- **NORMAL DISC PLAY:** Insert CD into player and press PLAY/PAUSE button if CD hasn't already begun to play. Disc play will start at first track. Player display will indicate track number and time.
- **REMOTE:** To operate the CD player with the remote control, **the button on the remote labeled CD must be pressed first**, in the same manner as when adjusting the volume for the CD player. Once the CD button is pressed, all buttons will continue to control their respective functions on the CD Player until one of the other input buttons is pressed.

INPUTS

- **USB 2.0 / SD CARD SLOT:** For Flash / Thumb drive memory devices and SD cards containing MP3 files.
- **AUX IN :** Connect other audio devices using a 3.5mm cable.

FUNCTIONS

- **POWER:** Press Power button to turn CD Player on.
- **SD /USB /CD Button** on far left of button row selects between SD, USB and CD playback.
- **FOLDER button** selects which folder in USB or SD storage devices to playback.
- **FB** skips back to the previous folder or selection.
- **FF** skips forward to the next folder or selection.
- **REV** backs up on the current folder or selection.
- **FWD** moves forward on the current folder or selection.
- **PLAY/PAUSE** starts playback of the current folder or selection, and also stops the selection when pressed during playback. When the button is pressed again, playback resumes at the point where the selection was stopped.
- **STOP /EJ** stops the selection from playing. Pressing and holding the button for a couple seconds after the CD has stopped playing will eject the CD disk from the player.
- **Pitch Control** is adjusted by three push buttons next to the volume knob:
 - Press and hold **HI** to speed up playback material over a range.
 - **NOR** adjusts the speed back to normal speed.
 - Press and hold **LO** to slow down playback material over a range.
- **VOLUME** knob increases the output level when turned clockwise, and decrease the volume when turned counter clockwise. This is in addition to the Master volume control function and is a convenience for balancing the output with other sources. Adjust volume for proper listening levels.

ACCESSORIES



Sound transparent mesh

S1995 Outdoor Protective Cover.

Protect your speaker from the elements with the **S1995 Outdoor Protective Cover**. Designed for temporary outdoor use, the S1995 Cover is perfect solution for keeping the PA speaker going no matter what the weather dishes out. This custom-fit cover is made from water-repellant nylon fabric and sound transparent mesh. Rear access panels let you hook up cables, antennas and access controls with ease while keeping your gear dry.

Two large pockets; 12" L x 8" W x 1 1/2" D with a hook and loop fastener flap for microphone and cable storage.

MSRP \$199.00



S2045 - Electret Headset Microphone Upgrade

Cardioid pickup pattern and smooth frequency response helps reduce feedback problems. Lightweight and adjustable behind the head and over the ears design will not interfere with hairstyles. Flexible PVC coated gooseneck microphone boom arm is easily adjustable. (3.5mm/ 1/8" Plug)

MSRP \$226.00

TROUBLESHOOTING GUIDE

PROBLEM & ITEMS TO CHECK

UNIT WILL NOT TURN ON

- Is unit plugged in?
- Are batteries charged?
- Is fuse blown?

UNIT OPERATES ON AC BUT NOT BATTERY

- Check battery terminals.

SOUND IS DISTORTED

- Turn down input source (such as keyboards, etc.) since the output of some devices may be too high.
- Check for debris on speaker cone.

SOUND IS MUFFLED

- Bass too high
- Treble too low

FEEDBACK: A LOUD SQUEALING, SHRILL OR HOWLING SOUND THAT IS SELF GENERATED

- Feedback occurs when a microphone is too close to the speaker or the microphone volume is too high, or the microphone is pointed towards the speaker. It is also caused by sound reflecting off hard surfaces.
- Reduce or eliminate Feedback by
 - Pointing the microphone in a different direction.
 - Keeping the microphone BEHIND the speakers.
 - Turn down the volume levels.

MICROPHONE SIGNAL IS WEAK

- If microphone has batteries, check batteries.
- Turn on phantom power if applicable.
- Check cables/connectors.

POWER IS ON, BUT NO SOUND

- Check volume levels for each channel and main volume.
- If using wireless, be sure receiver(s) and/or transmitter battery is installed and/or is on.
- If using "line insert", loop must be completed.

WIRELESS MIC DOES NOT WORK

- Check transmitter battery is alkaline and ensure transmitter is on.
- Does yellow "signal" LED light when transmitter is turned on?
- Are the transmitter and receiver on the same channel? (1-16)

WIRELESS MIC CUTS IN AND OUT

- Is unit visible (line of sight) from user? If not, move unit into view when using wireless microphone.
- Does the yellow "signal" LED go out when signal drops out? Check battery in transmitter.

SW925 MAKES BUZZING NOISE

- Check cables – a damaged cable will cause this. Unplug cables one at a time until buzzing stops.
- Check for Ground loops – use a ground loop isolator where needed. Will not operate unless plugged into AC).

BATTERIES WILL NOT HOLD CHARGE

- Replace Batteries every 1-2 years if unit is not left charging when not in use.
- A full charge is best obtained when the unit is off and plugged into the AC outlet for several hours. After a year or two the battery may need to be replaced. Batteries are available from Amplivox.
- To replace the batteries use a Phillips screwdriver and take out the 4 screws from the battery cover on the control panel. Remove the foam spacer, set aside. Pull out the batteries to access the terminals.
- Carefully hold the battery with one hand while you remove the mating connector. Replace with new battery and push mating connector of battery wire onto the corresponding color/polarity. RED = POSITIVE, BLACK = NEGATIVE.
- Place the batteries back in the compartment. Replace the foam and screw in the cover.

NEED HELP? Call 800-267-5486

DISCLAIMER

AmpliVox Portable Sound Systems, operates a policy of continuous development. AmpliVox reserves the right to make changes and improvements to any of the products described in this document without prior notice.

Under no circumstances shall AmpliVox be responsible for any loss of data or income or any special, incidental, consequential or indirect damages howsoever caused.

In some countries there may be some restrictions in using this equipment. Please check with your local radio frequency authorities.

WARRANTY

Limited Six (6) -Year Warranty

AmpliVox warrants this product to be free from defects in materials and workmanship (subject to the terms set forth below) for a period of six (6) years from the date of purchase ("Warranty Period"). **All accessories and the batteries are warrantee for 1 year.** Accessories are; wireless and wired microphones, receivers and transmitters, CD players, cassette players, and digital players.

During the Warranty Period, AmpliVox will repair or replace (at AmpliVox's discretion) this product or any defective parts ("Warranty Service").

Repair or replacement under the terms of this warranty does not give right to any extension or a new beginning of the period of warranty.

CLAIMS UNDER THE WARRANTY

To obtain Warranty Service, **contact AmpliVox (800-267-5486)** to be assigned a **Return Authorization number (RA#)**. After receiving a RA#, the defective unit is to be returned to AmpliVox in either its original packaging or packaging affording an equal degree of protection. You will bear the cost of shipping the product to AmpliVox. If the product is covered by the warranty, AmpliVox will bear the cost of shipping product back to you after the completion of service under this warranty.

Return shipping will be charged to you for products not covered by the warranty or requiring no warranty repair.

The following information must be presented to obtain Warranty Service: **(a)** the RA# must be clearly and legibly marked on the outside of shipping carton, **(b)** proof of purchase, which clearly indicates the name and address of the seller, the date of purchase and the product type, which is evidence that this product is within the Warranty Period. Please further include **(c)** your return address, **(d)** daytime telephone number, and **(e)** reason for return.

LIMITATION OF WARRANTY

This warranty is only valid for the original purchaser and will automatically terminate prior to expiration if this product is sold or otherwise transferred to another party. The warranty provided by AmpliVox in this statement applies only to products purchased for use, and not for resale. It does not apply to open box purchases, which are sold "as is" and without any warranty. Specifically exempt from warranty are limited-life consumable components subject to normal wear and tear, such as microphone windscreens, ear cushions, modular plugs, ear tips, decorative finishes, batteries, and other accessories. This warranty is invalid if the factory-applied serial number, date code label, or product label has been altered or removed from this product. This Warranty does not cover cosmetic damage or damage due to misuse, abuse, negligence, Acts of Nature, accident, disassembling or modification of, or to any part of, the product. This Warranty does not cover damage due to improper operation, maintenance or installation, or attempted repair by anyone other than AmpliVox. Any unauthorized repairs will void this warranty.

REPAIRS OR REPLACEMENTS AS PROVIDED UNDER THIS WARRANTY ARE THE EXCLUSIVE REMEDY OF THE CONSUMER. AMPLIVOX SHALL NOT BE LIABLE FOR ANY INCIDENTAL OR CONSEQUENTIAL DAMAGES FOR BREACH OF ANY EXPRESS OR IMPLIED WARRANTY ON THIS PRODUCT. EXCEPT TO THE EXTENT PROHIBITED BY LAW, THIS WARRANTY IS EXCLUSIVE AND IN LIEU OF ALL OTHER EXPRESS AND IMPLIED WARRANTIES WHAT SO EVER, INCLUDING BUT NOT LIMITED TO THE WARRANTY OF MERCHANTABILITY AND FITNESS FOR A PRACTICAL PURPOSE.

NOTE! This warranty gives you specific legal rights. You may have other rights which vary from location to location. Some jurisdictions do not allow the exclusion or limitation of incidental or consequential damages or implied warranties, so the above exclusions may not apply to you. This warranty does not affect your legal (statutory) rights under your applicable national or local laws.



Dispose of the product according to local standards and regulations

AmpliVox • 650 Anthony Trail Suite D, Northbrook, IL 60062 • Phone: (800)267-5486 • Fax: (800)267-5489 www.ampli.com

