

---

# INSTALLATION INSTRUCTIONS

---

## CABLE MANAGEMENT CAP

### CMA-275

The CMA-275 cable management cap is an esthetically pleasing protection for exposed wiring. The cable management cap will fit a pipe with an outside diameter of 2 to 2 ¾ inches.

**WARNING: IMPROPER INSTALLATION MAY RESULT IN SERIOUS PERSONAL INJURY!**

When mounting Chief Manufacturing accessories, the structural system and mounting method **MUST** be capable of supporting 5 times the combined weight of the total installation.

Unpack and check contents:

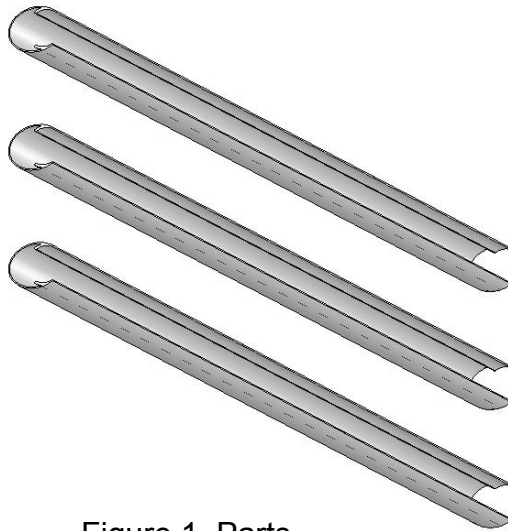

Figure 1. Parts

(3) CAP, Cable Management, 4' Length

1. Route wiring along side of pipe or pole.
2. Using a tin snips, or appropriate cutting tool, trim cable management cap to desired length as necessary.
3. Install cable management cap over wiring, snapping it onto pipe.
4. Secure wiring at each end of cable management cap using tie wrap, electrical tape, or other suitable fastener.



**CHIEF MANUFACTURING INC.**  
1-800-582-6480 952-894-6280 FAX 952-894-6918  
12800 HIGHWAY 13 SOUTH, SUITE 500  
SAVAGE, MINNESOTA 55378 USA

8803-000042  
2004 Chief Manufacturing  
[www.chiefmfg.com](http://www.chiefmfg.com)  
03/04