

---

# INSTALLATION INSTRUCTIONS

---

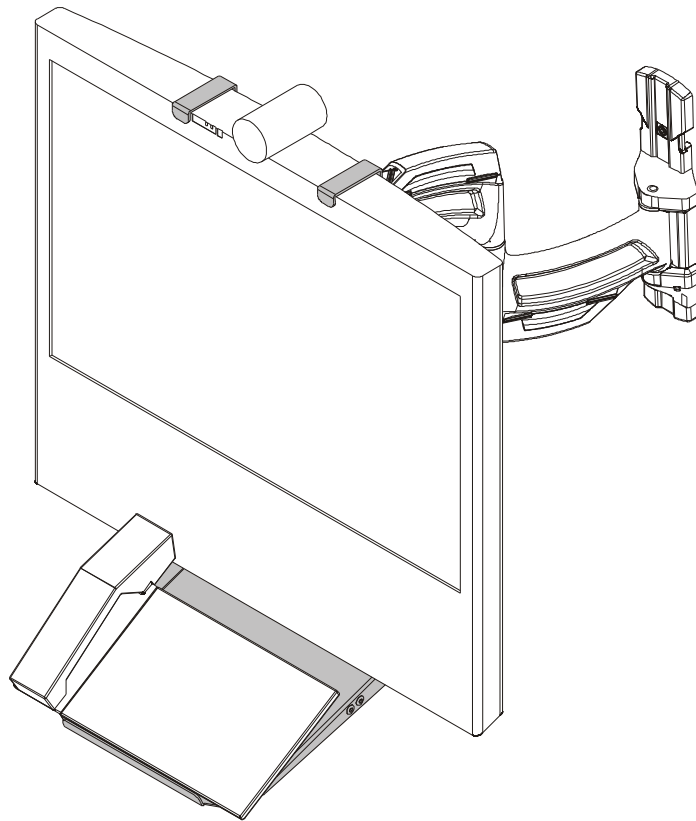

---

## Interface Bracket and Shelf Assembly

---

## DISCLAIMER

Milestone AV Technologies and its affiliated corporations and subsidiaries (collectively "Milestone"), intend to make this manual accurate and complete. However, Milestone makes no claim that the information contained herein covers all details, conditions or variations, nor does it provide for every possible contingency in connection with the installation or use of this product. The information contained in this document is subject to change without notice or obligation of any kind. Milestone makes no representation of warranty, expressed or implied, regarding the information contained herein. Milestone assumes no responsibility for accuracy, completeness or sufficiency of the information contained in this document.

Chief® is a registered trademark of Milestone AV Technologies. All rights reserved.



**WARNING:** Use this mounting system only for its intended use as described in these instructions. Do not use attachments not recommended by the manufacturer.



**WARNING:** Never operate this mounting system if it is damaged. Return the mounting system to a service center for examination and repair.



**WARNING:** Do not use this product outdoors.

**IMPORTANT ! :** The JSB2090 interface brackets are designed to be mounted to an already installed Chief TS218 swing arm.



## IMPORTANT SAFETY INSTRUCTIONS



**WARNING:** A WARNING alerts you to the possibility of serious injury or death if you do not follow the instructions.



**CAUTION:** A CAUTION alerts you to the possibility of damage or destruction of equipment if you do not follow the corresponding instructions.



**WARNING:** Failure to read, thoroughly understand, and follow all instructions can result in serious personal injury, damage to equipment, or voiding of factory warranty! It is the installer's responsibility to make sure all components are properly assembled and installed using the instructions provided.



**WARNING:** Failure to provide adequate structural strength for this component can result in serious personal injury or damage to equipment! It is the installer's responsibility to make sure the structure to which this component is attached can support five times the combined weight of all equipment. Reinforce the structure as required before installing the component.



**WARNING:** Exceeding the weight capacity can result in serious personal injury or damage to equipment! It is the installer's responsibility to make sure the combined weight of all components located between the JSB2090 up to (and including) the display does not exceed 35 lbs (15.9 kg).

**--SAVE THESE INSTRUCTIONS--**

# DIMENSIONS

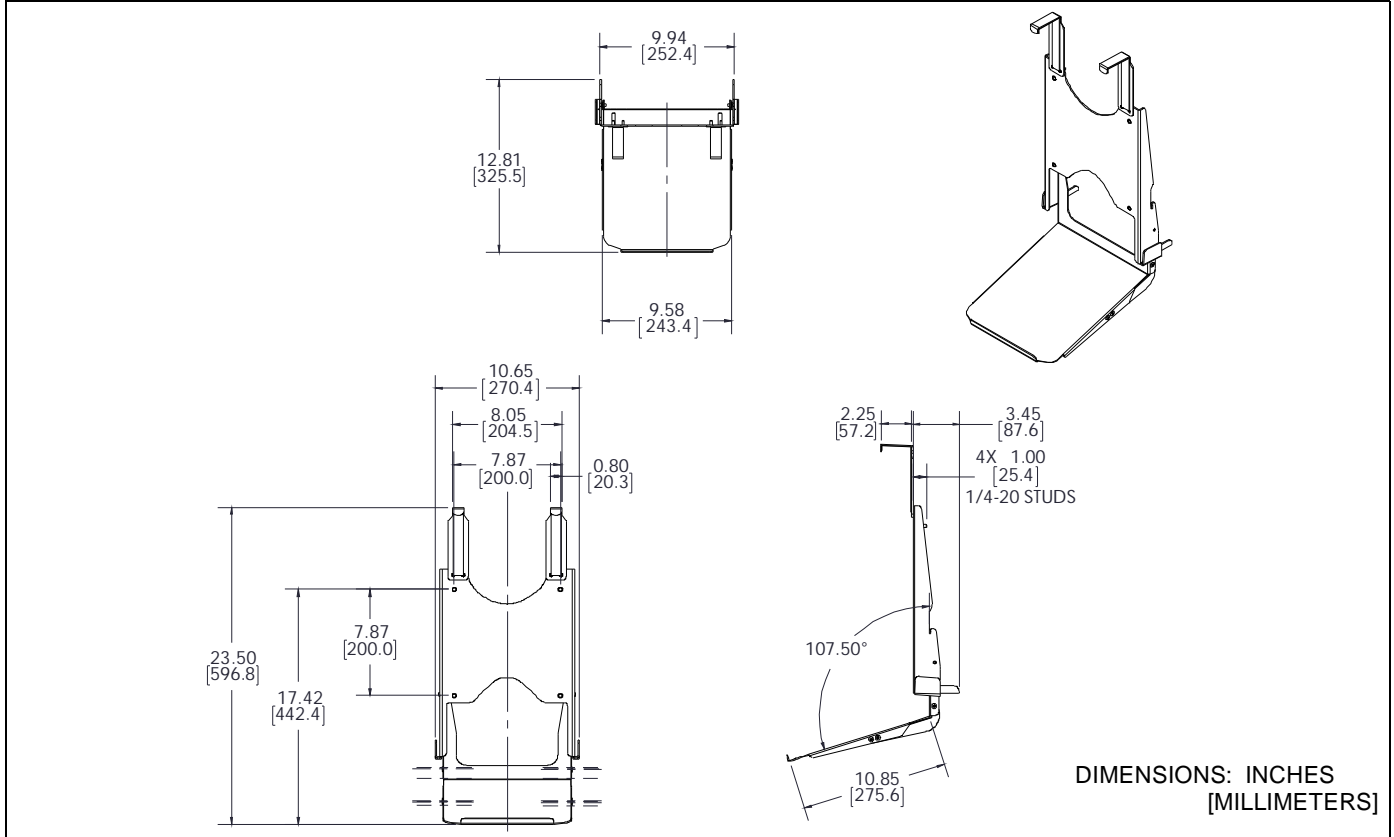

# LEGEND

	<b>Tighten Fastener</b> Apretar elemento de fijación Befestigungsteil festziehen Apertar fixador Serrare il fissaggio Bevestiging vastdraaien Serrez les fixations		<b>Open-Ended Wrench</b> Llave de boca Gabelschlüssel Chave de bocas Chiave a punte aperte Steeksleutel Clé à fourche
	<b>Loosen Fastener</b> Aflojar elemento de fijación Befestigungsteil lösen Desapertar fixador Allentare il fissaggio Bevestiging losdraaien Desserrez les fixations		<b>Hex-Head Wrench</b> Llave de cabeza hexagonal Sechskantschlüssel Chave de cabeça sextavada Chiave esagonale Zeskantsleutel Clé à tête hexagonale

TOOLS REQUIRED FOR INSTALLATION

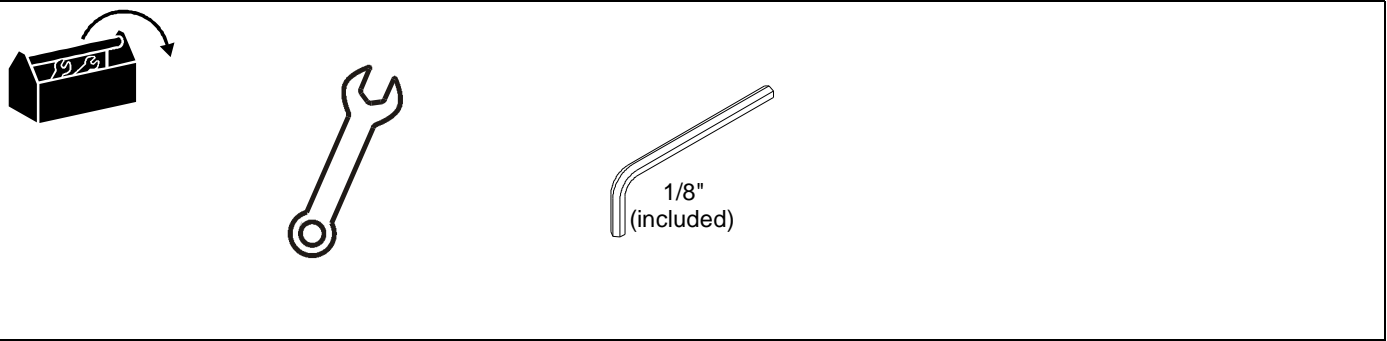

PARTS

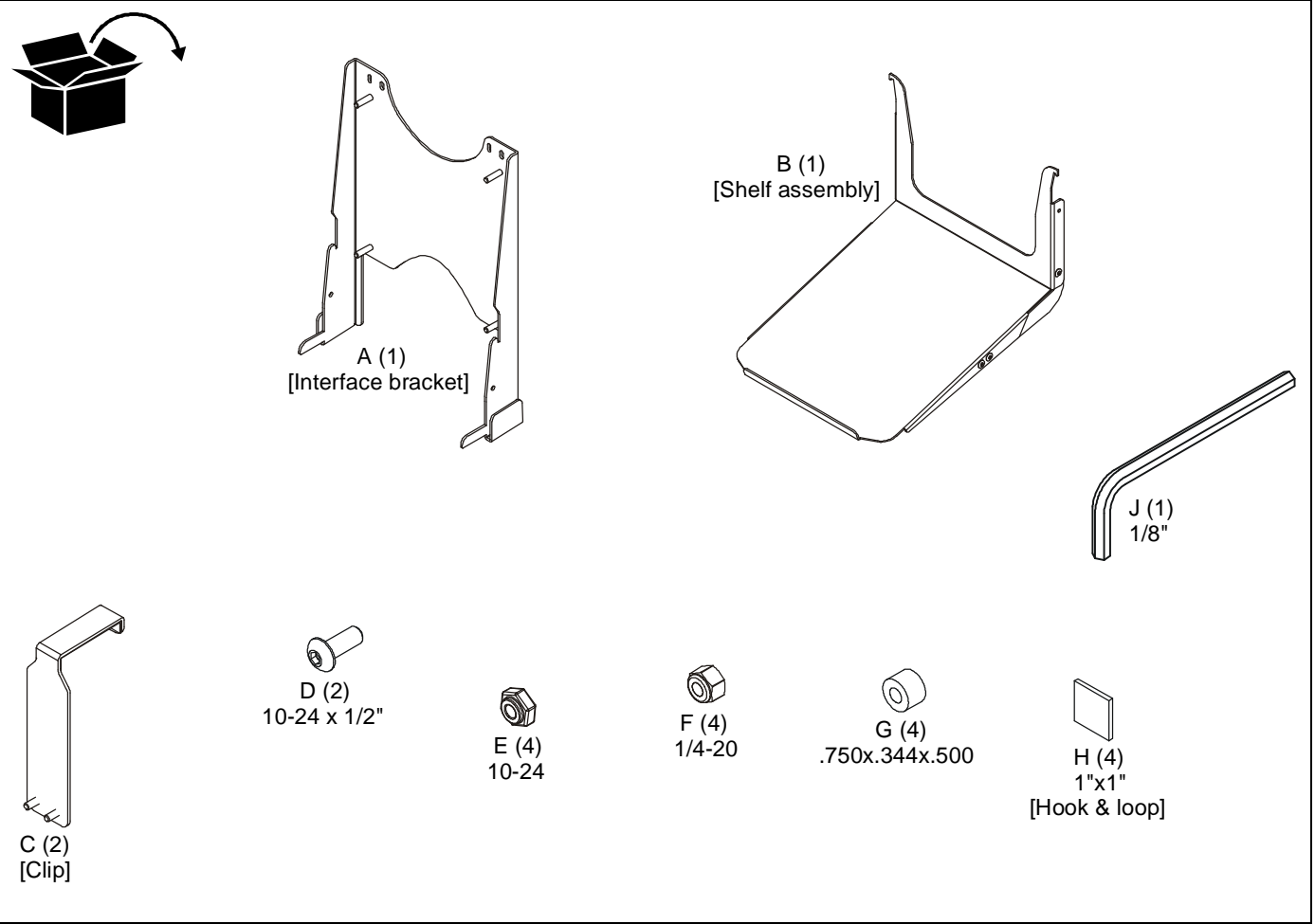

## ASSEMBLY AND INSTALLATION

**NOTE:** The following procedure assumes that a Chief TS218 swing arm mount (not included) has already been installed following instructions included with the mount.

1. Hook two clips (C) over top of display, with long edge of clip on back of display. (See Figure 1)

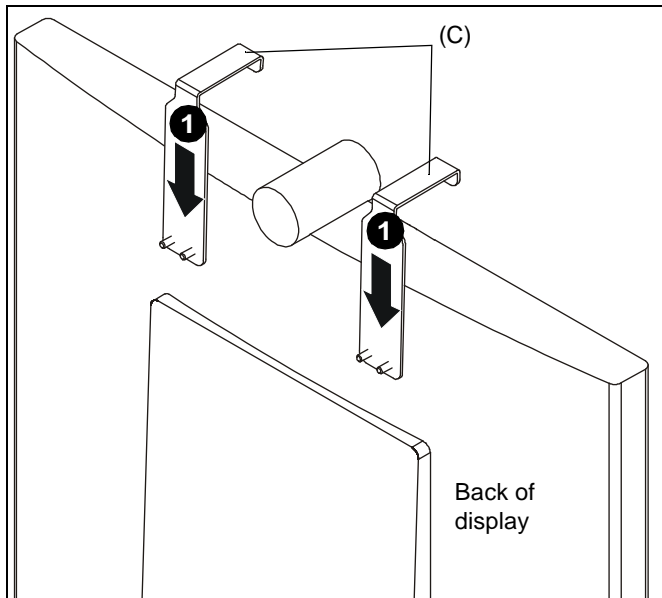

Figure 1

2. Slide interface bracket (A) up from bottom along back of display, ensuring that bottom of interface bracket hooks over square extension on back of display. (See Figure 2)
3. Hang interface bracket onto studs at bottom of clips (C). (See Figure 2)

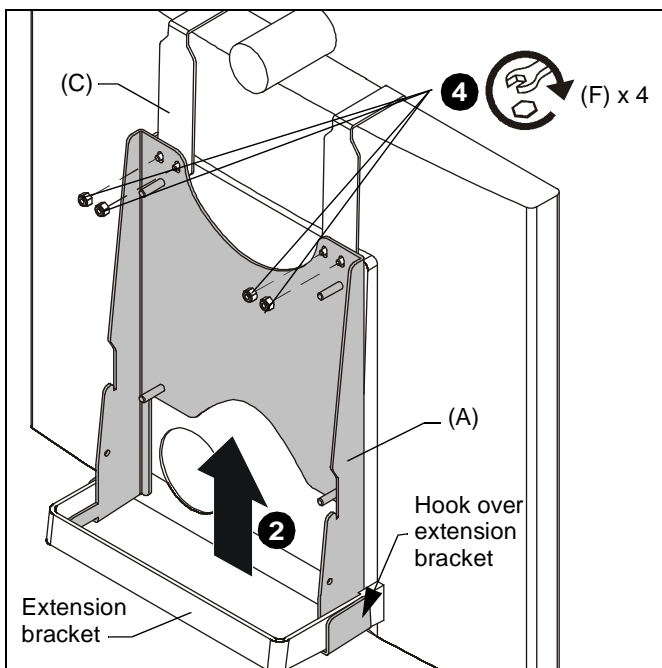

Figure 2

4. Fasten interface bracket to clips using four 1/4-20 locknuts (F). (See Figure 2)
5. Attach display to swing arm by lining up and inserting four studs on interface bracket (A) into holes in swing arm. (See Figure 3)

**IMPORTANT !** : If attaching to the Chief TS318 swing arm, use four .750x.344x.500 spacers (G) on the mount studs before attaching the mount to the swing arm face.

6. Fasten display to swing arm using four 10-24 locknuts (E). (See Figure 3)

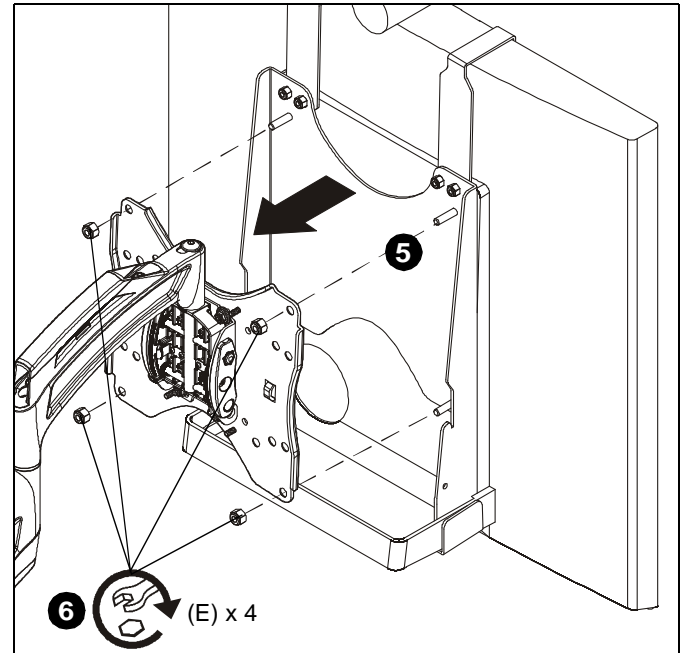

Figure 3

7. Lift shelf assembly (B) up from below display and hook onto interface bracket (A). (See Figure 4)

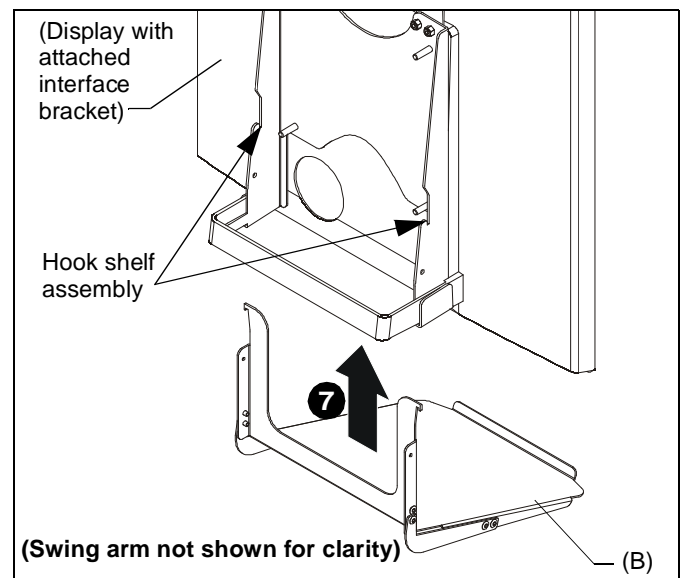
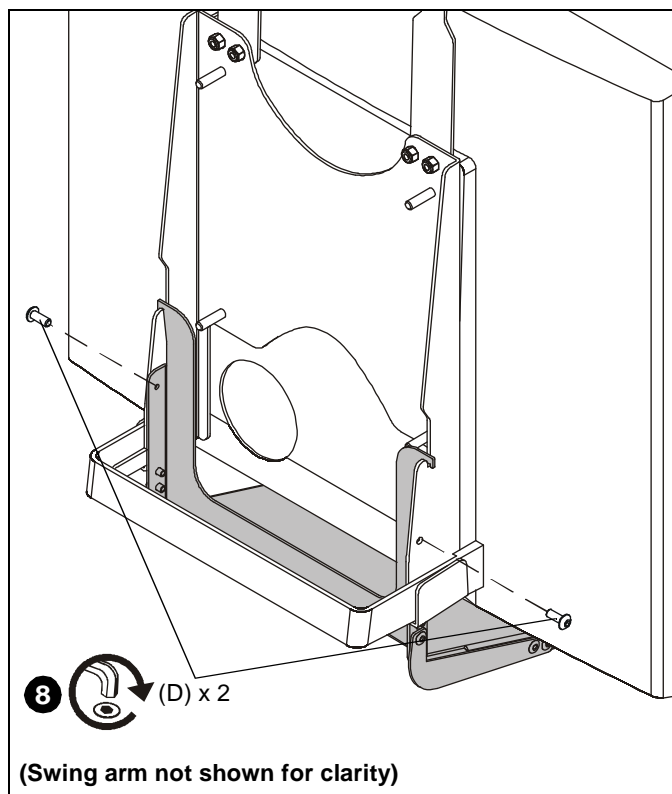

Figure 4

8. Fasten shelf assembly to interface bracket using two 10-24 x 1/2" buttonhead screws (D). (See Figure 5)



**Figure 5**

9. Put hook and loop (H) squares together so there are 2 squares.
10. Remove paper from one side of both of the squares.
11. Attach hook and loop squares to top of shelf assembly (B). (See Figure 6)

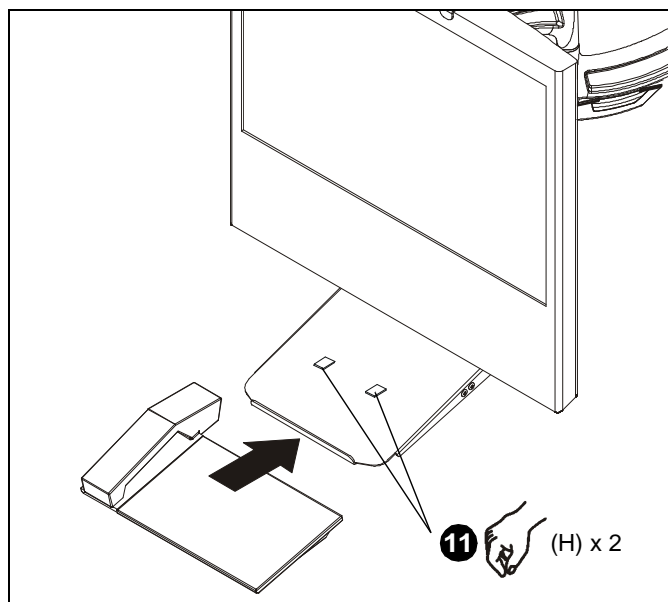

**Figure 6**

12. Remove paper from hook and loop squares and place remote phone on shelf assembly, pressing it against the hook and loop squares. (See Figure 7)

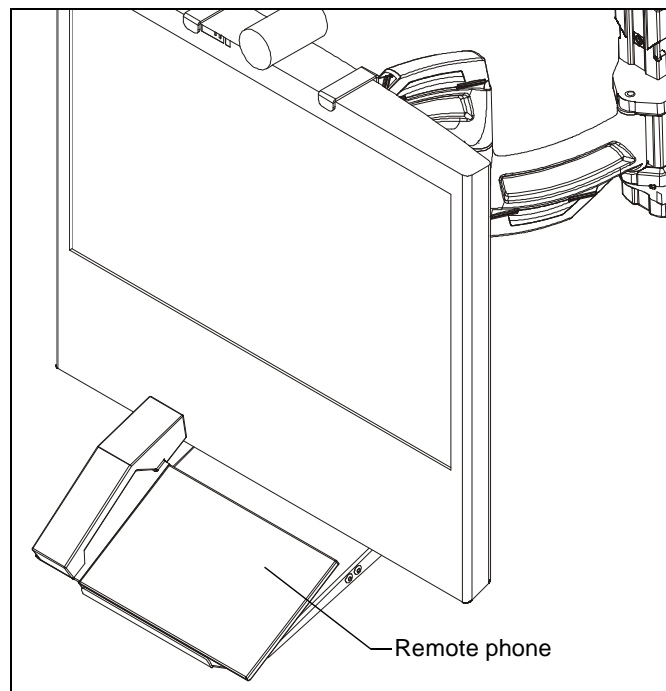

**Figure 7**





Our Mounts. **Your Vision.**

Chief Manufacturing, a products division  
of Milestone AV Technologies

8800-002280 Rev00

©2012 Milestone AV Technologies, a

Duchossois Group Company

[www.chiefmfg.com](http://www.chiefmfg.com)

10/12

<b>USA/International</b>	<b>A</b> 6436 City West Parkway, Eden Prairie, MN 55344 <b>P</b> 800.582.6480 / 952.225.6000 <b>F</b> 877.894.6918 / 952.894.6918
<b>Europe</b>	<b>A</b> Franklinstraat 14, 6003 DK Weert, Netherlands <b>P</b> +31 (0) 495 580 852 <b>F</b> +31 (0) 495 580 845
<b>Asia Pacific</b>	<b>A</b> Office No. 1 on 12/F, Shatin Galleria 18-24 Shan Mei Street Fotan, Shatin, Hong Kong <b>P</b> 852 2145 4099 <b>F</b> 852 2145 4477

