

# PLATINUM SEVEN™

user manual

©2016 **ELATION PROFESSIONAL** all rights reserved. Information, specifications, diagrams, images, and instructions herein are subject to change without notice. ELATION PROFESSIONAL logo and identifying product names and numbers herein are trademarks of ELATION PROFESSIONAL. Copyright protection claimed includes all forms and matters of copyrightable materials and information now allowed by statutory or judicial law or hereinafter granted. Product names used in this document may be trademarks or registered trademarks of their respective companies and are hereby acknowledged. All non-ELATION brands and product names are trademarks or registered trademarks of their respective companies.

**ELATION PROFESSIONAL** and all affiliated companies hereby disclaim any and all liabilities for property, equipment, building, and electrical damages, injuries to any persons, and direct or indirect economic loss associated with the use or reliance of any information contained within this document, and/or as a result of the improper, unsafe, insufficient and negligent assembly, installation, rigging, and operation of this product.

**Elation Professional USA** | 6122 S. Eastern Ave. | Los Angeles, CA. 90040

323-582-3322 | 323-832-9142 fax | [www.elationlighting.com](http://www.elationlighting.com) | [info@elationlighting.com](mailto:info@elationlighting.com)

**Elation Professional B.V.** | Junostraat 2 | 6468 EW Kerkrade, The Netherlands

+31 45 546 85 66 | +31 45 546 85 96 fax | [www.elationlighting.eu](http://www.elationlighting.eu) | [info@elationlighting.eu](mailto:info@elationlighting.eu)

## DOCUMENT VERSION

Please check [www.elationlighting.com](http://www.elationlighting.com) for the latest revision/update of this manual.

| Date     | Document Version | Software Version $\geq$ | DMX Channel Modes | Notes  |
|----------|------------------|-------------------------|-------------------|--|
| 08/03/16 | 1                | 1.1.3                   | 24 / 31 / 40      | Added Silent Mode function description, max number units that can be power linked, and Fan Error code. |
| 08/22/16 | 1.2              | 1.1.3                   | NO Change         | Added WHITE BALANCE details on page 21.  |
| 11/16/16 | 1.4              | 1.1.4                   | NO Change         | Added sACN support.  |
| 04/25/17 | 1.6              | 1.1.5                   | NO Change         | Added 088 Reset Default Password, which erases White Balance when entered.                             |

## CONTENTS

|                                    |    |
|------------------------------------|----|
| General Information                | 4  |
| Warranty                           | 6  |
| Safety Instructions and Guidelines | 7  |
| Overview                           | 9  |
| Installation                       | 10 |
| System Menu                        | 14 |
| DMX Channel Functions And Values   | 23 |
| LED Groups                         | 28 |
| Error Codes                        | 29 |
| Cleaning and Maintenance           | 31 |
| Technical Specifications           | 32 |
| Optional Accessories               | 35 |

## GENERAL INFORMATION

### INTRODUCTION

Congratulations, you have just purchased one of the most innovative and reliable lighting fixtures on the market today! This fixture has been designed to perform reliably for years when the guidelines in this booklet are followed. Please read and understand the instructions in this manual carefully and thoroughly before attempting to operate this unit. These instructions contain important information regarding safety during use and maintenance.

### UNPACKING

Every fixture has been thoroughly tested and has been shipped in perfect operating condition. Carefully check the shipping carton for damage that may have occurred during shipping. If the carton appears to be damaged, carefully inspect your unit for damage and be sure all accessories necessary to operate the unit have arrived intact. In the event damage has been found or parts are missing, please contact our customer support team for further instructions. Please do not return this unit to your dealer without first contacting customer support at the number listed below. Please do not discard the shipping carton in the trash. Please recycle whenever possible.

### BOX CONTENTS

- (2) Omega Brackets
- (1) 5pin DMX Cable
- (1) powerCON TRUE1 Cable
- (1) Safety Cable

## CUSTOMER SUPPORT

Elation Professional® provides a customer support line, to provide set up help and to answer any question should you encounter problems during your set up or initial operation. You may also visit us on the web at [www.elationlighting.com](http://www.elationlighting.com) for any comments or suggestions. For service related issue please contact Elation Professional®.

### **ELATION SERVICE USA - Monday - Friday 8:00am to 5:00pm PST**

**Voice: 323-582-3322**

**Fax: 323-832-9142**

E-mail: [support@elationlighting.com](mailto:support@elationlighting.com)

### **ELATION SERVICE EUROPE - Monday - Friday 08:30 to 17:00 CET**

**Voice: +31 45 546 85 30**

**Fax: +31 45 546 85 96**

E-mail: [support@elationlighting.eu](mailto:support@elationlighting.eu)

## WARRANTY REGISTRATION

Please complete and mail in the enclosed warranty card or register online: <http://www.elationlighting.com/Login.aspx> to validate your purchase. All returned service items whether under warranty or not, must be freight pre-paid and accompany a return authorization (R.A.) number. The R.A. number must be clearly written on the outside of the return package. A brief description of the problem as well as the R.A. number must also be written down on a piece of paper and included in the shipping container. If the unit is under warranty, you must provide a copy of your proof of purchase invoice. Items returned without a R.A. number clearly marked on the outside of the package will be refused and returned at customer's expense. You may obtain a R.A. number by contacting customer support.



## **IMPORTANT NOTICE!**

**There are no user serviceable parts inside this unit. Do not attempt any repairs yourself; doing so will void your manufactures warranty. Damages resulting from modifications to this fixture and/or the disregard of safety and general user instructions found in this user manual void the manufactures warranty and are not subject to any warranty claims and/or repairs.**

## LIMITED WARRANTY

A. Elation Professional® hereby warrants, to the original purchaser, Elation Professional® products to be free of manufacturing defects in material and workmanship for a period of two years (730 days), and Elation Professional® product rechargeable batteries to be free of manufacturing defects in material and workmanship for a period of six months (180 days), from the original date of purchase. This warranty excludes discharge lamps and all product accessories. This warranty shall be valid only if the product is purchased within the United States of America, including possessions and territories. It is the owner's responsibility to establish the date and place of purchase by acceptable evidence, at the time service is sought.

B. For warranty service, send the product only to the Elation Professional® factory. All shipping charges must be pre-paid. If the requested repairs or service (including parts replacement) are within the terms of this warranty, Elation Professional® will pay return shipping charges only to a designated point within the United States. If any product is sent, it must be shipped in its original package and packaging material. No accessories should be shipped with the product. If any accessories are shipped with the product, Elation Professional® shall have no liability what so ever for loss and/or or damage to any such accessories, nor for the safe return thereof.

C. This warranty is void if the product serial number and/or labels are altered or removed; if the product is modified in any manner which Elation Professional® concludes, after inspection, affects the reliability of the product; if the product has been repaired or serviced by anyone other than the Elation Professional® factory unless prior written authorization was issued to purchaser by Elation Professional®; if the product is damaged because not properly maintained as set forth in the product instructions, guidelines and/or user manual.

D. This is not a service contract, and this warranty does not include any maintenance, cleaning or periodic check-up. During the periods as specified above, Elation Professional® will replace defective parts at its expense, and will absorb all expenses for warranty service and repair labor by reason of defects in material or workmanship. The sole responsibility of Elation Professional® under this warranty shall be limited to the repair of the product, or replacement thereof, including parts, at the sole discretion of Elation Professional®. All products covered by this warranty were manufactured after January 1, 1990, and bare identifying marks to that effect.

E. Elation Professional® reserves the right to make changes in design and/or performance improvements upon its products without any obligation to include these changes in any products theretofore manufactured.

F. No warranty, whether expressed or implied, is given or made with respect to any accessory supplied with the products described above. Except to the extent prohibited by applicable law, all implied warranties made by Elation Professional® in connection with this product, including warranties of merchantability or fitness, are limited in duration to the warranty periods set forth above. And no warranties, whether expressed or implied, including warranties of merchantability or fitness, shall apply to this product after said periods have expired. The consumer's and/or dealer's sole remedy shall be such repair or replacement as is expressly provided above; and under no circumstances shall Elation Professional® be liable for any loss and/or damage, direct and/or consequential, arising out of the use of, and/or the inability to use, this product.

G. This warranty is the only written warranty applicable to Elation Professional® products and supersedes all prior warranties and written descriptions of warranty terms and conditions heretofore published.

## SAFETY INSTRUCTIONS AND GUIDELINES

This fixture is an extremely sophisticated piece of electronic equipment. To guarantee a smooth operation, it is important to follow all instructions and guidelines in this manual. The manufacturer of this device is not responsible for injury and/or damages resulting from the misuse of this fixture due to the disregard of the information printed in this manual. Only qualified and/or certified personnel should perform installation of this fixture and only the original rigging parts (omega brackets) included with this fixture should be used for installation. Any modifications to the fixture and/or the mounting hardware included will void the original manufacturer's warranty and increase the risk of damage and/or personal injury.



**PROTECTION CLASS 1 - FIXTURE MUST BE PROPERLY GROUNDED**

**DO NOT PLUG FIXTURE INTO A DIMMER PACK!**



**NEVER OPEN THIS FIXTURE WHILE IN USE!**

**UNPLUG POWER BEFORE SERVICING FIXTURE!**

**NEVER TOUCH FIXTURE DURING OPERATION, AS IT MAY BE HOT!**

**KEEP FLAMMABLE MATERIALS AWAY FROM FIXTURE!**



**INDOOR / DRY LOCATIONS USE ONLY!**

**DO NOT EXPOSE FIXTURE TO RAIN AND MOISTURE!**



**NEVER LOOK DIRECTLY INTO THE LIGHT SOURCE!**

**RETINA INJURY RISK - MAY INDUCE BLINDNESS!**

**SENSITIVE PERSONS MAY SUFFER AN EPILEPTIC SHOCK!**

## SAFETY INSTRUCTIONS AND GUIDELINES

- **DO NOT TOUCH** the fixture housing during operation. Turn OFF the power and allow approximately 15 minutes for the fixture to cool down before serving.
- **DO NOT** shake fixture, avoid brute force when installing and/or operating fixture.
- **DO NOT** operate fixture if the power cord has become frayed, crimped and/or damaged. If the power cord is damaged, replace it immediately with a new one of similar power rating.
- **DO NOT** block any air ventilation slots. All fan and air inlets must remain clean and never blocked. Allow approx. 6" (15cm) between fixture and other devices or a wall for proper cooling.
- When installing fixture in a suspended environment, always use mounting hardware that is no less than M10 x 25 mm, and always install fixture with an appropriately rated safety cable.
- Always disconnect fixture from main power source before performing any type of service and/or cleaning procedure. Only handle the power cord by the plug end, never pull out the plug by tugging the wire portion of the cord.
- During the initial operation of this fixture, a light smoke or smell may emit from the interior of the fixture. This is a normal process and is caused by excess paint in the interior of the casing burning off from the heat associated with the lamp and will decrease gradually over time.
- Consistent operational breaks will ensure the fixture will function properly for many years to come.
- Use the original packaging and materials to transport the fixture in for service.



# OVERVIEW

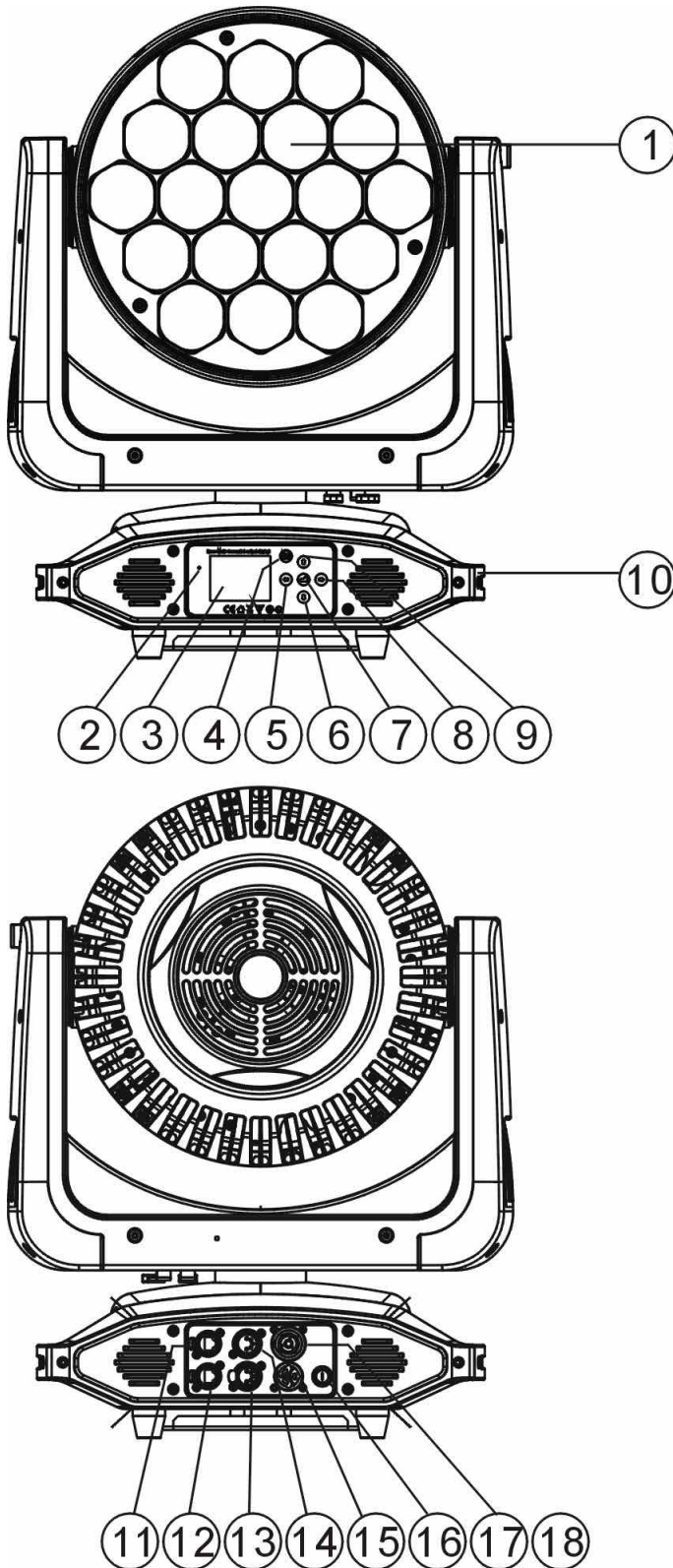

1. LED Lens Array
2. Control Panel
3. LCD Menu Function Display
4. MODE/ESC Button
5. LEFT Button
6. DOWN Button
7. ENTER Button
8. RIGHT Button
9. UP Button
10. Carrying Handle(s)
11. RJ45 Ethernet Input
12. RJ45 Ethernet Output
13. 5pin DMX Output
14. 5pin DMX Input
15. powerCON TRUE1 Input
16. Fuse
17. powerCON TRUE1 Output

## INSTALLATION



### **FLAMMABLE MATERIAL WARNING**

Keep fixture at least 5.0 feet (1.5m) away from any flammable materials, decorations, pyrotechnics, etc.



### **ELECTRICAL CONNECTIONS**

A qualified electrician should be used for all electrical connections and/or installations.

## CAUTIONS

- For added protection, mount the fixture in areas outside walking paths, seating areas, or in areas where unauthorized personnel might reach the fixture.
- Ambient operating temperature range for this fixture is **14° to 113°F. (-10° to 45°C)**. Do not use the fixture under or above this temperature.
- Before mounting the fixture to any surface, make sure the installation area can hold a minimum point load of 10 times the weight of the fixture.
- Fixture installation must always be secured with a secondary safety attachment, such as an appropriate safety cable.
- Never stand directly below the device when mounting, removing or servicing.

## CLAMP INSTALLATION

The fixture provides a unique mounting bracket assembly that integrates the bottom of the base, the included **Omega Brackets (x2)** and **Safety Cable** point in one unit. (See illustration below) When mounting fixture to truss, be sure to secure appropriately rated professional grade rigging clamps to the included **Omega Brackets** using a M10 screw fitted through the center hole of the **Omega Bracket**. The fixture provides a built-in rigging point for a **Safety Cable** on the mounting bracket assembly as illustrated below. Be sure to only use the designated rigging point for the safety cable and never secure a safety cable to a carrying handle.

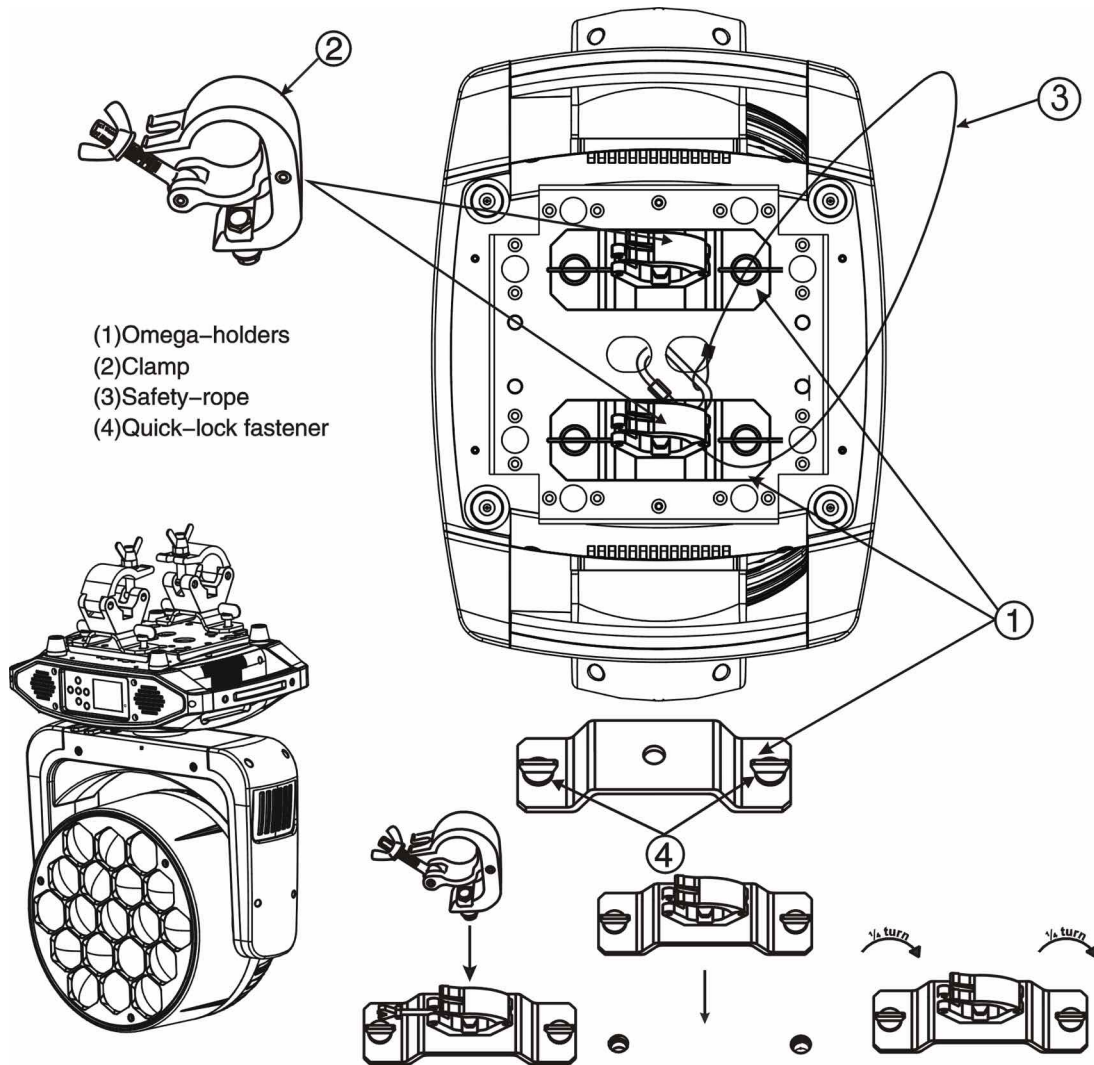

## OMEGA BRACKET INSTALLATION

Insert each Omega Bracket into the matching holes on the bottom of the fixture. Secure each Omega Bracket to the fixture by turning each quick-lock fastener  $\frac{1}{4}$  turn clockwise; making sure the fastener is completely locked.

## RIGGING

Overhead rigging requires extensive experience, including amongst others calculating working load limits, installation material being used, and periodic safety inspection of all installation material and the fixture. If you lack these qualifications, do not attempt the installation yourself. Improper installation can result in bodily injury. Fixture is fully operational in the specific mounting positions illustrated below.

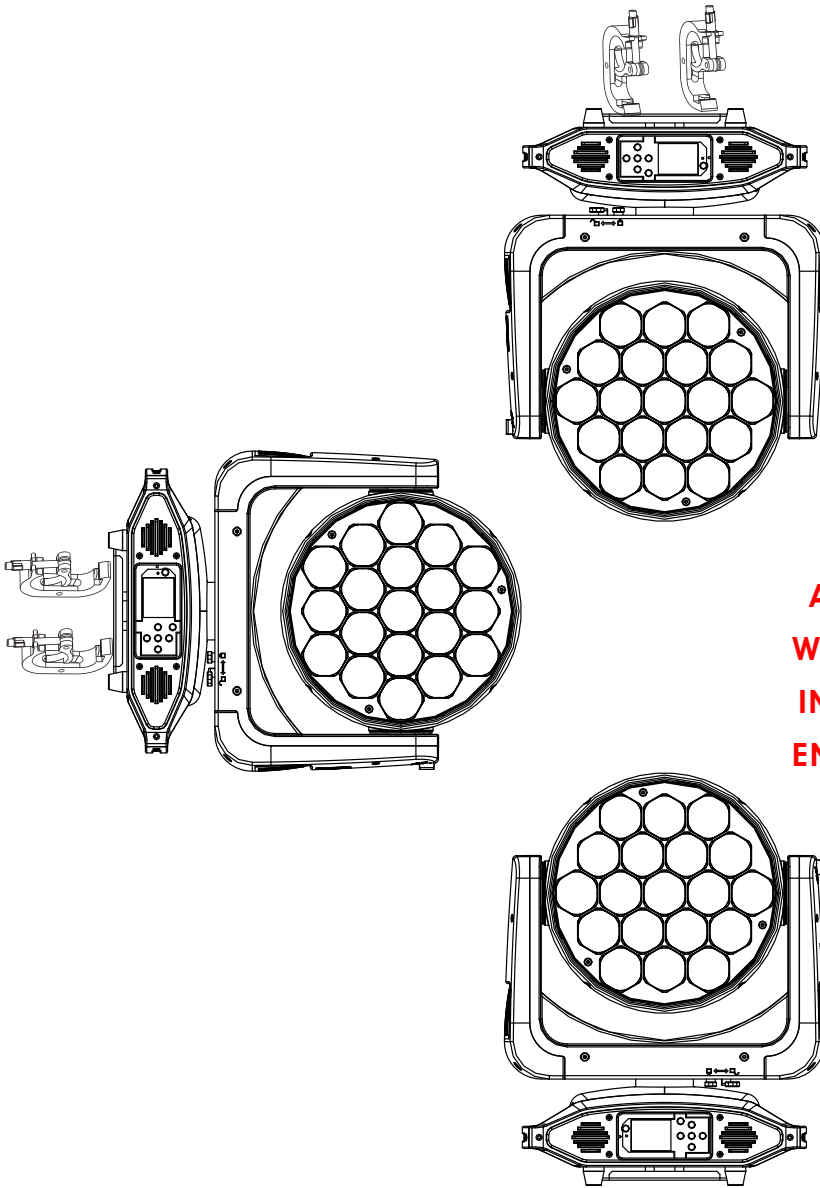

### **SAFETY CABLE**

**ALWAYS ATTACH A SAFETY CABLE  
WHENEVER INSTALLING THIS FIXTURE  
IN A SUSPENDED ENVIRONMENT TO  
ENSURE THE FIXTURE WILL NOT DROP  
IF THE CLAMP FAILS.**

## POWER LINKING

Max number of **PLATINUM SEVEN™** units power linked together:

**2 units @120V | 3 units @240V**

- ▶ **NOTE: USE CAUTION WHEN POWER LINKING OTHER FIXTURES TO PLATINUM SEVEN™ AS THE POWER CONSUMPTION OF OTHER LIGHTING FIXTURES WILL VARY!**

## ART-NET CONNECTION

When connecting fixture to a network switch to control multiple devices, a **Gigabit Ethernet Switch** that supports **IGMP (Internet Group Management Protocol)** is required. Using a **Gigabit Ethernet Switch** that does not support **IGMP** can cause erratic behavior of all connected devices to the switch.

Click link below for more information about IGMP.

[https://en.wikipedia.org/wiki/Internet\\_Group\\_Management\\_Protocol](https://en.wikipedia.org/wiki/Internet_Group_Management_Protocol)

## SYSTEM MENU

The fixture includes an easy to navigate system menu. The control panel (see image below) located on the front of the fixture, provides access to the main system menu and is where all necessary system adjustments are made to the fixture. During normal operation, pressing **MODE/ESC** button once will access the fixture's main menu. Once in the main menu you can navigate through the different functions and access the sub-menus with the **UP**, **DOWN**, **RIGHT**, and **LEFT** buttons. Once you reach a field that requires adjusting, press the **ENTER** button to activate that field and use the **UP** and **DOWN** buttons to adjust the field. Pressing the **ENTER** button once more will confirm your setting. You may exit the main menu at any time without making any adjustments by pressing the **MODE/ESC** button.

- ▶ **NOTE:** To access the LCD Menu Control Display via the internal battery, press and hold the **MODE/ESC** button for 3 seconds. The LCD Menu Control Display will shut **OFF** automatically about 1 minute from the last button press.

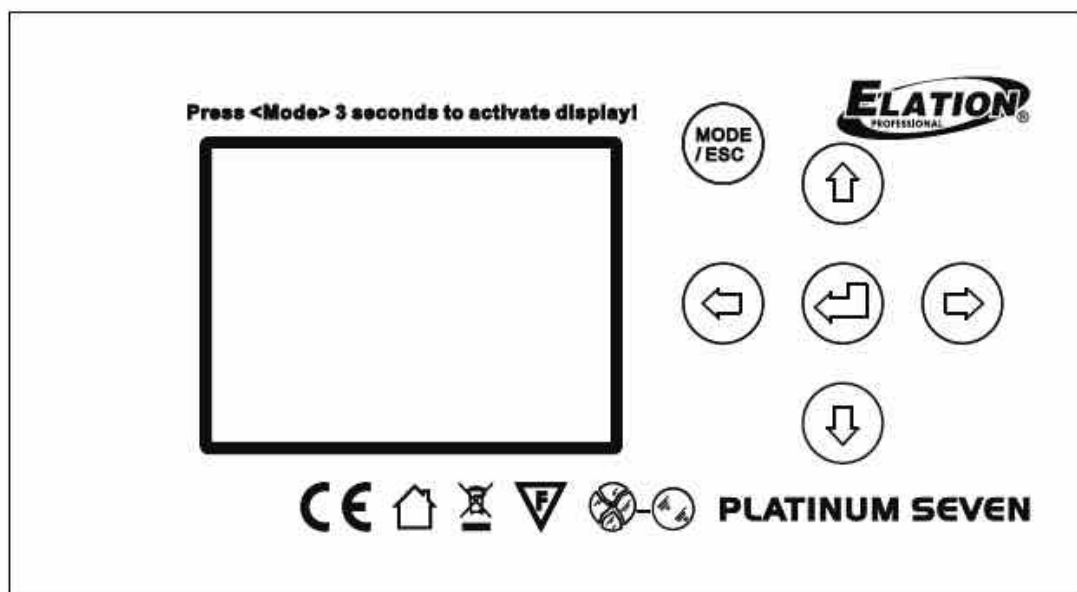

## ELATION® PLATINUM SEVEN™ SYSTEM MENU

Features are subject to change without any prior written notice.

Supports Software Versions: ≥ 1.1.3

| MAIN MENU   | SUB MENU                         | OPTIONS / VALUES (Default Settings in <b>BOLD</b> )                          |                                     |  |                                    |
|-------------|----------------------------------|--|-------------------------------------|--|------------------------------------|
| FUNCTION    | Set DMX Address                  | <b>001</b> ~xxx  |                                     | DMX Address Setting  |                                    |
|             | DMX Value                        | ALL.....   |                                     | DMX Value Display  |                                    |
|             | Slave Mode                       | Slave1, Slave2, Slave3   |                                     | Slave Setting  |                                    |
|             | Auto Program                     | <b>Master</b> / Alone  |                                     | Auto Program   |                                    |
| INFORMATION | Time Information                 | Current Time   | XXXX (Hours)                        | Fixture Run Time From Power ON                                       |                                    |
|             |                                  | Total Run Time   | XXXX (Hours)                        | Fixture Total Run Time   |                                    |
|             |                                  | Last Run Time  | XXXX (Hours)                        | Clear Fixture Last Run Time  |                                    |
|             |                                  | LastRun Password   | Password=XXX                        | Password <b>038</b>  |                                    |
|             |                                  | Clear Last Run   | ON / <b>OFF</b>                     | Reset Fixture Last Run Time  |                                    |
|             | Temperature Info                 | Head Temperature   | XXX C° / F°                         | Temperature in Fixture Head  |                                    |
|             | Ethernet IP                      | XXX . XXX . XXX . XXX<br>XXX . XXX . XXX . XXX                               | XXX . XXX . XXX . XXX               | IP Address   |                                    |
|             | Fan Speed                        | FAN1 :xxx RPM  |                                     | Displays Fan Speed RPM   |                                    |
|             | Software Version                 | 1U01: - 3U01: <b>Vx.x.x</b>   3U:02: <b>Vx.x.x</b>                           |                                     | Software Versions  |                                    |
| Error Info  | Error Record 1 ~ Error Record 10 |  | Displays Last 10 Error Codes        |  |                                    |
| PERSONALITY | Status Settings                  | Address via DMX  | <b>ON/OFF</b>                       | Address Via DMX  |                                    |
|             |                                  | No DMX Status  | Hold/Close Shutter/<br>Auto Program | Auto Run If No DMX   |                                    |
|             |                                  | Pan Reverse  | <b>ON/OFF</b>                       | Pan Reverse Movement   |                                    |
|             |                                  | Tilt Reverse   | <b>ON/OFF</b>                       | Tilt Reverse Movement  |                                    |
|             |                                  | Pan Degree   | 630/ <b>540</b>                     | Pan Degree Select  |                                    |
|             |                                  | Feedback   | <b>ON/OFF</b>                       | Movement Feedback  |                                    |
|             |                                  | Hibernation  | OFF, 01M~99M, <b>15M</b>            | Stand By Mode  |                                    |
|             | Service Setting                  | Password   | Password= <b>050</b>                |  | Service Password                   |
|             |                                  | RDM PID  | <b>XXXXX</b>                        |  | RDM PID Code                       |
|             |                                  | Ethernet IP  | XXX . XXX . XXX . XXX               |  | Ethernet IP                        |
|             |                                  | Ethernet Mask IP   | XXX . XXX . XXX . XXX               |  | Ethernet Mask IP                   |
|             |                                  | Clear Err. Info  | <b>ON/OFF</b>                       |  | Clear Error Code History           |
|             | Fans Control                     | <b>Auto</b> , Low, High  |                                     | Set Fan Speed  |                                    |
|             | Display Setting                  | Shutoff Time   | 02~60m <b>05m</b>                   |  | Display Shut Off Time              |
|             |                                  | Flip Display   | <b>ON/OFF</b>                       |  | Flip/Invert Display 180°           |
|             |                                  | Key Lock   | <b>ON/OFF</b>                       |  | Key Lock                           |
|             |                                  | Disp Flash   | <b>ON/OFF</b>                       |  | Display Flashes When No DMX Signal |
|             | Temperature C/F                  | <b>Celsius/Fahrenheit</b>  |                                     | Temperature Switch Between C° / F°                                   |                                    |
|             | Initial Status                   | PAN =XXX   |                                     | Initial Effect Position  |                                    |
|             | Dimmer Modes                     | <b>Standard</b> , Stage, TV, Architectural, Theatre                          |                                     |  |                                    |
|             | Select Signal                    | <b>DMX Only</b>  |                                     | DMX Only   |                                    |
|             |                                  | Art-Net on IP2   |                                     | Elect Art-Net IP02   |                                    |
|             |                                  | Art-Net on IP10  |                                     | Elect Art-Net IP010  |                                    |
|             | Set Universe                     | 000 - 255  |                                     | Set Art-Net Universe   |                                    |
|             | Silent Mode                      | <b>ON/OFF</b>  |                                     | Set Silent Mode  |                                    |
|             | Refresh                          | <b>1200</b> , 900-1500, 2500, 4000, 5000, 10000,<br>15000, 20000, 25000 (Hz) |                                     | Set Refresh Rate   |                                    |
|             | Gamma                            | <b>2.0</b> , 2.2, 2.4, 2.6, 2.8  |                                     | Set Gamma Value  |                                    |
|             | Reset Default                    | <b>ON/OFF</b>  | Password <b>011</b>                 | Restore Factory Settings<br><b>NOTE: Saved White Balance Erased!</b> |                                    |



| ELATION© PLATINUM SEVEN™ SYSTEM MENU                             |                 |   |                  |                                 |  |
|--|-----------------|---|------------------|---------------------------------|--|
| Features are subject to change without any prior written notice. |                 |   |                  |                                 |  |
| Supports Software Versions: ≥ 1.1.3                              |                 |   |                  |                                 |  |
| MAIN MENU  | SUB MENU        | OPTIONS / VALUES (Default Settings in <b>BOLD</b> ) |                  | DESCRIPTION                     |  |
| Reset Function   | Reset All       |   |                  | Reset All Motors                |  |
|  | Reset Pan&Tilt  |   |                  | Reset Pan/Tilt                  |  |
|  | Reset Zoom      |   |                  | Reset Zoom                      |  |
| Effect Adjust  | Test Channel    | PAN .....   |                  | Test function                   |  |
|  | Manual Control  | PAN =XXX, .....                                     |                  | Fine Adjustments                |  |
|  | Calibration     | Calibration Password                                |                  | Password <b>050</b>             |  |
| User Mode Set  | User Mode       | <b>Standard Mode</b>                                |                  | DMX Channel Modes               |  |
|  |                 | Basic Mode  |                  |                                 |  |
|  |                 | Extended Mode                                       |                  |                                 |  |
|  |                 | User Mode A   |                  | User Defined Channel Assignment |  |
|  |                 | User Mode B   |                  |                                 |  |
|  | User Mode C     |   |                  |                                 |  |
|  | Edit User Mode  | Edit User Mode A                                    | Max Channel = XX |                                 | Edits User Defined Channel Assignments |
| Edit User Mode B   |                 |   |                  |                                 |  |
| Edit User Mode C   |                 | PAN = CH01  |                  |                                 |  |
| Edit Program   | Select Program  | Auto Pro Part1 = Program 1~10 ( <b>Program 1</b> )  |                  | Select Programs To Be Run       |  |
|  |                 | Auto Pro Part2 = Program 1~10 ( <b>Program 2</b> )  |                  |                                 |  |
|  |                 | Auto Pro Part3 = Program 1~10 ( <b>Program 3</b> )  |                  |                                 |  |
|  | Edit Program    | Program 1   | Program Test     |                                 | Testing Program                        |
|  |                 | :   | Step 01=SCxxx    |                                 | Program In Loop                        |
|  |                 | Program 10  | Step 64=SCxxx    |                                 | Save and Exit                          |
|  | Edit Scenes     | Scene 001<br>~<br>Scene 250                         | Pan,Tilt,.....   |                                 | Save and Automatically Return          |
|  |                 |   |                  | --Fade Time--                   | Manual Scenes Edit                     |
|  |                 |   |                  | --Scene Time--                  |  |
|  | Rec. Controller | XX~XX   |                  | Input By Outside                | Stores Scenes via Ext DMX Console      |
|  |                 |   |                  | Automatic Scenes Recorder       |  |

### SYSTEM MENU CHANGE WITH SOFTWARE UPDATE VERSION 1.1.4

See highlighted menu items below, which have been updated/added with this software update.

|               |                 |                     |
|---------------|-----------------|---------------------|
| Select Signal | <b>DMX Only</b> | DMX Only            |
|               | Art-Net on IP2  | Elect Art-Net IP02  |
|               | Art-Net on IP10 | Elect Art-Net IP010 |
|               | sACN            | sACN Protocol       |

### SYSTEM MENU CHANGE WITH SOFTWARE UPDATE VERSION 1.1.5

See highlighted menu items below, which have been updated/added with this software update.

|               |        |  |   |
|---------------|--------|--|---|
| Reset Default | ON/OFF | Password <b>011</b><br>Password <b>088</b> | <b>011 - Restore Factory Settings ONLY</b><br><b>088 - Restore Factory Settings and White Balance</b> |
|---------------|--------|--|---|



## **PERSONALITY - Status Settings - Address Via DMX**

When ON, define the desired DMX address via an external controller.

1. Connect the fixture to the external controller and power ON.
2. Set the DMX value of **Channel 1** on the controller to **(7)**.
3. Set the DMX value of **Channel 2** on the controller to **(7)** or **(8)**.  
When set to **(7)**, the DMX address can be set between **(1)** and **(255)**.  
When set to **(8)**, the DMX address can be set between **(256)** and **(511)**.
4. Using **Channel 3** on the controller set the desired DMX address of the fixture.

**Example 1:** If the desired DMX address is **57**, set **Channel 1** to a value of **(7)**, set **Channel 2** to a value of **(7)**, and then set **Channel 3** to a value of **(57)**.

**Example 2:** If the desired DMX address is **420**, set **Channel 1** to a value of **(7)**, set **Channel 2** to a value of **(8)**, and then set **Channel 3** to a value of **(164)**. (256+164=420)

5. After setting **Channel 3** to the desired DMX address value, wait for approximately 20 seconds for the fixture to complete the address reset function.

## **PERSONALITY – Service Setting - Password (050)**

- **NOTE:** The Service Password MUST be entered in order to access the following menus:  
**RDM PID, Ethernet IP, Ethernet IP Mask, and Clear Err. Info.**

## **PERSONALITY – Service Setting - RDM PID**

Select various submenus via RDM. RDM stands for "Remote Device Management", which provides the ability to control the device remotely while connected to a DMX-bus. ANSI E1.20-2006 by ESTA specifies the RDM standard as an extension of the DMX512 protocol. Manual settings like adjusting the DMX starting address are no longer needed. This is especially useful when the device is installed in a remote area.

RDM ready and conventional DMX devices can be operated in one DMX line. The RDM protocol sends its own packages in the DMX512 data feed and does not influence conventional devices. If DMX splitters are used and RDM control is to be used, these splitters must support RDM. The number and type of RDM parameters depend on the RDM controller being used.

## **PERSONALITY - Display Setting – Key Lock**

When ON, Control Panel buttons lock automatically after exiting main menu for 15 seconds. To unlock, keep **MODE/ESC** button pressed for 3 seconds.

## PERSONALITY - Dimming Modes

Select desired DIMMER MODE (**Standard**, Stage, TV, Architectural, Theatre).

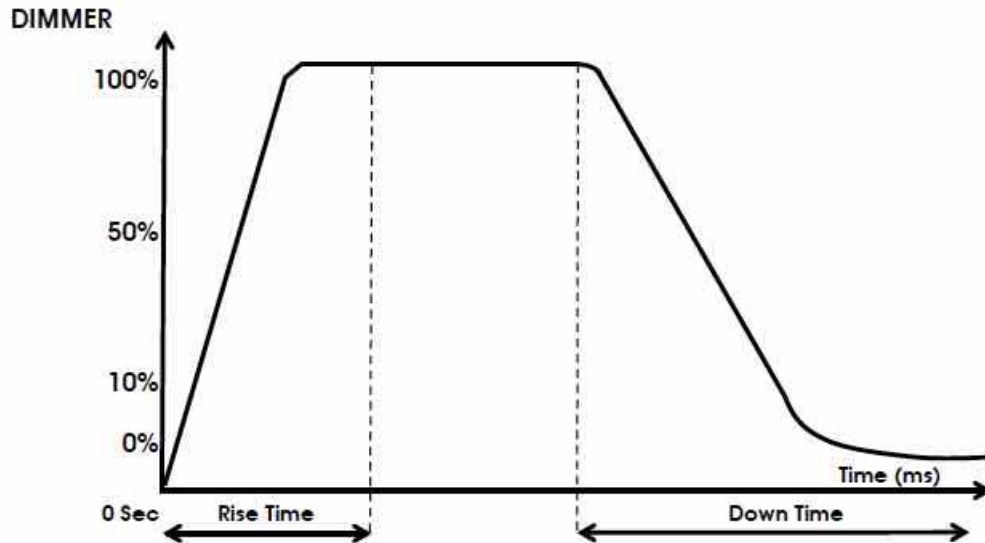

| Dimming Curve Ramp Effect | 0 sec Fade Time |                | 1 sec Fade Time |                |
|---------------------------|-----------------|----------------|-----------------|----------------|
|                           | Rise Time (ms)  | Down Time (ms) | Rise Time (ms)  | Down Time (ms) |
| Standard (default)        | 0               | 0              | 0               | 0              |
| Stage                     | 780             | 1100           | 1540            | 1660           |
| TV                        | 1180            | 1520           | 1860            | 1940           |
| Architectural             | 1380            | 1730           | 2040            | 2120           |
| Theatre                   | 1580            | 1940           | 2230            | 2280           |

## PERSONALITY - Silent Mode

When set to ON, the internal fan motor speed is adjusted to the lowest possible RPM. This provides low noise performance by effectively reducing fan noise by over 25% decibels (DB).

## PERSONALITY - Reset Default (011 | 088)



**ONLY QUALIFIED TECHNICIANS SHOULD PERFORM THIS FUNCTION.**

This function restores all fixture settings to the factory default settings. There are two passwords, which can be used to engage the reset function.

**Password 011** - Returns all fixture settings to factory default.

**Password 088** - Returns all fixture settings including saved **White Balance** to factory default.

### **EFFECT ADJUST – Test Channel**

Auto test each individual channel function independently from the DMX control board.

### **EFFECT ADJUST – Manual Control**

Select and manually test and fine adjust each individual channel function independently from DMX control board. This function will center PAN and TILT motors and set dimmer to 100%. PAN and TILT functions will still operate if the fixture needs to be positioned to a flat clear surface. With the individual functions, you can focus the light on a flat surface (wall) and perform fine adjustments.

### **EFFECT ADJUST – Calibration**



**ONLY QUALIFIED TECHNICIANS SHOULD PERFORM THIS FUNCTION.**

This function allows small adjustments to be made to the Pan, Tilt, and Zoom movements to compensate for wear or in the event a sensor has been knocked slightly out of place. Because improper use of this function can result in undesired operation this function has been password protected. The password is **050** and must be entered each time the calibration menu function is entered. Because calibration is an extremely delicate procedure, instructions on performing this action are left out of this manual. For a first time calibrator, please contact our customer support team for step-by-step instructions.

### **USER MODE SET – Edit User Mode**

Create user defined channel orders allowing the fixture to match the channel order of other fixtures on the market for easier operation. A total of three user modes may be configured: User Mode A, User Mode B, and User Mode C.

### **EDIT PROGRAM – Rec. Controller**

The fixture features an integrated DMX-recorder by which you can transmit the programmed scenes from your DMX-controller to the moving head. Adjust the desired scene numbers via the encoder (from – to). When you call up the scenes at your controller, they will automatically be transmitted to the moving head.

## EDIT PROGRAM – Record Controller – Working With Built In Programs

A Master unit can send up to 3 different data groups to the Slave units, i.e. a Master unit can start 3 different Slave units, which run 3 different programs. The Master unit sends the 3 program parts in a continuous loop.

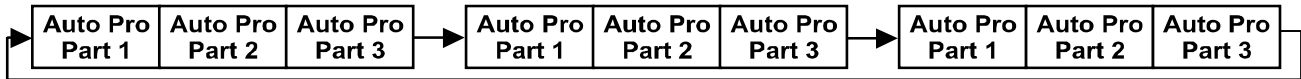

The Slave unit receives data from the Master unit according to the group which the Slave unit was assigned to. If e.g. a Slave unit is set to “**Slave 1**” in the menu “**Set to Slave**”, the Master unit sends “**Auto Program Part 1**” to the Slave unit.

If set to “**Slave 2**”, the Slave unit receives “**Auto Program Part 2**”.

To start an Auto Program proceed as follows:

### 1. Slave Setting

- Select “**Function Mode**”.
- Press **ENTER** to confirm.
- Select “**Set to Slave**”.
- Press **ENTER** to confirm.
- Select “**Slave 1**”, “**Slave 2**” or “**Slave 3**”.
- Press **ENTER** to confirm.
- Press **MODE/ESC** in order to return to the main menu.

### 2. Automatic Program Run

- Select “**Function Mode**”.
- Press **ENTER** to confirm.
- Select “**Auto Program**”.
- Press **ENTER** to confirm.
- Select “**Master**” or “**Alone**”.
- Press **ENTER** to confirm.
- Press **MODE/ESC** in order to return to the main menu.

## **EDIT PROGRAM – Record Controller – Working With Built-In Program [continued]**

### **3. Program Selection for Auto Pro Part**

- Select “**Edit Program**”.
- Press **ENTER** to confirm.
- Select “**Select Programs**”.
- Press **ENTER** to confirm.
- Select “**Auto Pro Part 1**”, “**Auto Pro Part 2**” or “**Auto Pro Part 3**”, and select which Slave program is to be sent. Selection “**Part 1**” means, that the Slave unit runs the same program as the master units.
- Press **ENTER** to confirm.
- Press **MODE/ESC** in order to return to the main menu.

### **4. Program Selection for Edit Program**

- Select “**Edit Program**”.
- Press **ENTER** to confirm.
- Select “**Edit Program**”.
- Press **ENTER** to confirm.
- Select the desired program to edit specific scenes into a specific program.
- Press **ENTER** to confirm.
- Press **MODE/ESC** in order to return to the main menu.

### **5. Automatic Scene Recording**

- Select “**Edit Program**”.
- Press **ENTER** to confirm.
- Select “**Edit Scenes**”.
- Select desired scene numbers. A maximum of 250 scenes can be programmed.
- Press **ENTER** to confirm.
- Press **MODE/ESC** in order to return to the main menu.

## EDIT PROGRAM – Record Controller – Working With Built-In Program [continued]

### Example:

Program 2 includes scenes: 10, 11, 12, & 13

Program 4 includes scenes: 8, 9, & 10

Program 6 includes scenes: 12, 13, 14, & 15

Auto Pro Part 1 is Program 2

Auto Pro Part 2 is Program 3

Auto Pro Part 3 is Program 6

The 3 Slave groups run the Auto Program in certain time segments. (See diagram below)

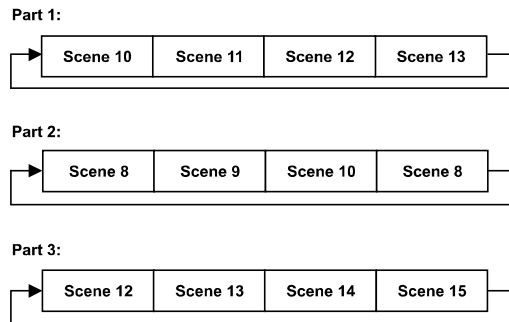

## WHITE BALANCE SETTING

This feature provides the ability to individually adjust the maximum dimmer intensity for each LED color (Red, Green, Blue, White, Amber, Cyan, U.V.) and store these values as a White Balance preset. This can be a useful tool when the output intensity of a group of same model fixtures with varying usage times, needs to be calibrated to match as much as possible. Once a new White Balance preset is saved to the fixture, the maximum dimmer intensity values cannot be changed until the White Balance preset is updated, erased or restored to the factory default setting.

1. Make sure all channels are set to zero (0), then set the **EDIT and SAVE WHITE BALANCE ENABLED** channel (CH24 in Basic Mode, CH31 in Stand Mode, CH40 in Extend Mode) to DMX value of (91-93).
2. Set the **EDIT a New WHITE BALANCE Setting** channel (CH22 in Basic Mode, CH29 in Stand Mode, CH38 in Extend Mode) to DMX value of (190-254).
3. Adjust each LED color channel to the desired intensity level (0-255).
4. Set the **SAVE a New WHITE BALANCE** channel (CH22 in Basic Mode, CH29 in Stand Mode, CH38 in Extend Mode) to DMX value of (255) to save the new preset.
5. To save a new White Balance preset, repeat steps 1-4 above.

# DMX CHANNEL FUNCTIONS AND VALUES

| ELATION® PLATINUM SEVEN™   |       |        |       |                               |
|--|-------|--------|-------|-------------------------------|
| DMX Channel Values / Functions Version 1 - (40 DMX Channels)   |       |        |       |                               |
| Supports Software Versions: ≥ 1.1.3  |       |        |       |                               |
| Features are subject to change without any prior written notice.<br>*Rotation direction (Clockwise or Counterclockwise) of effects depends on orientation of the fixture head and Pan/Tilt settings. |       |        |       |                               |
| MODE / CHANNEL   |       |        | VALUE | FUNCTION                      |
| BASIC  | STAND | EXTEND |       |                               |
| 1  | 1     | 1      |       | PAN MOVEMENT [8 BIT]          |
|  |       |        | 0-255 | PAN Movement                  |
| 2  | 2     | 2      |       | PAN FINE MOVEMENT [16 BIT]    |
|  |       |        | 0-255 | Fine Control of PAN Movement  |
| 3  | 3     | 3      |       | TILT MOVEMENT [8 BIT]         |
|  |       |        | 0-255 | TILT Movement                 |
| 4  | 4     | 4      |       | TILT MOVEMENT [16 BIT]        |
|  |       |        | 0-255 | Fine Control of TILT Movement |
| 5  | 5     |        |       | RED [ALL LEDs]                |
|  |       |        | 0-255 | Red (0-Black - 255-100%)      |
|  | 6     |        |       | RED FINE [ALL LEDs]           |
|  |       |        | 0-255 | Red FINE Adjustment           |
| 6  | 7     |        |       | GREEN [ALL LEDs]              |
|  |       |        | 0-255 | Green (0-Black - 255-100%)    |
|  | 8     |        |       | GREEN FINE [ALL LEDs]         |
|  |       |        | 0-255 | Green FINE Adjustment         |
| 7  | 9     |        |       | BLUE [ALL LEDs]               |
|  |       |        | 0-255 | Blue (0-Black - 255-100%)     |
|  | 10    |        |       | BLUE FINE [ALL LEDs]          |
|  |       |        | 0-255 | Blue FINE Adjustment          |
| 8  | 11    |        |       | WHITE [ALL LEDs]              |
|  |       |        | 0-255 | White (0-Black - 255-100%)    |
|  | 12    |        |       | WHITE FINE [ALL LEDs]         |
|  |       |        | 0-255 | White FINE Adjustment         |
| 9  | 13    |        |       | AMBER [ALL LEDs]              |
|  |       |        | 0-255 | Amber (0-Black - 255-100%)    |
|  | 14    |        |       | AMBER FINE [ALL LEDs]         |
|  |       |        | 0-255 | Amber FINE Adjustment         |
| 10   | 15    |        |       | CYAN [ALL LEDs]               |
|  |       |        | 0-255 | Cyan (0-Black - 255-100%)     |
|  | 16    |        |       | CYAN FINE [ALL LEDs]          |
|  |       |        | 0-255 | Cyan FINE Adjustment          |
| 11   | 17    |        |       | VIOLET [ALL LEDs]             |
|  |       |        | 0-255 | Violet (0-Black - 255-100%)   |
|  | 18    |        |       | VIOLET FINE [ALL LEDs]        |
|  |       |        | 0-255 | Violet FINE Adjustment        |

| ELATION® PLATINUM SEVEN™   |       |        |       |                             |
|--|-------|--------|-------|-----------------------------|
| DMX Channel Values / Functions Version 1 - (40 DMX Channels)   |       |        |       |                             |
| Supports Software Versions: ≥ 1.1.3  |       |        |       |                             |
| Features are subject to change without any prior written notice.   |       |        |       |                             |
| *Rotation direction (Clockwise or Counterclockwise) of effects depends on orientation of the fixture head and Pan/Tilt settings. |       |        |       |                             |
| MODE / CHANNEL   |       |        | VALUE | FUNCTION                    |
| BASIC  | STAND | EXTEND |       |                             |
|  |       | 5      |       | RED [LED GROUP 1]           |
|  |       |        | 0-255 | Red (0-Black - 255-100%)    |
|  |       | 6      |       | GREEN [LED GROUP 1]         |
|  |       |        | 0-255 | Green (0-Black - 255-100%)  |
|  |       | 7      |       | BLUE [LED GROUP 1]          |
|  |       |        | 0-255 | Blue (0-Black - 255-100%)   |
|  |       | 8      |       | WHITE [LED GROUP 1]         |
|  |       |        | 0-255 | White (0-Black - 255-100%)  |
|  |       | 9      |       | AMBER [LED GROUP 1]         |
|  |       |        | 0-255 | Amber (0-Black - 255-100%)  |
|  |       | 10     |       | CYAN [LED GROUP 1]          |
|  |       |        | 0-255 | Cyan (0-Black - 255-100%)   |
|  |       | 11     |       | VIOLET [LED GROUP 1]        |
|  |       |        | 0-255 | Violet (0-Black - 255-100%) |
|  |       | 12     |       | RED [LED GROUP 2]           |
|  |       |        | 0-255 | Red (0-Black - 255-100%)    |
|  |       | 13     |       | GREEN [LED GROUP 2]         |
|  |       |        | 0-255 | Green (0-Black - 255-100%)  |
|  |       | 14     |       | BLUE [LED GROUP 2]          |
|  |       |        | 0-255 | Blue (0-Black - 255-100%)   |
|  |       | 15     |       | WHITE [LED GROUP 2]         |
|  |       |        | 0-255 | White (0-Black - 255-100%)  |
|  |       | 16     |       | AMBER [LED GROUP 2]         |
|  |       |        | 0-255 | Amber (0-Black - 255-100%)  |
|  |       | 17     |       | CYAN [LED GROUP 2]          |
|  |       |        | 0-255 | Cyan (0-Black - 255-100%)   |
|  |       | 18     |       | VIOLET [LED GROUP 2]        |
|  |       |        | 0-255 | Violet (0-Black - 255-100%) |
|  |       | 19     |       | RED [LED GROUP 3]           |
|  |       |        | 0-255 | Red (0-Black - 255-100%)    |
|  |       | 20     |       | GREEN [LED GROUP 3]         |
|  |       |        | 0-255 | Green (0-Black - 255-100%)  |
|  |       | 21     |       | BLUE [LED GROUP 3]          |
|  |       |        | 0-255 | Blue (0-Black - 255-100%)   |
|  |       | 22     |       | WHITE [LED GROUP 3]         |
|  |       |        | 0-255 | White (0-Black - 255-100%)  |
|  |       | 23     |       | AMBER [LED GROUP 3]         |
|  |       |        | 0-255 | Amber (0-Black - 255-100%)  |
|  |       | 24     |       | CYAN [LED GROUP 3]          |
|  |       |        | 0-255 | Cyan (0-Black - 255-100%)   |
|  |       | 25     |       | VIOLET [LED GROUP 3]        |
|  |       |        | 0-255 | Violet (0-Black - 255-100%) |



| ELATION® PLATINUM SEVEN™  |        |        |         |                                      |
|---|--------|--------|---------|--------------------------------------|
| DMX Channel Values / Functions Version 1 - (40 DMX Channels)  |        |        |         |                                      |
| Supports Software Versions: ≥ 1.1.3   |        |        |         |                                      |
| Features are subject to change without any prior written notice.  |        |        |         |                                      |
| <i>*Rotation direction (Clockwise or Counterclockwise) of effects depends on orientation of the fixture head and Pan/Tilt settings.</i> |        |        |         |                                      |
| MODE / CHANNEL  |        |        | VALUE   | FUNCTION                             |
| BASIC   | STAND  | EXTEND |         |                                      |
| 12  | 19     | 26     |         | <b>COLOR MACROS</b>                  |
|   |        |        | 0-7     | NO FUNCTION                          |
|   |        |        | 8-39    | From RED to YELLOW                   |
|   |        |        | 40-71   | From YELLOW to GREEN                 |
|   |        |        | 72-103  | From GREEN to CYAN                   |
|   |        |        | 104-135 | From CYAN to BLUE                    |
|   |        |        | 136-167 | From BLUE to MAGENA                  |
|   |        |        | 168-199 | From MAGENTA to RED                  |
|   |        |        | 200-231 | From RED to WHITE                    |
|   |        |        | 232-255 | Crossfading Colors from SLOW to FAST |
| 13  | 20     | 27     |         | <b>COLOR PRESETS</b>                 |
|   |        |        | 0-4     | NO FUNCTION                          |
|   |        |        | 5-9     | WHITE 2700K                          |
|   |        |        | 10-14   | WHITE 3200K                          |
|   |        |        | 15-19   | WHITE 4300K                          |
|   |        |        | 20-24   | WHITE 5600K                          |
|   |        |        | 25-29   | WHITE 6500K                          |
|   |        |        | 30-34   | WHITE 8000K                          |
|   |        |        | 35-39   | RED                                  |
|   |        |        | 40-44   | GREEN                                |
|   |        |        | 45-49   | BLUE                                 |
|   |        |        | 50-54   | NATURAL WHITE                        |
|   |        |        | 55-59   | FULL WHITE                           |
|   |        |        | 60-64   | YELLOW                               |
|   |        |        | 65-69   | MAGENTA                              |
|   |        |        | 70-74   | CYAN                                 |
|   |        |        | 75-79   | SALMON                               |
|   |        |        | 80-84   | TURQUOISE                            |
|   |        |        | 85-89   | LIGHT GREEN                          |
|   |        |        | 90-94   | STEEL BLUE                           |
|   |        |        | 95-99   | ORANGE                               |
|   |        |        | 100-104 | STRAW                                |
|   |        |        | 105-109 | PALE LAVANDER                        |
|   |        |        | 110-114 | PINK                                 |
|   |        |        | 115-119 | RED/WHITE                            |
|   |        |        | 120-124 | GREEN/RED                            |
|   |        |        | 125-129 | BLUE/RED                             |
|   |        |        | 130-134 | WHITE/RED                            |
|   |        |        | 135-139 | WHITE/PINK                           |
|   |        |        | 140-144 | WHITE/TURQUOISE                      |
|   |        |        | 145-149 | SMALL RED/WHITE                      |
| 150-154   | CRI=85 |        |         |                                      |
| 155-159   | CRI=90 |        |         |                                      |
| 160-164   | CRI=95 |        |         |                                      |
|   |        |        | 165-255 | RESERVED                             |

| ELATION® PLATINUM SEVEN™  |          |         |                               |                                   |
|---|----------|---------|-------------------------------|-----------------------------------|
| DMX Channel Values / Functions Version 1 - (40 DMX Channels)  |          |         |                               |                                   |
| Supports Software Versions: ≥ 1.1.3   |          |         |                               |                                   |
| Features are subject to change without any prior written notice.  |          |         |                               |                                   |
| <i>*Rotation direction (Clockwise or Counterclockwise) of effects depends on orientation of the fixture head and Pan/Tilt settings.</i> |          |         |                               |                                   |
| MODE / CHANNEL  |          |         | VALUE                         | FUNCTION                          |
| BASIC   | STAND    | EXTEND  |                               |                                   |
| 14  | 21       | 28      |                               | <b>COLOR PRESETS DIMMER</b>       |
|   |          |         | 0-255                         | Dimmer 0 to 100%                  |
| 15  | 22       | 29      |                               | <b>SHUTTER, STROBE</b>            |
|   |          |         | 0-31                          | Shutter CLOSED                    |
|   |          |         | 32-63                         | Shutter OPEN (LEDs ON)            |
|   |          |         | 64-95                         | Strobe Effect SLOW to FAST        |
|   |          |         | 96-127                        | Shutter OPEN (LEDs ON)            |
|   |          |         | 128-159                       | Pulse Effect In Sequences         |
|   |          |         | 160-191                       | Shutter OPEN (LEDs ON)            |
|   |          |         | 192-223                       | Random Strobe Effect SLOW to FAST |
| 16  | 23       | 30      |                               | <b>DIMMER INTENSITY</b>           |
|   |          |         | 0-255                         | Dimmer 0 to 100%                  |
|   |          | 31      |                               | <b>DIMMER INTENSITY FINE</b>      |
|   |          |         | 0-255                         | Dimmer FINE Adjustment            |
| 17  | 24       | 32      |                               | <b>DIMMER MODES</b>               |
|   |          |         | 0-20                          | Standard                          |
|   |          |         | 21-40                         | Stage                             |
|   |          |         | 41-60                         | TV                                |
|   |          |         | 61-80                         | Architectural                     |
|   |          |         | 81-100                        | Theatre                           |
|   |          | 101-255 | Default to Setting on Fixture |                                   |
| 18  | 25       | 33      |                               | <b>MOTORIZED ZOOM</b>             |
|   |          |         | 0-255                         | ZOOM Adjustment from SMALL to BIG |
|   |          | 34      |                               | <b>MOTORIZED ZOOM FINE</b>        |
|   |          |         | 0-255                         | ZOOM FINE Adjustment              |
| 19  | 26       | 35      |                               | <b>CHASE PATTERNS</b>             |
|   |          |         | 0-14                          | NO FUNCTION (LEDs OFF)            |
|   |          |         | 15-30                         | Chase 1                           |
|   |          |         | 31-46                         | Chase 2                           |
|   |          |         | 47-62                         | Chase 3                           |
|   |          |         | 63-78                         | Chase 4                           |
|   |          |         | 79-94                         | Chase 5                           |
|   |          |         | 95-110                        | Chase 6                           |
|   |          |         | 111-126                       | Chase 7                           |
|   |          |         | 127-142                       | Chase 8                           |
|   |          |         | 143-158                       | Chase 9                           |
|   |          |         | 159-174                       | Chase 10                          |
|   |          |         | 175-190                       | Chase 11                          |
|   |          |         | 191-206                       | Chase 12                          |
|   |          |         | 207-222                       | Chase 13                          |
| 223-238   | Chase 14 |         |                               |                                   |
| 239-255   | Chase 15 |         |                               |                                   |

| ELATION® PLATINUM SEVEN™  |       |        |   |
|---|-------|--------|---|
| DMX Channel Values / Functions Version 1 - (40 DMX Channels)  |       |        |   |
| Supports Software Versions: ≥ 1.1.3   |       |        |   |
| Features are subject to change without any prior written notice.  |       |        |   |
| <i>*Rotation direction (Clockwise or Counterclockwise) of effects depends on orientation of the fixture head and Pan/Tilt settings.</i> |       |        |   |
| MODE / CHANNEL  |       |        | FUNCTION  |
| BASIC   | STAND | EXTEND |   |
| 20  | 27    | 36     | CHASE PATTERN SPEED   |
|   |       |        | 0-125 *Counterclockwise Chase Speed FAST to SLOW  |
|   |       |        | 126-130 STOP (Speed = 0)  |
| 21  | 28    | 37     | 131-255 *Clockwise Chase Speed SLOW to FAST   |
|   |       |        | CHASE FADE  |
|   |       |        | 0-255 Chase FADE  |
| 22  | 29    | 38     | COLOR MODE - WHITE BALANCE  |
|   |       |        | 0-189 NO FUNCTION   |
|   |       |        | 190-254 EDIT a New WHITE BALANCE Setting  |
|   |       |        | 255 SAVE New WHITE BALANCE Setting to Fixture(s)  |
| 23  | 30    | 39     | <b>*NOTE: DMX Value 91-93 must first be selected on CH24 (Basic), CH31 (Stand), or CH40 (Extend) to enable feature.</b> |
|   |       |        | PAN / TILT MOVEMENT SPEED   |
|   |       |        | 0-225 MAX to MIN Speed  |
|   |       |        | 226-235 Blackout by Movement  |
| 24  | 31    | 40     | 236-255 NO FUNCTION   |
|   |       |        | SPECIAL FUNCTIONS / INTERNAL PROGRAMS   |
|   |       |        | 0-79 Color Change Normal  |
|   |       |        | 80-84 ALL MOTOR RESET   |
|   |       |        | 85-87 SCAN MOTOR RESET  |
|   |       |        | 88-90 SILENT MODE ON  |
|   |       |        | 91-93 EDIT and SAVE WHITE BALANCE ENABLED   |
|   |       |        | 94-96 SILENT MODE OFF   |
|   |       |        | 97-99 OTHER MOTORS RESET  |
|   |       |        | 100-119 Internal Program 1 (Scene 1-8)  |
|   |       |        | 120-139 Internal Program 2 (Scene 9-16)   |
|   |       |        | 140-159 Internal Program 3 (Scene 17-24)  |
|   |       |        | 160-179 Internal Program 4 (Scene 25-32)  |
|   |       |        | 180-199 Internal Program 5 (Scene 33-40)  |
| 200-219 Internal Program 6 (Scene 41-48)  |       |        |   |
| 220-239 Internal Program 7 (Scene 49-56)  |       |        |   |

## LED GROUPS

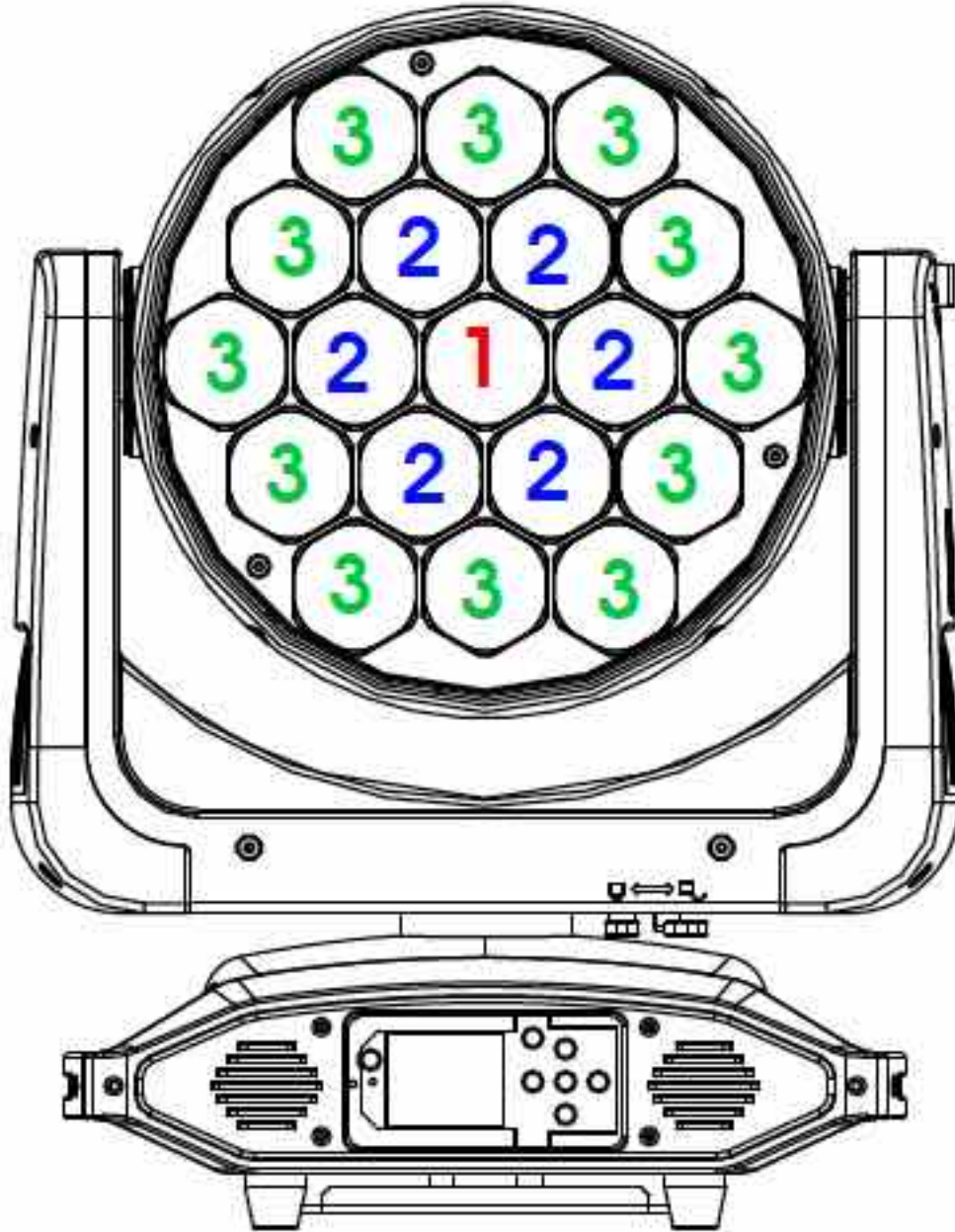

## ERROR CODES

When power is applied, the unit will automatically enter a **“Reset/Test”** mode. This mode brings all the internal motors to a home position. If there is an internal problem with one or more of the motors an error code will flash in the display in the form of **“XXer”** where as XX will represent a function number. For example, when the display shows **“0Er”** it means there is some type of error with the Pan motor. If there are multiple errors during the start-up process they will all flash in the display. For example: if the fixtures has errors on **Channel 1, 2, and 5** all at the same time, you will see the error message **“01Er”, “02Er”, and “05Er”** flash repeated 5 times.

If an error does occur during the initial start-up procedure the fixture will self-generate a second reset signal and try to realign all the motors and correct the errors. If the error persists after a second attempt a third attempt will be made. If after a third attempt all the errors have not been corrected the fixture will make the following determinations:

- **3 or More Errors** - The fixture cannot function properly with three or more errors therefore the fixture will place itself in a stand-by mode until subsequent repairs can be made.
- **Less Than 3 Errors** - The fixture has less than 3 errors; therefore most other functions will work properly. The fixture will attempt to operate normally until the errors can be correct by a technician. The errors in question will remain flashing in the display as a reminder of internal errors.

| ELATION© PLATINUM SEVEN™<br>ERROR CODES                             |  |
|---|--|
| Error Codes are subject to change without any prior written notice. |  |
| ERROR CODE  | DESCRIPTION  |
| <b>PAN</b>  | The PAN movement is not located in the default position after the reset. This message will appear after a fixture reset if the magnetic-indexing circuit malfunctions (sensor failed or magnet is missing) or there is a motor failure (defective motor or a defective motor IC drive on the main PCB). This error may also be displayed if the head/yoke was blocked during a reset function. |
| <b>TILT</b>   | The TILT movement is not located in the default position after the reset. This message will appear after a fixture reset if the magnetic-indexing circuit malfunctions (sensor failed or magnet is missing) or there is a motor failure (defective motor or defective motor IC drive on main PCB). This error may also be displayed if the head was blocked during a reset function.           |
| <b>ZOOM</b>   | The Zoom movement is not located in the default position after the reset. This message will appear after the reset of the fixture reset if the magnetic-indexing circuit malfunctions (sensor failed or magnet is missing) or there is a stepper motor failure (defective motor or defective motor IC drive on main PCB).  |
| <b>Fan Error</b>  | Head fan error, displayed as <b>"Fan RPM &lt; 1000"</b>  |

## CLEANING AND MAINTENANCE



**C A U T I O N**

**Disconnect power before cleaning or maintenance.**

### CLEANING

Frequent cleaning is recommended to insure proper function, optimized light output, and an extended life. The frequency of cleaning depends on the environment in which the fixture operates: damp, smoky or particularly dirty environments can cause greater accumulation of dirt on the fixture's optics.

- Clean the external lens surface at least every 20 days with a soft cloth to avoid dirt/debris accumulation.
- Never use alcohol, solvents, or ammonia based cleaners.

### MAINTENANCE

Regular inspections are recommended to insure proper function and extended life. There are no user serviceable parts inside this fixture, please refer all other service issues to an authorized Elation service technician. Should you need any spare parts, please order genuine parts from your local Elation dealer.

Please refer to the following points during routine inspections:

- A detailed electric check by an approved electrical engineer every three months, to make sure the circuit contacts are in good condition and prevent overheating.
- Be sure all screws and fasteners are securely tightened at all times. Loose screws may fall out during normal operation resulting in damage or injury as larger parts could fall.
- Check for any deformations on the housing, color lenses, rigging hardware and rigging points (ceiling, suspension, trussing). Deformations in the housing could allow for dust to enter into the fixture. Damaged rigging points or unsecured rigging could cause the fixture to fall and seriously injure a person(s).
- Electric power supply cables must not show any damage, material fatigue or sediments. Never remove the ground prong from the power cable.

## TECHNICAL SPECIFICATIONS

### SOURCE

(19) 25W Multi-Chip LEDs RGBW + Amber + Cyan + UV  
50,000 Hour Average Lamp Life\*

\*May vary depending on several factors including but not limited to:  
Environmental Conditions, Power/Voltage, Usage Patterns (On-Off Cycling), Control, and Dimming.

### EFFECTS

5° - 50° Beam Angle Zoom  
(3) Zone Ring Control  
Color-Pixel Ring and Color Preset Macros  
CRI Presets (85, 90, 95)  
Linear Color Temperature Presets (2,700 - 8,000K)  
Electronic Strobe (1-25 fps)  
Linear Dimming 0-100% + Selectable Dimming Curves

### COLOR

RGBW+ Amber + Cyan and UV (7 Colors)  
Even and Smooth Color Mixing

### CONTROL / CONNECTIONS

(3) DMX Channel Modes (24 / 31 / 40)  
Adjustable Refresh Rate (900-1500, 2500, 4000, 5000, 10000, 15000, 20000, 25000 (Hz)  
Adjustable Gamma Brightness (2.0, 2.2, 2.4, 2.8)  
Silent Mode  
RDM (Remote Device Management)  
6 Button Touch Control Panel  
Full Color 180° Reversible LCD Menu Display  
8 / 16 Bit Resolution Adjustable Movement  
5pin DMX In/Out  
RJ45 Ethernet In/Out (Art-NET, sACN)  
powerCON TRUE1 Power In/Out

### SIZE / WEIGHT

Length: 16.5" (418.1mm)  
Width: 11.2" (284.4mm)  
Vertical Height: 22.0" (558.9mm)  
Weight: 47.0 lbs. (21.3 kg)

### ELECTRICAL / THERMAL

AC 100-240V - 50/60Hz  
600W Max Power Consumption  
14°F to 113°F (-10°C to 45°C)

### APPROVALS / RATINGS

CE | IP20



Please Note: Specifications and improvements in the design of this unit and this manual are subject to change without any prior written notice.



## PHOTOMETRIC DATA

### MIN ZOOM - 5° Beam Diameter

|         | 1 m    | 3.3 ft | 2 m    | 6.6 ft | 3 m    | 9.8 ft | 4 m    | 13.1 ft | 5 m    | 16.4 ft |
|---------|--------|--------|--------|--------|--------|--------|--------|---------|--------|---------|
|         | 0.26   | 0.9    | 0.26   | 0.9    | 0.29   | 1.0    | 0.38   | 1.2     | 0.42   | 1.4     |
|         | lux    | fc     | lux    | fc     | lux    | fc     | lux    | fc      | lux    | fc      |
| RED     | 3,560  | 331    | 3,050  | 283    | 2,160  | 201    | 1,377  | 128     | 1,010  | 94      |
| GREEN   | 11,000 | 1,022  | 10,070 | 936    | 7,357  | 683    | 4,650  | 432     | 3,199  | 297     |
| BLUE    | 1,910  | 177    | 1,730  | 161    | 1,280  | 119    | 810    | 75      | 550    | 51      |
| WHITE   | 19,830 | 1,842  | 17,530 | 1,629  | 12,660 | 1,176  | 8,123  | 755     | 5,532  | 514     |
| AMBER   | 2,222  | 206    | 1,930  | 179    | 1,470  | 137    | 972    | 90      | 660    | 61      |
| CYAN    | 6,316  | 587    | 5,680  | 528    | 4,162  | 387    | 2,625  | 244     | 1,776  | 165     |
| U.V.    | 65     | 6      | 54     | 5      | 40     | 4      | 25     | 2       | 18     | 2       |
| FULL ON | 38,500 | 3,577  | 34,100 | 3,168  | 24,860 | 2,309  | 15,860 | 1,473   | 11,110 | 1,032   |

### MAX ZOOM - 50° Beam Diameter

|         | 1 m   | 3.3 ft | 2 m   | 6.6 ft | 3 m  | 9.8 ft | 4 m  | 13.1 ft | 5 m | 16.4 ft |
|---------|-------|--------|-------|--------|------|--------|------|---------|-----|---------|
|         | 1.49  | 4.9    | 2.76  | 9.1    | 4.43 | 14.5   | 5.52 | 18.1    | 6.9 | 22.6    |
|         | lux   | fc     | lux   | fc     | lux  | fc     | lux  | fc      | lux | fc      |
| RED     | 588   | 55     | 166   | 15     | 80   | 7      | 51   | 5       | 34  | 3       |
| GREEN   | 1,907 | 177    | 522   | 48     | 256  | 24     | 144  | 13      | 97  | 9       |
| BLUE    | 340   | 32     | 91    | 8      | 44   | 4      | 24   | 2       | 16  | 2       |
| WHITE   | 3,271 | 304    | 903   | 84     | 439  | 41     | 248  | 23      | 167 | 16      |
| AMBER   | 361   | 34     | 104   | 10     | 50   | 5      | 30   | 3       | 21  | 2       |
| CYAN    | 1,061 | 99     | 291   | 27     | 142  | 13     | 79   | 7       | 53  | 5       |
| U.V.    | 12    | 1      | 3     | 0      | 2    | 0      | 1    | 0       | 1   | 0       |
| FULL ON | 6,670 | 620    | 1,844 | 171    | 896  | 83     | 500  | 46      | 341 | 32      |

### DIMENSIONAL DRAWINGS

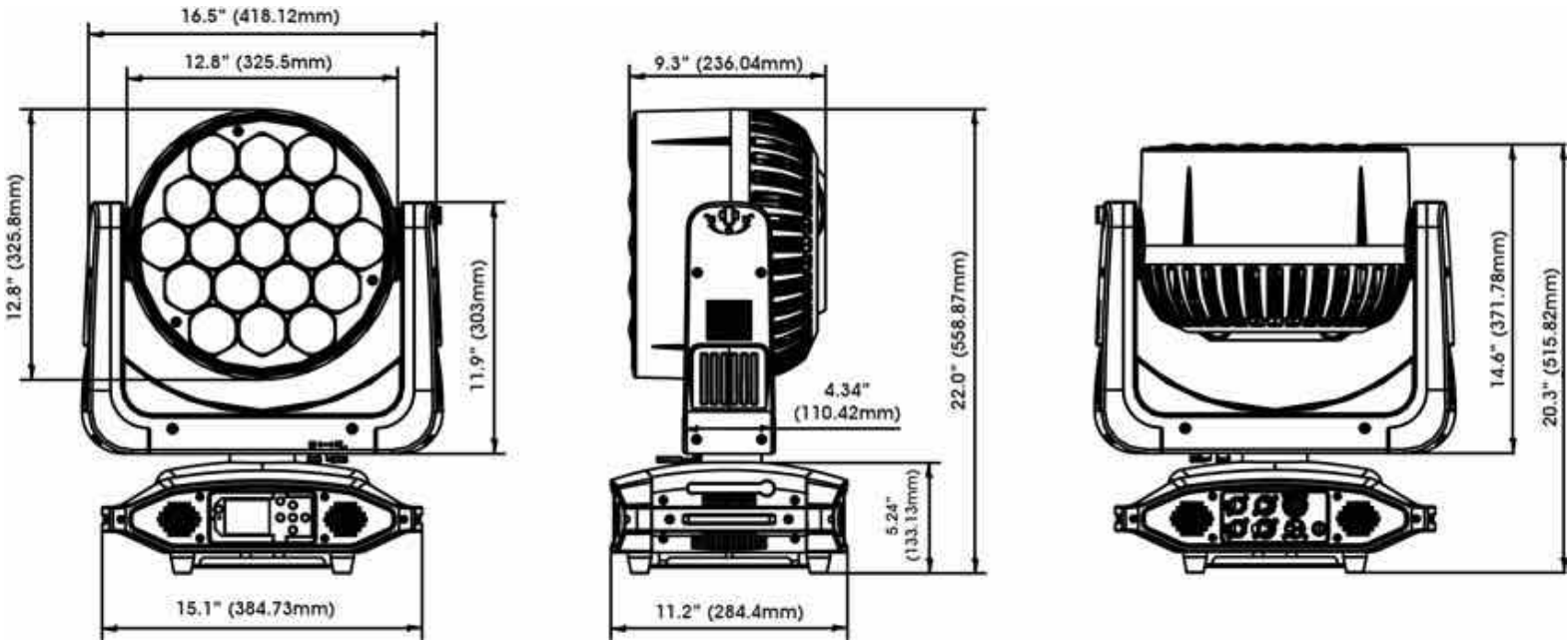

Please Note: Specifications and improvements in the design of this unit and this manual are subject to change without any prior written notice.

## OPTIONAL ACCESSORIES

| ORDER CODE    | ITEM  |
|---------------|---|
| TRIGGER CLAMP | Heavy Duty Wrap Around Hook Style Clamp         |
| DRCPLAT7      | Dual Road Case For PLATINUM SEVEN™              |
| EWDMXSYSTEM   | Wireless DMX System (1 Transmitter, 1 Receiver) |
| AC5PDMX5PRO   | 5 ft. (1.5m) 5pin PRO DMX Cable                 |
| CAT6PRO5      | 5 ft. (1.5m) CAT6 EtherCON Cable                |
| NEU088        | 3 ft. (1m) powerCON TRUE1 Power Link Cable      |
|               | Additional Cable Lengths Available              |

