

ChannelPlus Data Modules

The H628 terminates data lines with CAT-5 jacks (RJ-45). Use CAT-5 jumper cables to route services to wall plates in the appropriate rooms of the house.

Wiring H628/H629
CAT-5 data hub
(H628 shown)

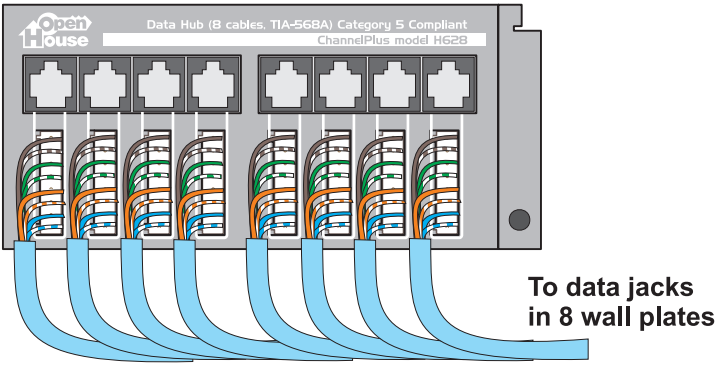

Sample system

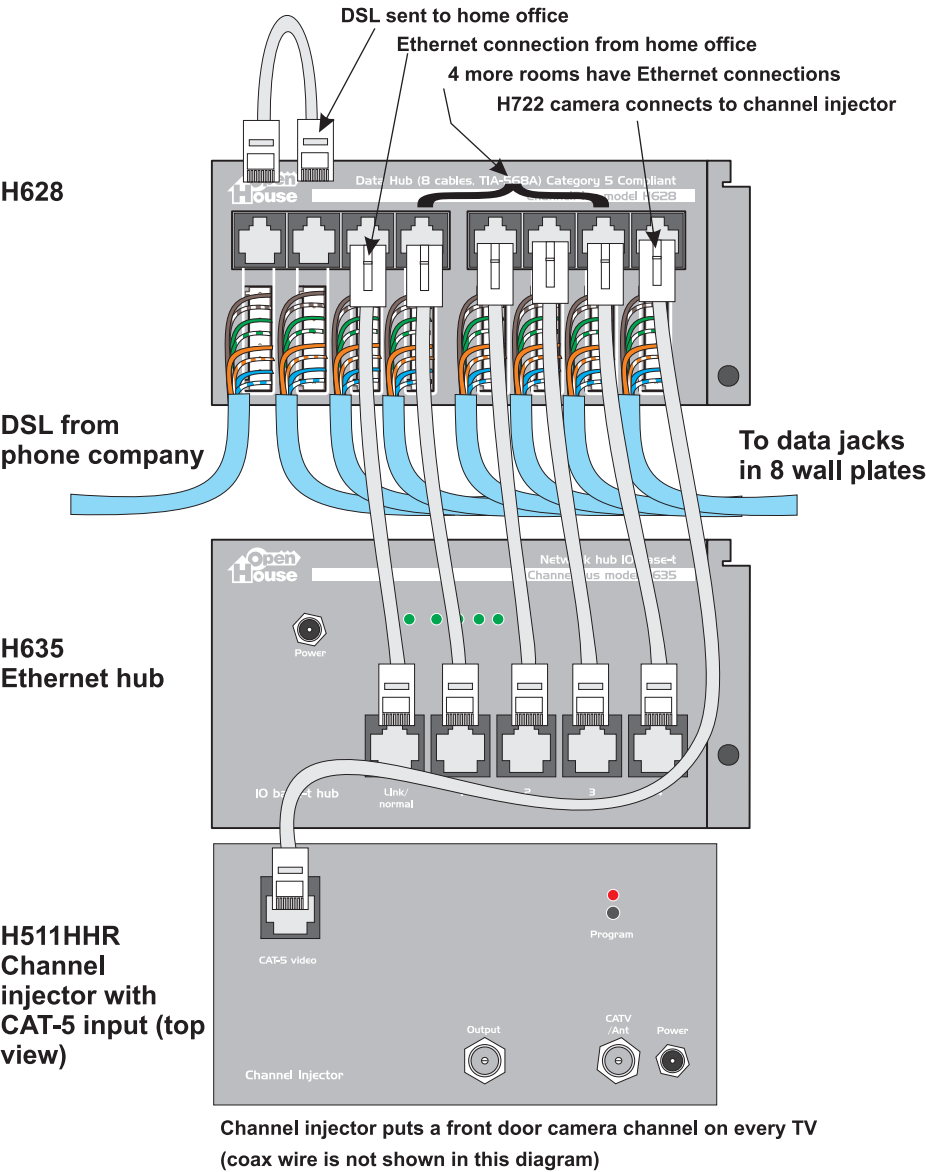

Using the H629 for telephone distribution

In a structured wire system, telephone outlets are wired using CAT-5 cables with a single RJ-45 jack at each end of the wire. To bring telephone to the jacks, bridge the telephone lines at the hub.

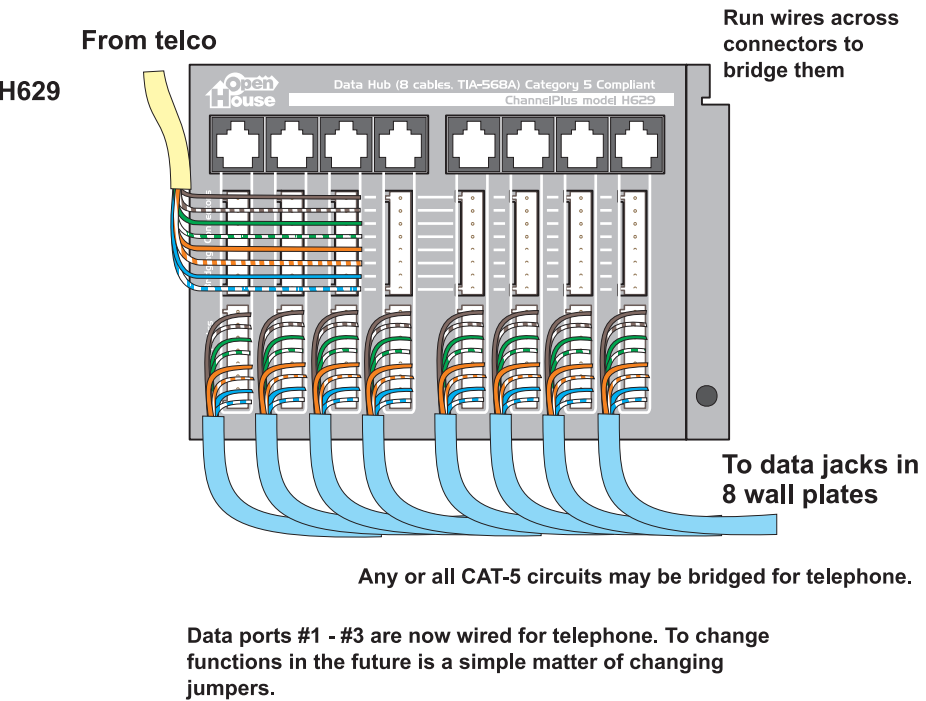

SAFETY INFORMATION:

- a) Never install telephone wiring during a lighting storm.
- b) Never install telephone jacks in wet locations.
- c) Never touch uninsulated telephone wires or terminals unless the telephone line has been disconnected at the network interface.
- d) Use caution when installing or modifying telephone lines.

OpenHouse™ modules attach from the top

- 1) Hook from the top
- 2) Swing into place
- 3) Push button to lock

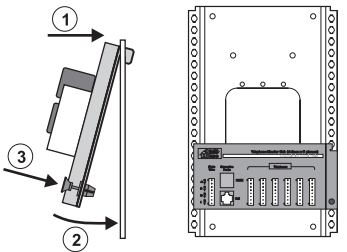

Wire Color Codes

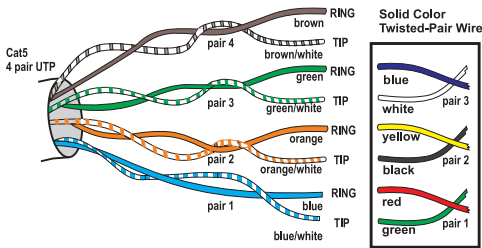

Modular connectors

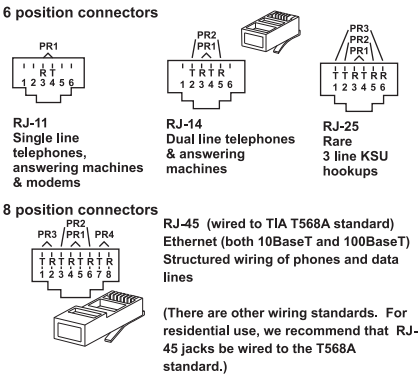

Wiring a 110 connector

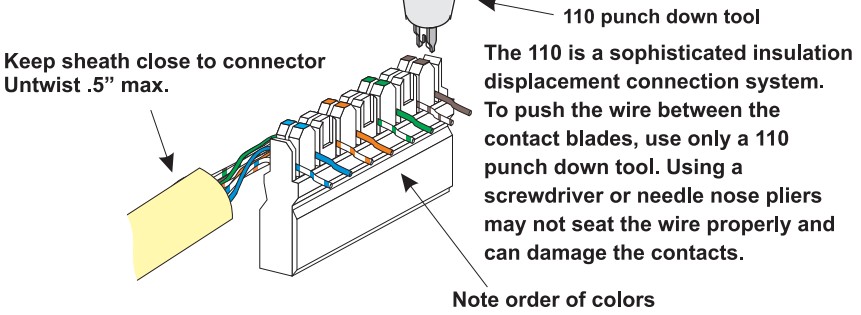

Wiring a Cat-5 jack

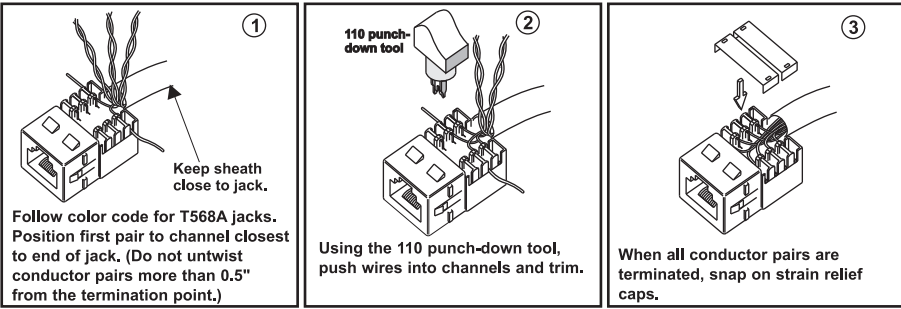

H628 CAT-5e performance

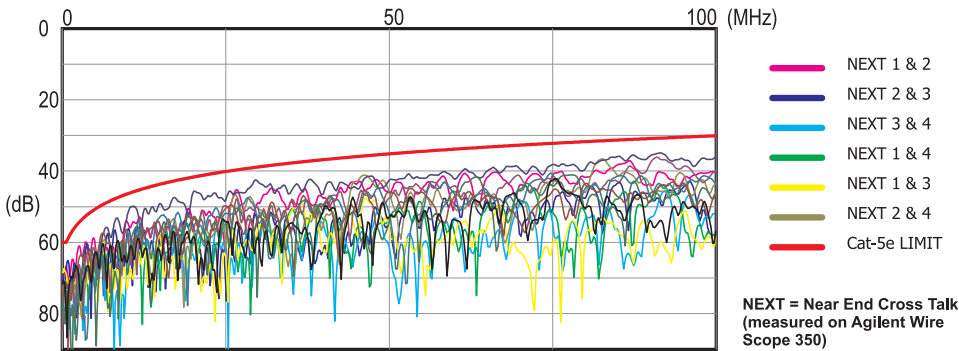

Wiring Modular Plug (T568A)

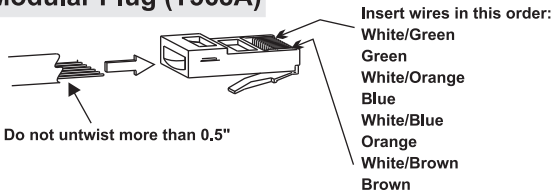

Colors of OpenHouse™ wiring

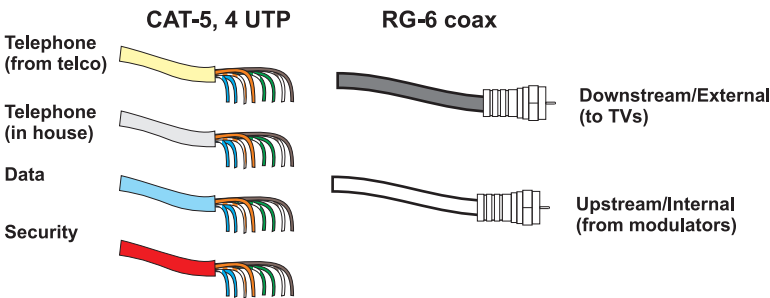

Good	1 Cat-5 1 RG-6	1 Cat-5 3 RG-6	1 Cat-5 2 RG-6
	2 Cat-5 2 RG-6	2 Cat-5 3 RG-6	2 Cat-5 1 RG-6
	3 Cat-5 3 RG-6	3 Cat-5 3 RG-6	2 Cat-5 2 RG-6
Better	1 Cat-5 2 RG-6	1 Cat-5 3 RG-6	2 Cat-5 1 RG-6
	2 Cat-5 2 RG-6	2 Cat-5 3 RG-6	2 Cat-5 2 RG-6
	3 Cat-5 3 RG-6	3 Cat-5 3 RG-6	2 Cat-5 2 RG-6
Best	1 Cat-5 3 RG-6	1 Cat-5 3 RG-6	2 Cat-5 2 RG-6
	2 Cat-5 3 RG-6	3 Cat-5 3 RG-6	2 Cat-5 2 RG-6
	3 Cat-5 3 RG-6	3 Cat-5 3 RG-6	2 Cat-5 2 RG-6

ChannelPlus
Data Module
Model H628/H629



All products returned for warranty service require a Return Product Authorization Number (RPA#). Contact Linear Technical Services at 1-800-421-1587 for an RPA# and other important details.

