

# Microflex<sup>®</sup>

Gooseneck Microphones and Accessories

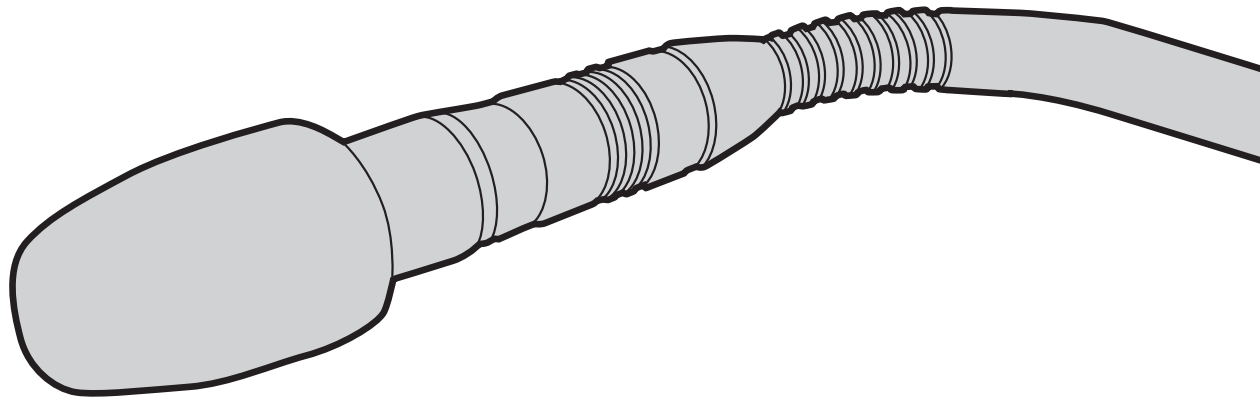

MX405  
MX410  
& MX415



MX400SMP



MX400DP

**SHURE<sup>®</sup>**

[www.shure.com](http://www.shure.com)  
© 2014 Shure Incorporated  
27A15587 (Rev. 2)

# Gooseneck Microphones and Accessories

## General Description

Shure MX405, MX410, and MX415 miniature gooseneck microphones are suitable for boardrooms and other sites where aesthetics are important. Permanently mount them at conference tables or lecterns using the MX400SMP surface mount, or use the MX400DP moveable desktop base, which includes a configurable mute button with logic output. Also compatible with the MX890 wireless desktop base.

## Features

- Low profile, aesthetic design
- Choice of bi-color indicator or light ring
- Wide dynamic range and smooth frequency response
- RF filtering with CommShield® technology
- Logic input for external LED control

## Model Variations

These gooseneck microphones are available in different lengths with a cardioid or supercardioid cartridge and either a bi-color LED status indicator or a light ring.

## Status Indicators

### MX405, MX410, MX415

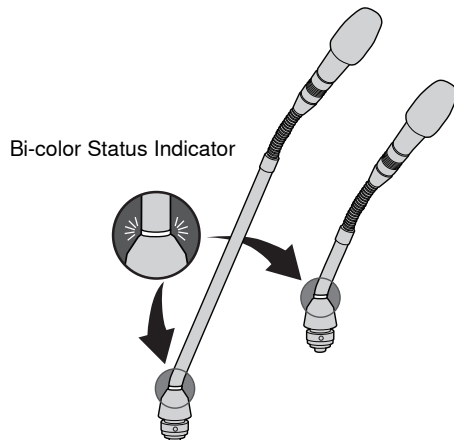

### MX405R, MX410R, MX415R

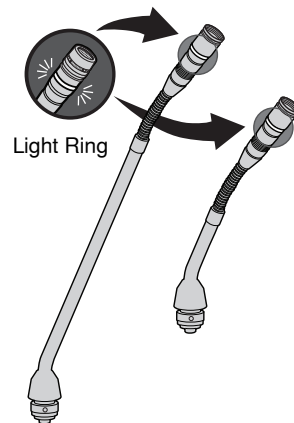

## Coverage and Placement

- **Cardioid:** One microphone for one or two people.
- **Supercardioid:** One microphone for each person.

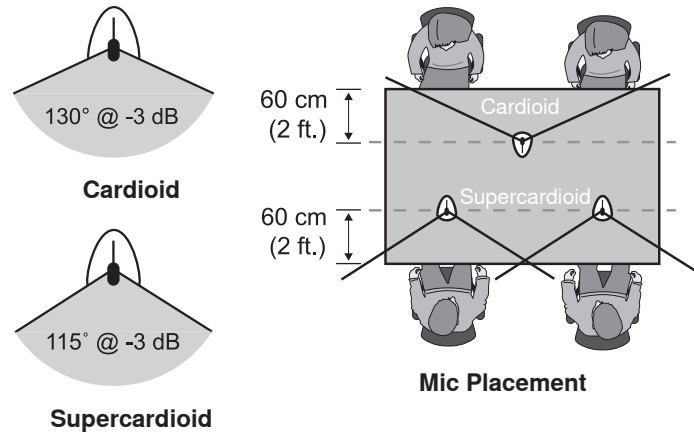

## Snap-Fit Windscreen

- Snap into the groove below the cartridge.
- To remove, spread the gap with a screwdriver or thumbnail.
- Provides 30 dB of "pop" protection.

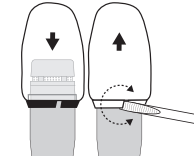

## Interchangeable Cartridges

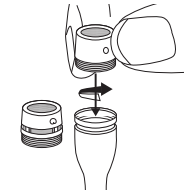

Microflex microphones use interchangeable cartridges that allow you to choose the polar pattern for different installations.

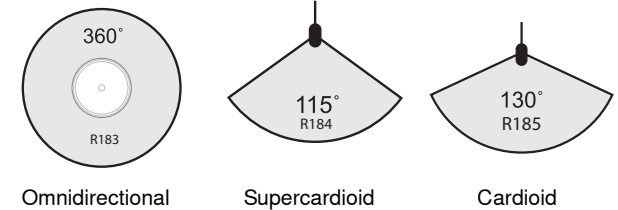

## Cartridge Polar Patterns

## MX400SMP Surface Mount Preamp

Permanent mount for conference tables or lecterns. Includes LED logic input.

### Furnished Accessories

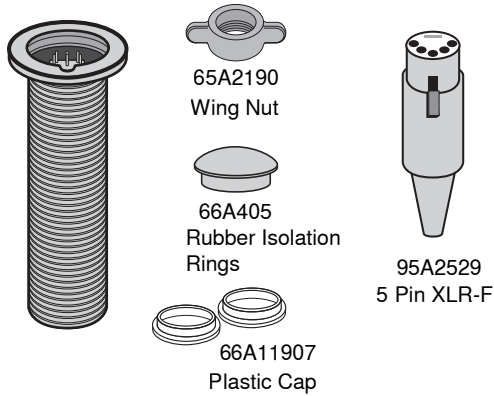

### MX400SMP Surface Mount Kit

### Installation

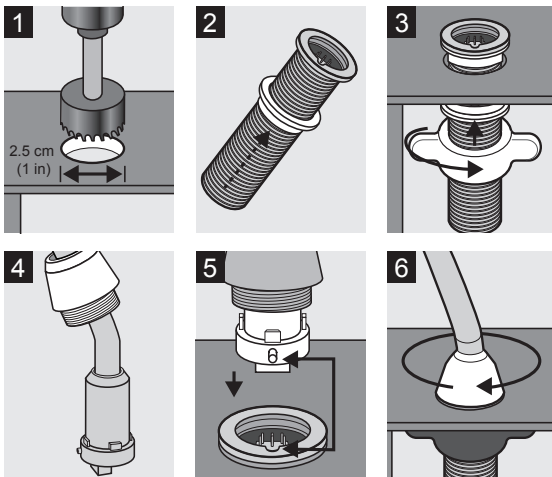

**Note:** Over tightening the wing nut reduces shock isolation.

**Caution:** To prevent bending pins, line up key with notch and seat connector fully before twisting to lock.

### MX400SMP Pin Assignments

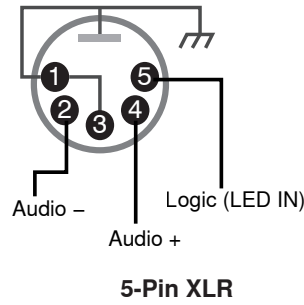

### DIP Switches

Set DIP Switch 1 up to engage the low cut filter, which attenuates frequencies by 6 dB per octave below 150 Hz.

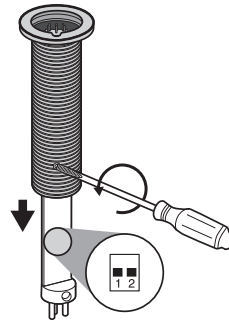

Switch	Down (default)	Up
1	Full frequency response	Low cut filter
2	LED steady	LED flashes

### LED Logic

To operate the LED indicator, use the included 5-pin XLR connector to wire the microphone to an automatic mixer or other logic device.

**Note:** Connect the LED IN to the gate output to illuminate the LED when the channel is gated on.

Do not use the relay ports on Crestron and AMX devices. Use the I/O logic ports instead.

The LED logic may not function when connecting to devices that do not have internal "pull-up resistor" logic circuits, such as ClearOne DSP products. External pull-up resistor circuits can be added for each microphone. Visit [www.shure.com/FAQ](http://www.shure.com/FAQ) for detailed instructions.

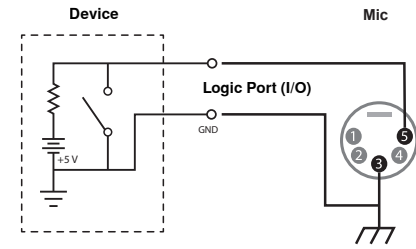

### Logic Connection

Connection to device with internal "pull-up resistor" logic circuit

MX405, 410, 415	
Logic LOW (0 V)  Green	Logic HIGH (+5 V)  Red
MX405R, 410R, 415R	
Logic LOW (0 V)  Red	Logic HIGH (+5V)  Off/flashing

## MX400DP Desktop Base

The MX400DP moveable desktop base includes a configurable mute button with logic output.

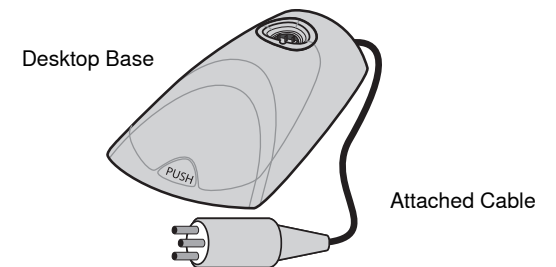

### MX400DP Desktop Base

## Installation

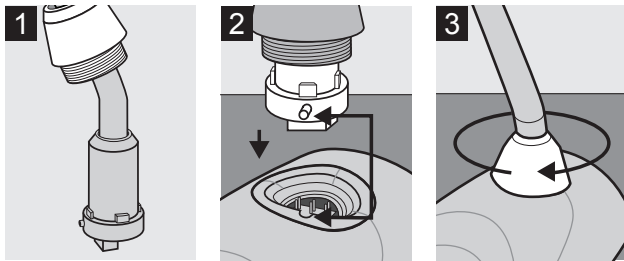

**Caution:** To prevent bending pins, line up key with notch and seat connector fully before twisting to lock.

## Cable

The 20 ft. attached cable is terminated with a 3-pin XLR connector. For logic applications, open the XLR connector to access the three unterminated logic conductors.

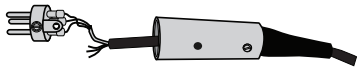

Wire Color	Function
Red	Audio +
Black	Audio -
White	SWITCH OUT
Orange	LED IN
Green	Logic Ground
Shield	Mic Common Ground

## MX400DB Pin Assignments

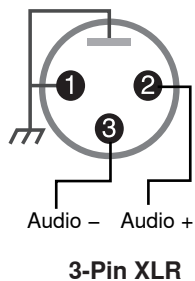

## MX400DP DIP Switches

**Caution:** Failure to reinstall the setscrew will reduce RF immunity.

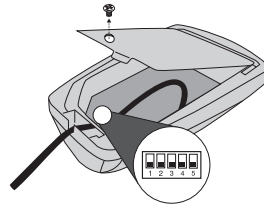

Switch	Down (default)	Up
1	Momentary	Toggle
2	Push-to-Mute	Push-to-Talk
3	Local Mute	Logic Control
4	Full Frequency Range	Low Cut Filter (attenuates 6dB per octave below 150 Hz)
5	LED Steady	LED Flashes

## Local Mute Control

The microphone ships configured for local (manual) mute control (**DIP Switch 3 down**). In this mode, the PUSH button on the microphone mutes the audio signal at the microphone. Audio is not sent to the audio outputs when muted.

In this configuration, the LED color reflects the microphone state, as controlled by the user with the PUSH button.

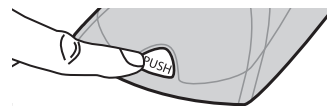

Microphone Status	MX405, 410, 415	MX405R, 410R, 415R
Active		
Muted	Green	Red
	Red	Off/flashing

## Button Configuration

For local mute control operation, use DIP Switches 1 and 2 to configure the button behavior.

Button Behavior	SWITCH OUT Logic Signal	DIP Switch Setting
<b>Momentary:</b> push-to-mute (as shipped).	When pushed, SWITCH OUT (red wire) falls to 0 V. When released, SWITCH OUT returns to +5 V.	
<b>Momentary:</b> push-to-talk		
<b>Toggle:</b> Push and release to toggle the microphone on or off. Mic is <b>active</b> when powered on.	Push and release sets SWITCH OUT to 0 V. Push again to toggle back to +5 V.	
<b>Toggle:</b> Push and release to toggle the microphone on or off. Mic is <b>mute</b> when powered on		

## Logic Mute Control (Automatic Mixing)

Set **DIP Switch 3 up** to configure the microphone for logic control applications where audio from the microphone is muted by an external device, such as an automatic mixer. In this mode, the local mute function of the PUSH button is bypassed (the microphone always sends audio) and the LED does not respond directly from pushing the button.

As required by the installation specifications, wire the SWITCH OUT conductor in the microphone cable to the automatic mixer or other TTL logic device. When the talker presses the button on the microphone, it changes the voltage level at the SWITCH OUT conductor, which signals the device to mute audio for that channel or perform some other function.

To control the LED on the microphone, wire the LED IN conductor to the gate output on the automatic mixer (or any TTL logic device).

## Button Configuration

For logic control operation, DIP Switch 1 determines the button behavior (DIP Switch 2 has no effect).

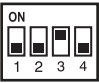
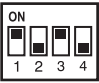
Button Behavior	DIP Switch Setting
<b>Momentary:</b> When pushed, SWITCH OUT (red wire) falls to 0 V. When released, SWITCH OUT returns to +5 V.	
<b>Toggle:</b> Push and release sets SWITCH OUT to 0 V. Push again to toggle back to +5 V.	

## Controlling the LED Using Logic LED IN

When configured for logic mute control, connect the LED IN conductors to an external switch, relay, or a TTL gate (gate out) on an automatic mixer. The MX400DB contains an internal pull-up resistor circuit.

- The LED illuminates **green/red** when the MX396 LED IN is **grounded** (orange wire connected to the green wire).
- The LED illuminates **red/off** when LED IN is **lifted** (orange wire is NOT connected to the green wire).

## Preamp Gain

If necessary, the preamplifier gain can be reduced by 12 dB. Contact an authorized Shure service center for information.

## Specifications

### Cartridge Type

Electret Condenser

### Frequency Response

50–17000 Hz

### Polar Pattern

MX405/C, MX410/C, MX415/C	Cardioid
MX405/S, MX410/S, MX415/S	Supercardioid

### Output Impedance

170 Ω

## Output Configuration

Active Balanced

### Sensitivity

@ 1 kHz, open circuit voltage

Cardioid	–35 dBV/Pa (18 mV)
Supercardioid	–34 dBV/Pa (21 mV)

1 Pa=94 dB SPL

### Maximum SPL

1 kHz at 1% THD, 1 kΩ load

Cardioid	121 dB
Supercardioid	120 dB

### Equivalent Output Noise

A-weighted

Cardioid	28 dB SPL
Supercardioid	27 dB SPL

### Signal-to-Noise Ratio

Ref. 94 dB SPL at 1 kHz

Cardioid	66 dB
Supercardioid	68 dB

### Dynamic Range

1 kΩ load, @ 1 kHz

93 dB

### Common Mode Rejection

10 to 100,000 kHz

45 dB, minimum

### Preamplifier Output Clipping Level

at 1% THD

–8 dBV (0.4 V)

### Polarity

3-pin XLR	Positive sound pressure on diaphragm produces positive voltage on pin 2 relative to pin 3 of output XLR connector
5-pin XLR	Positive sound pressure on diaphragm produces positive voltage on pin 4 relative to pin 2 of output XLR connector

### Net Weight

MX405	0.054 kg (0.119 lbs)
MX410	0.068 kg (0.150 lbs)
MX415	0.07 kg (0.154 lbs)
MX400DP	0.516 kg (1.138 lbs)
MX400SMP	0.125 kg (0.275 lbs)

## Logic Connections

LED IN	Active low ( $\leq 1.0V$ ), TTL compatible. Absolute maximum voltage: $-0.7V$ to $50V$ .
LOGIC OUT	Active low ( $\leq 1.0V$ ), sinks up to 20mA, TTL compatible. Absolute maximum voltage: $-0.7V$ to $50V$ (up to $50V$ through $3k\Omega$ ).

## Mute Switch Attenuation

–50 dB minimum

### Cable

MX400DP

6.1 m (20 ft) attached cable with shielded audio pair terminated at a 3-pin male XLR and three unterminated conductors for logic control

## Environmental Conditions

Operating Temperature	–18–57°C (0–135°F)
Storage Temperature	–29–74°C (–20–165°F)
Relative Humidity	0–95%

## Power Requirements

Phantom Power

48–52 V DC, 8.0 mA

## Certifications

This product meets the Essential Requirements of all relevant European directives and is eligible for CE marking.

The CE Declaration of Conformity can be obtained from: [www.shure.com/europe/compliance](http://www.shure.com/europe/compliance)

Authorized European representative:

Shure Europe GmbH

Headquarters Europe, Middle East & Africa

Department: EMEA Approval

Jakob-Dieffenbacher-Str. 12

75031 Eppingen, Germany

Phone: 49-7262-92 49 0

Fax: 49-7262-92 49 11 4

Email: [EMEAsupport@shure.de](mailto:EMEAsupport@shure.de)

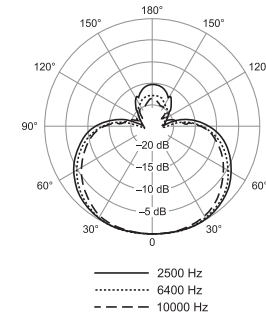
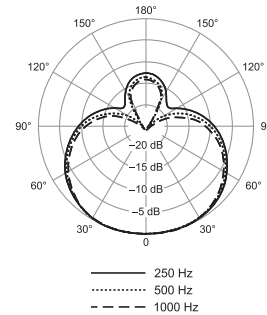
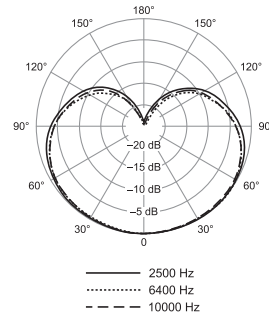
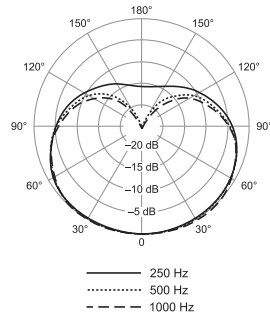
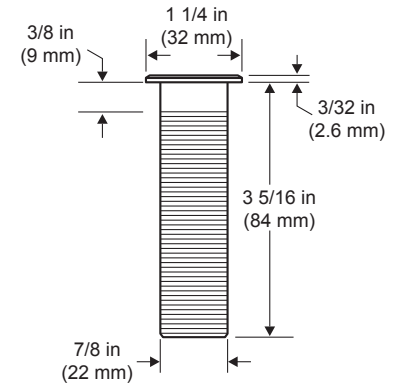
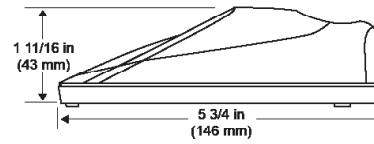
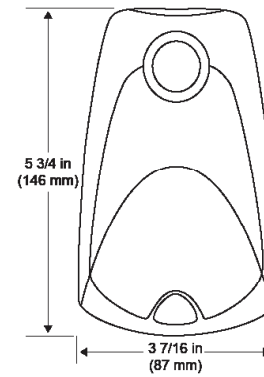
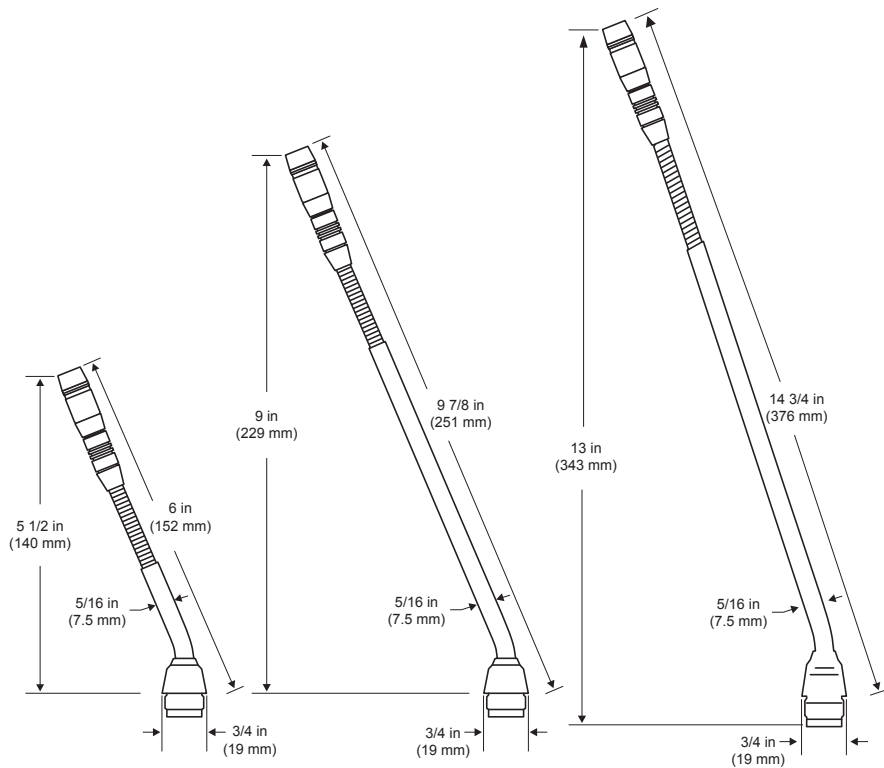

**SHURE®**

**United States, Canada, Latin America, Caribbean:**

Shure Incorporated  
5800 West Touhy Avenue  
Niles, IL 60714-4608 USA

Phone: +1-847-600-2000  
Fax: +1-847-600-1212 (USA)  
Fax: +1-847-600-6446  
Email: info@shure.com

www.shure.com

**Europe, Middle East, Africa:**

Shure Europe GmbH  
Jakob-Dieffenbacher-Str. 12,  
75031 Eppingen, Germany

Phone: +49-7262-92490  
Fax: +49-7262-9249114  
Email: info@shure.de

**Asia, Pacific:**

Shure Asia Limited  
22/F, 625 King's Road  
North Point, Island East  
Hong Kong

Phone: 852-2893-4290  
Fax: 852-2893-4055  
Email: info@shure.com.hk