

RVUICXX-B24 Modular Connectors - REVConnect Icon Pack

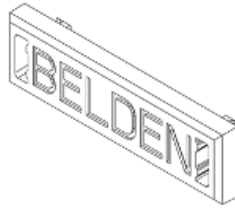

For more Information
please call

1-800-Belden1

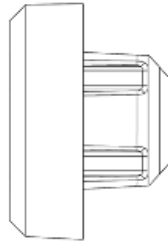

General Description:

REVConnect Color Icon, Bulk Pack

Usage (Overall)

Related Parts: Compatible with Belden's REVConnect jacks

Physical Characteristics (Connectivity)

Dimensions

Dimensions:

Height (in.)	Width (in.)	Depth (in.)
0.163	0.571	0.112

Materials

Materials:

Description	Type	Material	Color
Icon	N/A	Plastic - UL94V-0	See Product Table

Color

Color: Almond, Black, Blue, Blue (TIA 606), Brown, Brown (TIA 606), Elec. White, Gray, Green, Green (TIA 606), Ivory, Orange, Orange (TIA 606), Purple, Purple (TIA 606), Red, Red (TIA 606), Yellow, Yellow (TIA 606)

Weight

Weight: 0.001 lbs.

Packaging

Packaging: 24 icons bulk packaged in a cardboard box. Weight is per individual unit

Mechanical Characteristics (Connectivity)

Storage Temperature Range: -40°C To +70°C

Installation Temperature Range: -10°C To +60°C

Operating Temperature Range: -10°C To +60°C

Applicable Specifications and Agency Compliance (Overall)

Applicable Standards & Environmental Programs

EU Directive 2002/95/EC (RoHS): Yes

EU RoHS Compliance Date (mm/dd/yyyy): 07/01/2006

MIL Order #39 (China RoHS): EUP 50

Suitability

Suitability - Indoor: Yes - Indoor

Transmission Characteristics (Connectivity)

Notes (Overall)

Product Family

Part Number List:

Item Number	Color
RVUICGY-B24	Gray
RVUICAL-B24	Almond
RVUICEW-B24	Elec. White
RVUICBK-B24	Black
RVUICIV-B24	Ivory
RVUICBR-B24	Brown
RVUICRD-B24	Red

RVUICXX-B24 Modular Connectors - REVConnect Icon Pack

RVUICOR-B24	Orange
RVUICYL-B24	Yellow
RVUICGN-B24	Green
RVUICBL-B24	Blue
RVUICPR-B24	Purple
RVUICTN-B24	Brown (TIA)
RVUICTR-B24	Red (TIA)
RVUICTO-B24	Orange (TIA)
RVUICTY-B24	Yellow (TIA)
RVUICTG-B24	Green (TIA)
RVUICTB-B24	Blue (TIA)
RVUICTP-B24	Purple (TIA)

Put Ups and Colors:

Item #	Putup	Ship Weight	Color	Notes	Item Desc
--------	-------	-------------	-------	-------	-----------

Revision Number: 0 Revision Date: 09-12-2016

© 2016 Belden, Inc.
All Rights Reserved.

Although Belden makes every reasonable effort to ensure their accuracy at the time of this publication, information and specifications described herein are subject to error or omission and to change without notice, and the listing of such information and specifications does not ensure product availability. Belden provides the information and specifications herein on an "AS IS" basis, with no representations or warranties, whether express, statutory or implied. In no event will Belden be liable for any damages (including consequential, indirect, incidental, special, punitive, or exemplary damages) whatsoever, even if Belden has been advised of the possibility of such damages, whether in an action under contract, negligence or any other theory, arising out of or in connection with the use, or inability to use, the information or specifications described herein. All sales of Belden products are subject to Belden's standard terms and conditions of sale. Belden believes this product to be in compliance with EU RoHS (Directive 2002/95/EC, 27-Jan-2003). Material manufactured prior to the compliance date may be in stock at Belden facilities and in our Distributor's inventory. The information provided in this Product Disclosure, and the identification of materials listed as reportable or restricted within the Product Disclosure, is correct to the best of Belden's knowledge, information, and belief at the date of its publication. The information provided in this Product Disclosure is designed only as a general guide for the safe handling, storage, and any other operation of the product itself or the one that it becomes a part of. This Product Disclosure is not to be considered a warranty or quality specification. Regulatory information is for guidance purposes only. Product users are responsible for determining the applicability of legislation and regulations based on their individual usage of the product.