

## FOA Couplers & Adapters

Quick and easy fiber connector changeover between fiber networking devices

Mechanical & Environmental Specifications				
	Single Mode			Multimode
Polishing Type	PC	UPC	APC	—
Insertion Loss (dB)	≤ 0.3dB			≤ 0.3dB
Return Loss (dB)	≥40dB	≥ 50dB	≥ 60dB	—
Durability	0.2db Max Increase			
Operating Temperature	-40°C to +85°C			
Storage Temperature	-40°C to +85°C			

### Features

- Single Mode—Multimode Compatible
- Rugged Polymer/Metal Outer Body
- Durable Ceramic/Phosphor Bronze Sleeve
- Inner Assembly Fitted with Precision Alignment Mechanism
- Minimal Insertion Loss
- Mating Cycles: 500

FOA-LCF-SCM LC Female to SC Male



FOA-LCF-STM LC Female to ST Male

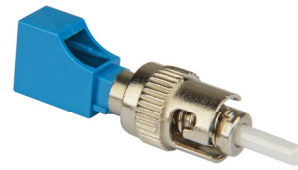

FOA-SCF-LCM SC Female to LC Male

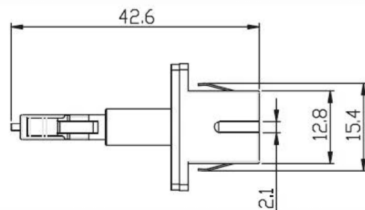

FOA-SCF-STM SC Female to ST Male

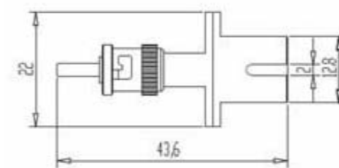
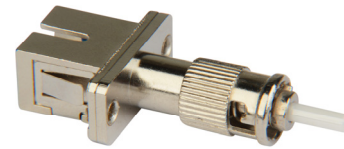

FOA-STF-LCM ST Female to LC Male

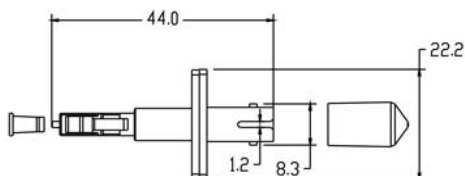

FOA-STF-SCM ST Female to SC Male

